



Western Michigan University
ScholarWorks at WMU

Legacy Scout Tickets from Pure Oil Company

8-20-2021

MGRRE_PureOilScoutTickets_Edmore State Bank_1_21035065010000

MGRRE
Western Michigan University

Follow this and additional works at: <https://scholarworks.wmich.edu/pure>



Part of the Geology Commons

WMU ScholarWorks Citation

MGRRE, "MGRRE_PureOilScoutTickets_Edmore State Bank_1_21035065010000" (2021). *Legacy Scout Tickets from Pure Oil Company*. 1194.
<https://scholarworks.wmich.edu/pure/1194>

This Document is brought to you for free and open access via ScholarWorks at WMU. It has been accepted for inclusion in Legacy Scout Tickets from Pure Oil Company by an authorized administrator of ScholarWorks at WMU. See the National Digital Catalogue - Science Base Catalogue for more collections submitted by MGRRE.



MGRRE_PureOilScoutTickets_Edmore State Bank_1_21035065010000

API 21035065010000

Permit Number 6501

Lease Name Edmore State Bank

Well Number 1

County Clare

Township 17N

Range 05W

Section 4

2021 DEQ or Pure co_name Oil States Corporation and McIntosh, J. W.

Pure Number 218

Latitude 43.89867

Longitude -84.92785

THE PURE OIL COMPANY

DATE July 27, 1939

LOCATION REPORT

No. 218

STATE Michigan COUNTY Clare DIST. Surrey TWP. Surrey SEC. 4 TOWN 17 N RANGE 5 W
WELL No. 1 (SERIAL No. 218) FARM Edmore State Bank ACRES 5

NAME OF STREAM OR WATERS _____ QUADRANGLE SW 1/4 NW 1/4

OPERATOR Oil Well Drilling Company Map Surrey Township, Clare County

660660 Oil Well Drilling Co. Surrey - Clare
Feet from North Line of Farm

“ “ East “ “ “

660660 “ “ South “ “ “

330330 “ “ West “ “ “

660660 Feet from North Line of Section

“ “ East “ “ “

“ “ South “ “ “

330330 “ “ West “ “ “

LEGEND

- LOCATION
- ① RIG
- ⊕ DRILLING
- ☼ GAS WELL
- OIL WELL
- ⬮ SMALL OIL WELL
- ⊙ DRY HOLE
- ⬮ DRY SHOWING OIL
- ⊙ DRY SHOWING GAS
- ⊙ ABANDONED LOCATION
- ☼ ABANDONED GAS WELL
- ⬮ ABANDONED OIL WELL

NOTE: Below make tracing from map, (when no map is obtainable make sketch) showing farm, center of section, this location with measurements and also wells, dry holes, or other locations in the vicinity of this location.

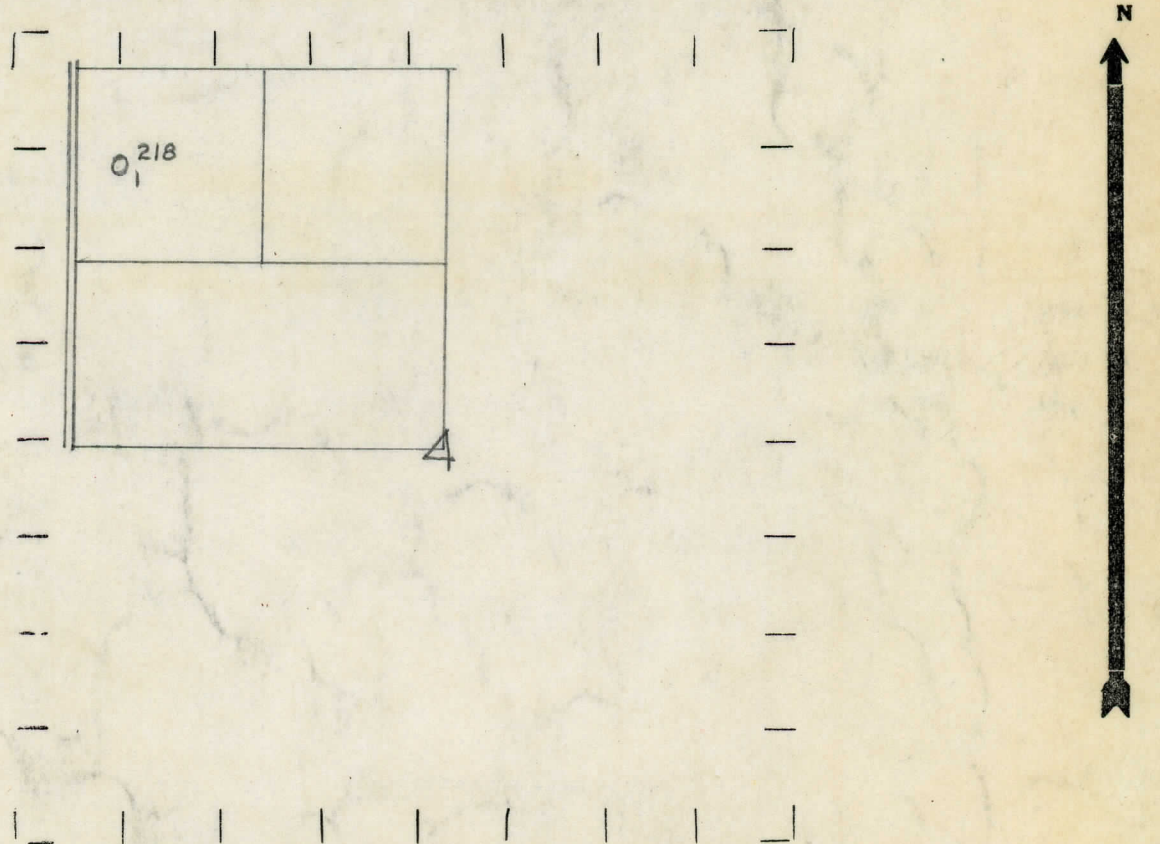

REMARKS:

SIGNED

R. J. G.

Superintendent or Foreman.

DATE MAY 21 1966

COMPLETION RECORD OF WELLS DRILLED BY OTHER OPERATORS

No. 518

Michigan Producing Division

Date December 20, 1939

No. 218

State Mich. County Clare Twp. Surrey Sec. 4 Twp. 17 N Rge. 5 W
(Serial No.)

Well No. 1 218 Farm Edmore State Bank Acres

Operator Oil Well Drilling Company Information secured ~~from~~ ^{By} Scouting Department

Date well started **7-26-39** Dated well completed **12-14-39** Elevation **1117.4**

PRODUCTION RECORD

1st 24 hours natural **Dry Hole**

2nd 24 hours natural

[illegible][illegible]

shot
1st 24 hours after acid

shot

2nd 24 hours after acid

FORMATION AND CASING RECORD

[illegible]

Remarks 1365' C.T.M. equals 1365' S.L.M.

Signed **D. C. Shackelford**