



Western Michigan University
ScholarWorks at WMU

Legacy Scout Tickets from Pure Oil Company

8-20-2021

MGRRE_PureOilScoutTickets_Perkins, L R_20_21035068830000

MGRRE

Western Michigan University

Follow this and additional works at: <https://scholarworks.wmich.edu/pure>



Part of the Geology Commons

WMU ScholarWorks Citation

MGRRE, "MGRRE_PureOilScoutTickets_Perkins, L R_20_21035068830000" (2021). *Legacy Scout Tickets from Pure Oil Company*. 1217.

<https://scholarworks.wmich.edu/pure/1217>

This Document is brought to you for free and open access via ScholarWorks at WMU. It has been accepted for inclusion in Legacy Scout Tickets from Pure Oil Company by an authorized administrator of ScholarWorks at WMU. See the National Digital Catalogue - Science Base Catalogue for more collections submitted by MGRRE.



MGRRE_PureOilScoutTickets_Perkins, L R_20_21035068830000

API 21035068830000

Permit Number 6883

Lease Name Perkins, L R

Well Number 20

County Clare

Township 18N

Range 06W

Section 14

2021 DEQ or Pure co_name Mid Michigan Gas Storage Company

Pure Number 257

Latitude 43.954369

Longitude -85.0037929

THE PURE OIL COMPANY

LOCATION REPORT

No. 257

DATE October 20, 1939

STATE Michigan COUNTY Clare DIST. Freeman TWP. Freeman SEC. 14 TOWN 18N RANGE 6W
WELL No. 20 (SERIAL No. 257) FARM L. R. Perkins

NAME OF STREAM OR WATERS QUADRANGLE C-NW

OPERATOR Taggart Brothers, Inc. Map Freeman - Clare

200 200 Taggart Bros. Inc. Feet from North Line of Farm

" " East " " "

" " South " " "

1320 1320 " " West " " "

1520 1520 Feet from North Line of Section

" " East " " "

" " South " " "

1320 1320 " " West " " "

LEGEND

- LOCATION
- ⊙ RIG
- ⊕ DRILLING
- ☀ GAS WELL
- OIL WELL
- ⬮ SMALL OIL WELL
- ⊖ DRY HOLE
- ⬮ DRY SHOWING OIL
- ☀ DRY SHOWING GAS
- ⊖ ABANDONED LOCATION
- ☀ ABANDONED GAS WELL
- ⬮ ABANDONED OIL WELL

NOTE: Below make tracing from map, (when no map is obtainable make sketch) showing farm, center of section, this location with measurements and also wells, dry holes, or other locations in the vicinity of this location.

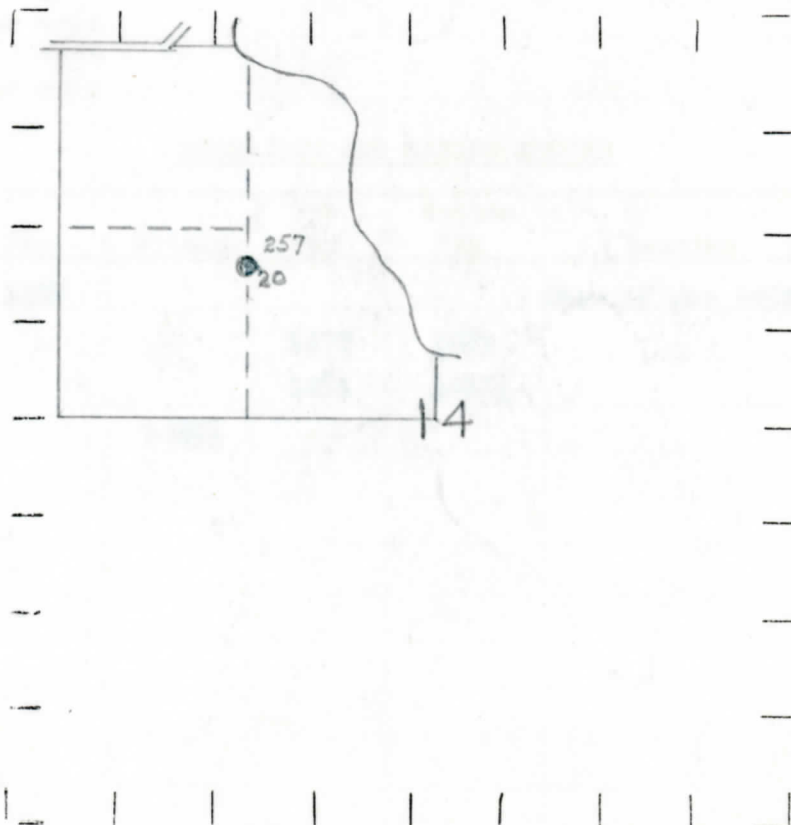

REMARKS:

SIGNED

Superintendent or Foreman.

