



Western Michigan University
ScholarWorks at WMU

Legacy Scout Tickets from Pure Oil Company

8-20-2021

**MGRRE_PureOilScoutTickets_Frackelton, D.
W._21_21035068970000**

MGRRE
Western Michigan University

Follow this and additional works at: <https://scholarworks.wmich.edu/pure>



Part of the Geology Commons

WMU ScholarWorks Citation

MGRRE, "MGRRE_PureOilScoutTickets_Frackelton, D. W._21_21035068970000" (2021). *Legacy Scout Tickets from Pure Oil Company*. 1219.
<https://scholarworks.wmich.edu/pure/1219>

This Document is brought to you for free and open access via ScholarWorks at WMU. It has been accepted for inclusion in Legacy Scout Tickets from Pure Oil Company by an authorized administrator of ScholarWorks at WMU. See the National Digital Catalogue - Science Base Catalogue for more collections submitted by MGRRE.



MGRRE_PureOilScoutTickets_Frackelton, D. W._21_21035068970000

API 21035068970000

Permit Number 6897

Lease Name Frackelton, D. W.

Well Number 21

County Clare

Township 18N

Range 05W

Section 18

2021 DEQ or Pure co_name Taggart Brothers Gas Company

Pure Number 259

Latitude 43.94744

Longitude -84.95409

THE PURE OIL COMPANY

COMPLETION RECORD OF WELLS BY OTHER OPERATORS

DATE October 20, 1939

LOCATION REPORT

No. 259

STATE Michigan COUNTY Clare DIST. Lincoln SEC. 18 TOWN 18N RANGE 5W

WELL No. 21 (SERIAL No. 259) FARM D. W. Frackelton ACRES

NAME OF STREAM OR WATERS _____ QUADRANGLE C-SE

OPERATOR Taggart Brothers, Inc. Map Lincoln - Clare
Taggart Bros. Inc. Lincoln-Clare

Feet from North Line of Farm
1320 1320 " " East " " "
1320 1320 " " South " " "
" " West " " "

Feet from North Line of Section
1320 1320 " " East " " "
1320 1320 " " South " " "
" " West " " "

LEGEND

- LOCATION
- ⊕ RIG
- ⊕ DRILLING
- ☀ GAS WELL
- OIL WELL
- SMALL OIL WELL
- ⊙ DRY HOLE
- DRY SHOWING OIL
- ⊙ DRY SHOWING GAS
- ⊙ ABANDONED LOCATION
- ☀ ABANDONED GAS WELL
- ABANDONED OIL WELL

NOTE: Below make tracing from map, (when no map is obtainable make sketch) showing farm, center of section, this location with measurements and also wells, dry holes, or other locations in the vicinity of this location.

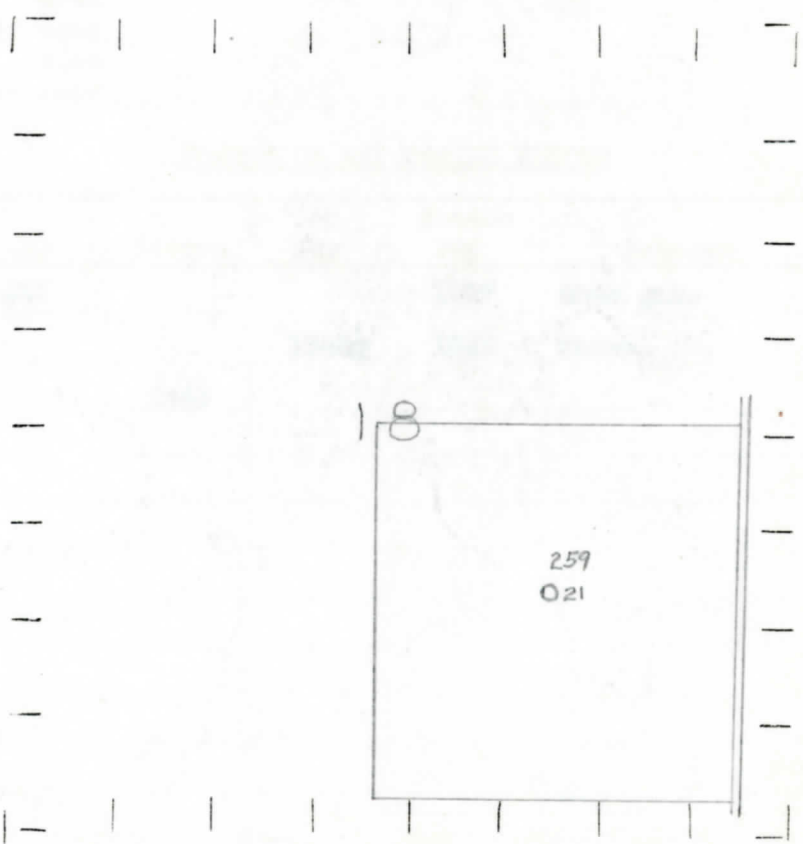

REMARKS: _____

SIGNED

Superintendent or Foreman

