



Western Michigan University
ScholarWorks at WMU

Legacy Scout Tickets from Pure Oil Company

8-20-2021

**MGRRE_PureOilScoutTickets_McIntosh, John
S._1_2103508240000**

MGRRE
Western Michigan University

Follow this and additional works at: <https://scholarworks.wmich.edu/pure>



Part of the Geology Commons

WMU ScholarWorks Citation

MGRRE, "MGRRE_PureOilScoutTickets_McIntosh, John S._1_2103508240000" (2021). *Legacy Scout Tickets from Pure Oil Company*. 1277.
<https://scholarworks.wmich.edu/pure/1277>

This Document is brought to you for free and open access via ScholarWorks at WMU. It has been accepted for inclusion in Legacy Scout Tickets from Pure Oil Company by an authorized administrator of ScholarWorks at WMU. See the National Digital Catalogue - Science Base Catalogue for more collections submitted by MGRRE.



MGRRE_PureOilScoutTickets_McIntosh, John S._1_21035082400000

API 21035082400000

Permit Number 8240

Lease Name McIntosh, John S.

Well Number 1

County Clare

Township 19N

Range 03W

Section 16

2021 DEQ or Pure co_name Oryx Energy Company

Pure Number 338

Latitude 44.04025

Longitude -84.67412

THE PURE OIL COMPANY

DATE November 27, 1940

LOCATION REPORT

No. 338

STATE Michigan

COUNTY Clare

TWP. Hamilton

SEC. 166

TOWN 19th N

RANGE 23rd W

WELL No. 1 (SERIAL No. 338) FARM

PREC. John S. McIntosh

ACRES

NAME OF STREAM OR WATERS

QUADRANGLE C 3 1/2 SW NE

OPERATOR Sun Oil Company

Map Hamilton Township, Clare County

Sun Oil Co

Hamilton - Clare

Feet from North Line of Farm

" " East " " "

330 330

" " South " " "

660 660

" " West " " "

Feet from North Line of Section

" " East " " "

330 330

" " South " " 1/4

660 660

" " West " " "

Sp 11-26-40

LEGEND

○ LOCATION

⊙ RIG

⊕ DRILLING

☀ GAS WELL

● OIL WELL

⦿ SMALL OIL WELL

⊖ DRY HOLE

⦿ DRY SHOWING OIL

⊖ DRY SHOWING GAS

⊖ ABANDONED LOCATION

☀ ABANDONED GAS WELL

⦿ ABANDONED OIL WELL

NOTE: Below make tracing from map. (when no map is obtainable make sketch) showing farm, center of section, this location with measurements and also wells, dry holes, or other locations in the vicinity of this location.

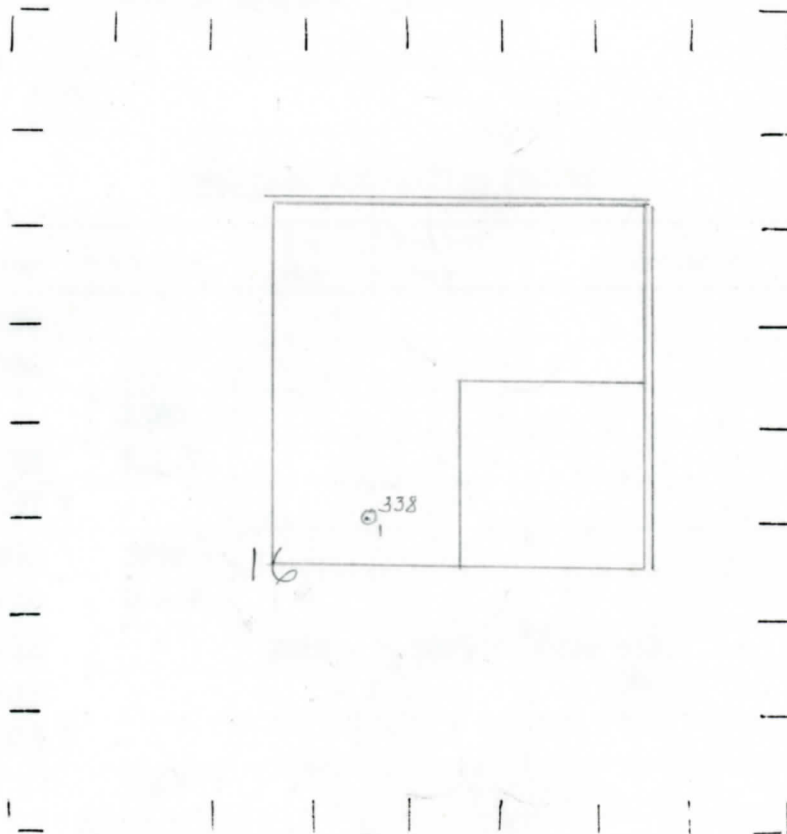

REMARKS:

SIGNED

W

Superintendent or Foreman.

Date March 5, 1941 No. 338
 State Mich. County Clare ~~EXX~~ Twp. Hamilton Sec. 16 Twp. 19 N Rge. 3 W
 Well No. 1 (Serial No.) 338 Farm John S. McIntosh Acres _____
 Operator Sun Oil Company Information secured ~~from~~ By Scouting Department
 Date well started 11-26-40 Date well completed 3-1-41 Elevation 974.6

PRODUCTION RECORD

1st 24 hours natural Temporarily abandoned.
 2nd 24 hours natural _____
 Date of shot _____ No. of quarts _____ From _____ to _____ From _____ to _____
 Date of acid _____ No. of gallons _____
 1st 24 hours after acid shot _____
 2nd 24 hours after acid shot _____

FORMATION AND CASING RECORD

Formation	Top	Bottom	Top Pay	Bottom Pay	Remarks	Casing	
						Size	Set at
Stray	1290					10"	65
Marshall	1364					6-5/8"	1610
Red Rock		1580				5-3/16"	4050
Sunbury	2528	S.L.M.					
Berea	2557 ?						
Antrim	2560	3098					
Traverse Lime	3114	S.L.M.					
Dundee	3818	"	3818	3825	Odor oil.		
Monroe	3910						
Sylvania	5015 ?						
Total Depth		5400					

Remarks Show salt water 3910'-3914'-increase salt water 3914'-3922'-2500 ft. salt water 3928'-3937'-show gas and very small show oil 4804'-4818' ? - 600 ft. salt water 4905'-4929'-water increased to 4000 ft. in hole by time hole drilled to 5065'. 2566' C.T.M. equals 2562' S.L.M.; 3025' C.T.M. equals 3029½' S.L.M.; 3778' C.T.M. equals 3787' S.L.M.

Signed D. G. Shackelford