



Western Michigan University
ScholarWorks at WMU

Legacy Scout Tickets from Pure Oil Company

8-20-2021

**MGRRE_PureOilScoutTickets_State
Winterfield_B-1_21035085310000**

MGRRE

Western Michigan University

Follow this and additional works at: <https://scholarworks.wmich.edu/pure>



Part of the Geology Commons

WMU ScholarWorks Citation

MGRRE, "MGRRE_PureOilScoutTickets_State Winterfield_B-1_21035085310000" (2021). *Legacy Scout Tickets from Pure Oil Company*. 1299.

<https://scholarworks.wmich.edu/pure/1299>

This Document is brought to you for free and open access via ScholarWorks at WMU. It has been accepted for inclusion in Legacy Scout Tickets from Pure Oil Company by an authorized administrator of ScholarWorks at WMU. See the National Digital Catalogue - Science Base Catalogue for more collections submitted by MGRRE.



MGRRE_PureOilScoutTickets_State Winterfield_B-1_21035085310000

API 21035085310000

Permit Number 8531

Lease Name State Winterfield

Well Number B-1

County Clare

Township 20N

Range 06W

Section 36

2021 DEQ or Pure co_name Oryx Energy Company

Pure Number 362

Latitude 44.07732

Longitude -84.98584

THE PURE OIL COMPANY

DATE April 16, 1941

LOCATION REPORT

No. 362

STATE Michigan COUNTY Clare DIST. Winterfield TWP. Winterfield SEC. 36 TOWN 20 N RANGE 6 W
WELL No. 1 (SERIAL No. 362) FARM State-Winterfield "B" ACRES

NAME OF STREAM OR WATERS QUADRANGLE C 13 SW SW

OPERATOR Sun Oil Company Map Winterfield Township, Clare County

330 330 Sun Oil Co Feet from North Line of Farm

" " East " " "

" " South " " "

660 660 " " West " " "

Feet from North Line of Section

" " East " " "

990 990 " " South " 1/4 "

660 660 " " West " " "

LEGEND

- LOCATION
- ⊕ RIG
- ⊕ DRILLING
- ☀ GAS WELL
- OIL WELL
- ◆ SMALL OIL WELL
- ⊖ DRY HOLE
- ◆ DRY SHOWING OIL
- ⊖ DRY SHOWING GAS
- ⊖ ABANDONED LOCATION
- ☀ ABANDONED GAS WELL
- ◆ ABANDONED OIL WELL

NOTE: Below make tracing from map. (when no map is obtainable make sketch) showing farm, center of section, this location with measurements and also wells, dry holes, or other locations in the vicinity of this location.

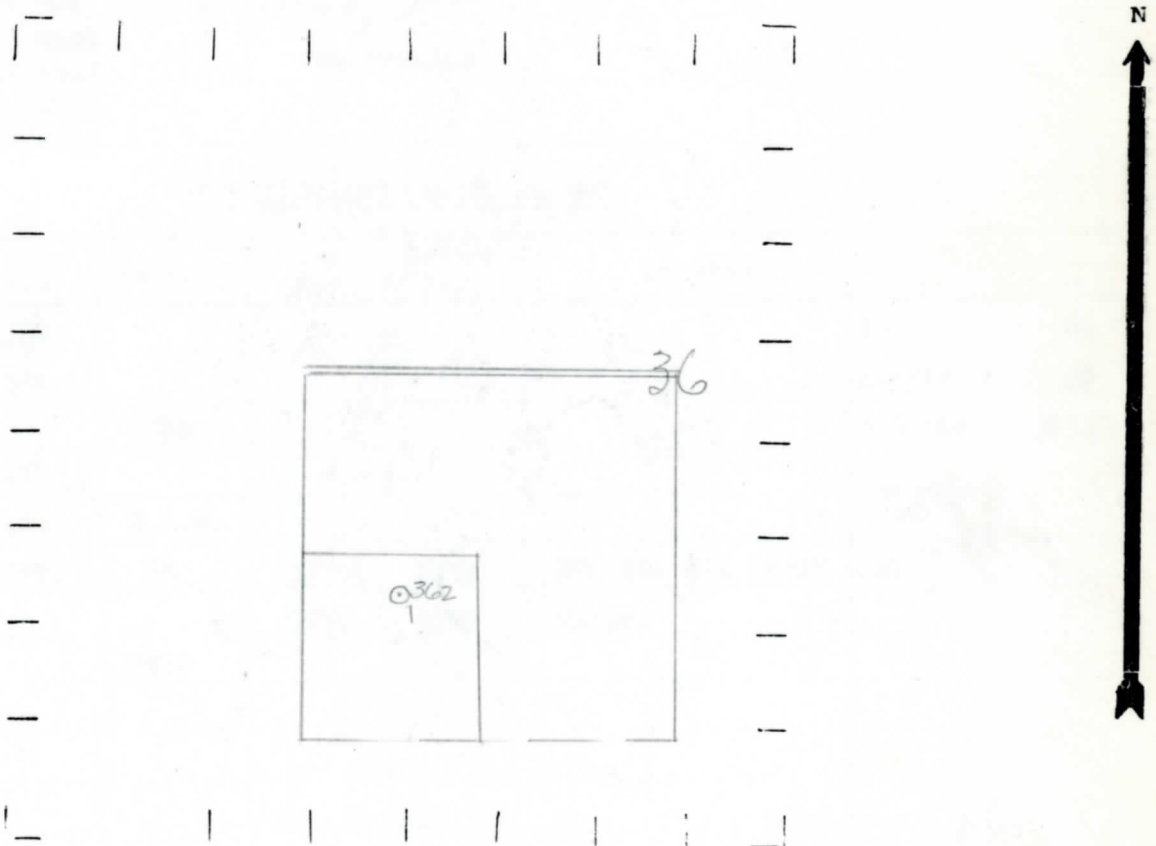

REMARKS:

SIGNED

W

Superintendent or Foreman.

Date June 25, 1941 No. 362
 State Mich. County Clare ~~3186~~ Twp. Winterfield Sec. 36 Twp. 20 N Rge. 6 W
 Well No. B-1 (Serial No.) (County No.) 362 Farm State-Winterfield Acres
 Operator Sun Oil Company Information secured ~~from~~ By Scouting Department
 Date well started 5-2-41 Date well completed 6-23-41 Elevation 1065.9

PRODUCTION RECORD

1st 24 hours natural Dry Hole
 2nd 24 hours natural
 Date of shot _____ No. of quarts _____ From _____ to _____ From _____ to _____
 Date of acid 6-17-41 No. of gallons 200
 1st 24 hours after acid ~~shot~~ No results
 2nd 24 hours after acid shot

FORMATION AND CASING RECORD

Formation	Top	Bottom	Top Pay	Bottom Pay	Remarks	Casing	
						Size	Set at
Stray	1309					10"	64
Marshall	1380					6-5/8"	1629
Red Rock		1570				5-3/16"	3754
Antrim	2421						
Traverse Lime	3126	S.L.M.					
Dundee	3777½	"	3777½	3779	200 ft. oil in 20 hrs.		
			3779	3788	Water.		
Total Depth		3788					

Remarks This well filled up with 600 ft. oil the first 48 hours following the 200 ft. fill-up in 20 hrs.
2476' C.T.M. equals 2487' S.L.M.; 3151' C.T.M. equals 3155' S.L.M.

Signed D. C. Shackelford