



Western Michigan University
ScholarWorks at WMU

Legacy Scout Tickets from Pure Oil Company

8-20-2021

MGRRE_PureOilScoutTickets_Barhite, Ira_1_21035087210000

MGRRE

Western Michigan University

Follow this and additional works at: <https://scholarworks.wmich.edu/pure>



Part of the Geology Commons

WMU ScholarWorks Citation

MGRRE, "MGRRE_PureOilScoutTickets_Barhite, Ira_1_21035087210000" (2021). *Legacy Scout Tickets from Pure Oil Company*. 1312.

<https://scholarworks.wmich.edu/pure/1312>

This Document is brought to you for free and open access via ScholarWorks at WMU. It has been accepted for inclusion in Legacy Scout Tickets from Pure Oil Company by an authorized administrator of ScholarWorks at WMU. See the National Digital Catalogue - Science Base Catalogue for more collections submitted by MGRRE.



MGRRE_PureOilScoutTickets_Barhite, Ira_1_21035087210000

API 21035087210000

Permit Number 8721

Lease Name Barhite, Ira

Well Number 1

County Clare

Township 20N

Range 06W

Section 30

2021 DEQ or Pure co_name McClanahan Oil Company

Pure Number 381

Latitude 44.09347

Longitude -85.07452

THE PURE OIL COMPANY

DATE July 2, 1941

LOCATION REPORT OTHER OPERATORS

No. 381

STATE Michigan

COUNTY Clare

Clare

TWP Winterfield

SEC 30

TOWN 20 N

RANGE 6 W

WELL No. 1' (SERIAL No. 381) FARM

Ira Barhite

ACRES

NAME OF STREAM OR WATERS

QUADRANGLE C E 2 NW SE

OPERATOR McClanahan Oil Company

Map

Winterfield Township, Clare County

660 660 Feet from North Line of Farm

330 330 " " East " " "

660 660 " " South " " "

660 660 " " West " " "

660 660 Feet from North Line of Section 1/4

" " East " " "

" " South " " "

990 990 " " West " 1/4 "

LEGEND

○ LOCATION

⊕ RIG

⊕ DRILLING

☀ GAS WELL

● OIL WELL

◆ SMALL OIL WELL

⊙ DRY HOLE

◆ DRY SHOWING OIL

⊙ DRY SHOWING GAS

⊙ ABANDONED LOCATION

☀ ABANDONED GAS WELL

◆ ABANDONED OIL WELL

NOTE: Below make tracing from map. (when no map is obtainable make sketch) showing farm, center of section, this location and measurements and also wells, dry holes, or other locations in the vicinity of this location.

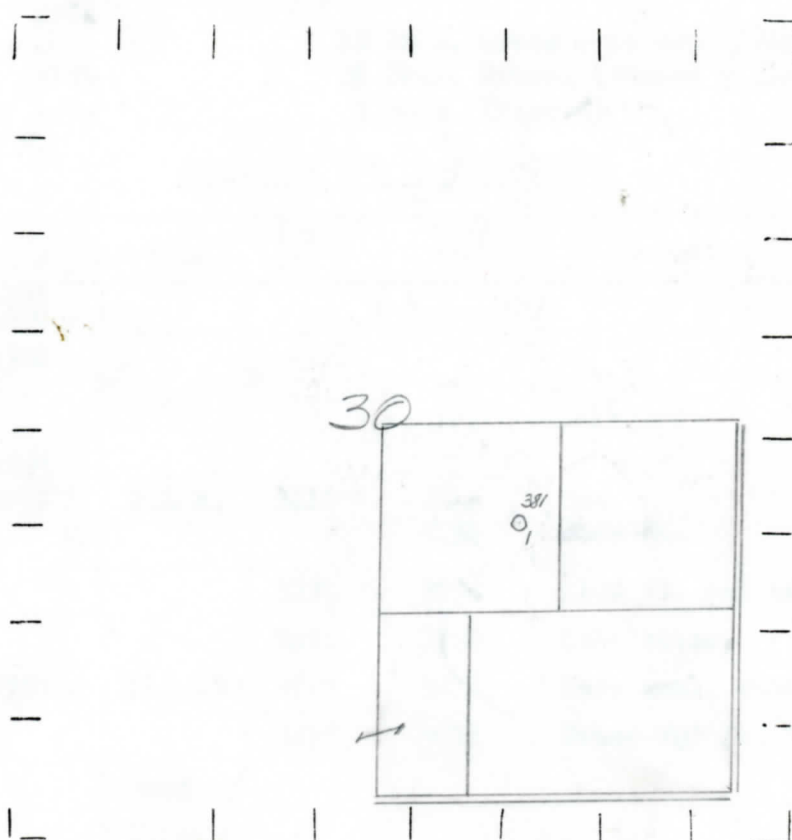

REMARKS:

SIGNED

Superintendent or Foreman.

