



Western Michigan University
ScholarWorks at WMU

Legacy Scout Tickets from Pure Oil Company

8-20-2021

MGRRE_PureOilScoutTickets_Michigan Gas Storage Co aka Consumers Power Co _237_21035128190000

MGRRE

Western Michigan University

Follow this and additional works at: <https://scholarworks.wmich.edu/pure>



Part of the Geology Commons

WMU ScholarWorks Citation

MGRRE, "MGRRE_PureOilScoutTickets_Michigan Gas Storage Co aka Consumers Power Co _237_21035128190000" (2021). *Legacy Scout Tickets from Pure Oil Company*. 1572.
<https://scholarworks.wmich.edu/pure/1572>

This Document is brought to you for free and open access via ScholarWorks at WMU. It has been accepted for inclusion in Legacy Scout Tickets from Pure Oil Company by an authorized administrator of ScholarWorks at WMU. See the National Digital Catalogue - Science Base Catalogue for more collections submitted by MGRRE.



**MGRRE_PureOilScoutTickets_Michigan Gas Storage Co aka Consumers Power
Co _237_21035128190000**

API 21035128190000

Permit Number 12819

Lease Name Michigan Gas Storage Co aka Consumers Power Co

Well Number 237

County Clare

Township 20N

Range 06W

Section 29

2021 DEQ or Pure co_name Consumers Energy Company

Pure Number 687

Latitude 44.1010206

Longitude -85.0506255

THE PURE OIL COMPANY

LOCATION REPORT

Date December 4, 1946 A.F.E. No. _____
 Division Mich. Producing District _____ Lease Consumers Power Co.
 Acres _____ Lease No. _____ Elevation _____ Well No. 237 (Serial No. 687)
 Quadrangle C NE NE Sec. 29 Twp. 20 N Rge. 6 W Twp. Winterfield
 Survey _____ County Clare State Michigan
 Operator Consumers Power Co. Map Winterfield Township, Clare County

<u>660</u>	<u>660</u>	Feet from North Line of Lease
<u>660</u>	<u>660</u>	" " East " " "
		" " South " " "
		" " West " " "
<u>660</u>	<u>660</u>	Feet from North Line of Section
<u>660</u>	<u>660</u>	" " East " " "
		" " South " " "
		" " West " " "

LEGEND

- Location
- ☀ Gas Well
- Oil Well
- ☀ Gas - Distillate Well
- ∅ or ○ Dry Hole
- Dry Showing Oil
- ☀ Dry Showing Gas
- ⊗ Abandoned Location
- ☀ or ☀ Abandoned Gas Well
- or ● Abandoned Oil Well
- or ○ Input Well

Low

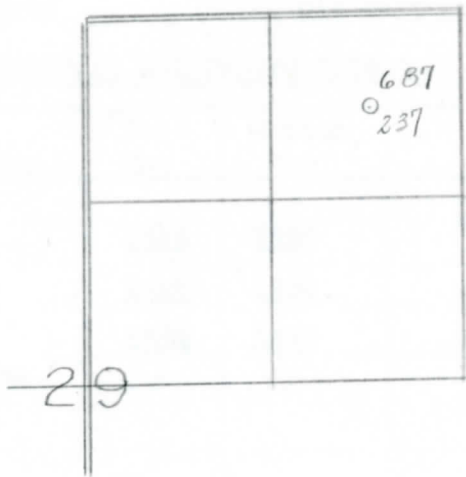

Scale _____

Remarks: _____

Submitted by CB Civil Engineer Approved by _____ Division Manager
 Approved by _____ Vice-President - General Manager

Date December 31, 1946

LOCATION RECORD
THE PURE OIL COMPANY

V.L.E. No.

COMPLETION RECORD OF WELLS DRILLED BY OTHER OPERATORS

Michigan Producing DIVISION

Date December 31, 1946 No. 687
 State Mich. Co. Clare ~~Base~~ Twp. Winterfield Sec. 29 Twp. 20 N Rge. 6 W
 Well No. 237 Serial No. 687 Farm Fee Acres _____
 Operator Consumers Power Company
 Date started 12-11-46 Date completed 12-29-46 Elevation 1087.3

PRODUCTION RECORD

1st 24 hours natural 2,300,000 Cu. Ft.
 Date of shot _____ No. of quarts _____ From _____ To _____ From _____ To _____
 Date of acid _____ No. of gallons shot _____
 1st 24 hours after acid _____
 Completed as: Oil Well _____ Gas Well X Dry Hole _____

FORMATION AND CASING RECORD

Formation	Top	Bottom	Top Pay	Bottom Pay	Remarks	Casing	
						Size	Set at
Brown Dolomite	1152	(-65)				13-3/8"	233
Mich. Stray	1288	(-201)	1318	1320	(-231)	8-5/8"	1286
			1322	1324	(-235)		
			1332	1333	(-245)		
Total Depth		1338	(-251)				

Remarks _____

Signed Harry J. Gaspeny