



Western Michigan University  
ScholarWorks at WMU

---

Legacy Scout Tickets from Pure Oil Company

---

8-20-2021

**MGRRE\_PureOilScoutTickets\_Hanson, R. aka Sallilng-  
Hansen\_3\_21039003779000**

MGRRE  
*Western Michigan University*

Follow this and additional works at: <https://scholarworks.wmich.edu/pure>



Part of the Geology Commons

---

#### WMU ScholarWorks Citation

MGRRE, "MGRRE\_PureOilScoutTickets\_Hanson, R. aka Sallilng-Hansen\_3\_21039003779000" (2021).  
*Legacy Scout Tickets from Pure Oil Company*. 1586.  
<https://scholarworks.wmich.edu/pure/1586>

This Document is brought to you for free and open access via ScholarWorks at WMU. It has been accepted for inclusion in Legacy Scout Tickets from Pure Oil Company by an authorized administrator of ScholarWorks at WMU. See the National Digital Catalogue - Science Base Catalogue for more collections submitted by MGRRE.



---

**MGRRE\_PureOilScoutTickets\_Hanson, R. aka Salliling-  
Hansen\_3\_21039003779000**

API 21039003779000

Permit Number 377

Lease Name Hanson, R. aka Salliling-Hansen

Well Number 3

County Crawford

Township 26N

Range 3W

Section 7

2021 DEQ or Pure co\_name Salling, Hanson and Company

Pure Number 1

Latitude 44.66053

Longitude -84.72442

## THE PURE OIL COMPANY

DATE June 16th 1928 LOCATION REPORT No. 1  
 STATE Michigan COUNTY Crawford DIST. Grayling SEC. 7 TOWN 26N RANGE 3W  
 WELL No. 3 (SERIAL No. 1) FARM Salling-Hansen ACRES  
 NAME OF STREAM OR WATERS QUADRANGLE  
 OPERATOR Salling-Hansen MAP Grayling Sp. Crawford Co.

Feet from North Line of Farm

" " East " " "

" " South " " "

" " West " " "

Feet from North Line of Section

" " East " " "

" " South " " "

" " West " " "

## LEGEND

O LOCATION

① RIG

⊕ DRILLING

⊙ GAS WELL

● OIL WELL

⬮ SMALL OIL WELL

⬮ DRY HOLE

⬮ DRY SHOWING OIL

⬮ DRY SHOWING GAS

⬮ ABANDONED LOCATION

⬮ ABANDONED GAS WELL

⬮ ABANDONED OIL WELL

NOTE: Below make tracing from map (when no map is obtainable make sketch), showing farm, center of section, this location with measurements and also wells, dry holes, or other locations in the vicinity of this location. Make copy to keep for reference and send original to Columbus office.

Elevation  
1120

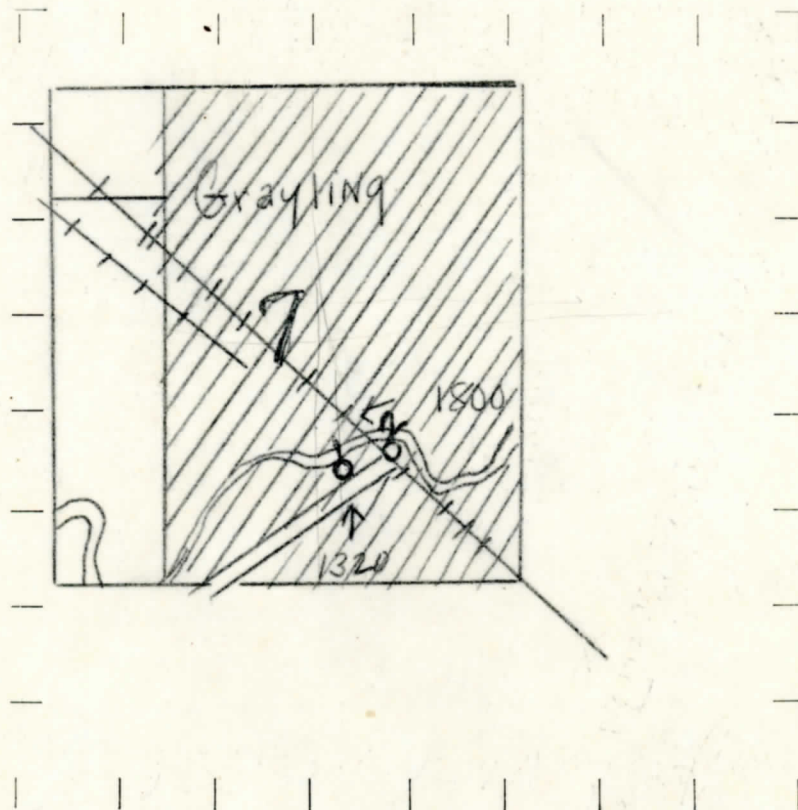

REMARKS:

SIGNED

Superintendent or Foreman.

SHEET 20  
 DATE 7/10/28  
 STATE Mich COUNTY Crawford DIST. TWP. Chapling SEC. 7 TOWN 26N RANGE 3W  
 WELL No. 3 (SERIAL No. 1) FARM Salling & Hansen ACRES  
 NAME OF STREAM OR WATERS QUADRANGLE  
 OPERATOR Salling & Hansen MAP 2 1/2 mi

Feet from North Line of Farm  
 " " East " " "  
 " " South " " "  
 " " West " " "  
 Feet from North Line of Section  
 about 1800 " " East " " "  
 about 1350 " " South " " "  
 " " West " " "

- LEGEND**
- LOCATION
  - ⊙ RIG
  - ⊕ DRILLING
  - ⊗ GAS WELL
  - OIL WELL
  - ⦿ SMALL OIL WELL
  - ⦿ DRY HOLE
  - ⦿ DRY SHOWING OIL
  - ⦿ DRY SHOWING GAS
  - ⦿ ABANDONED LOCATION
  - ⦿ ABANDONED GAS WELL
  - ⦿ ABANDONED OIL WELL

NOTE: Below make tracing from map (when no map is obtainable make sketch), showing farm, center of section, this location with measurements and also wells, dry holes, or other locations in the vicinity of this location. Make copy to keep for reference and send original to Columbus office.

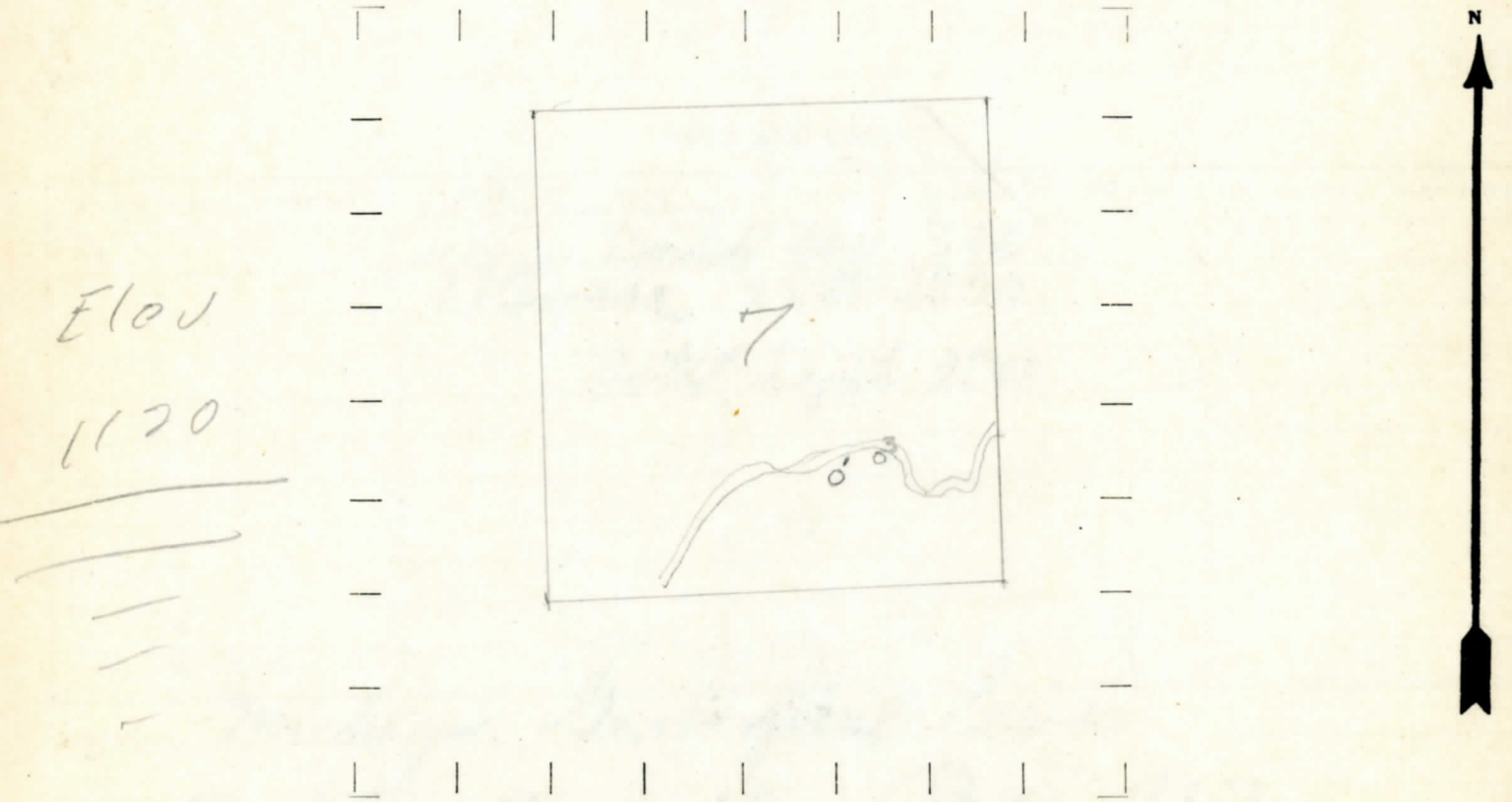

REMARKS:

SIGNED  
 Superintendent or Foreman.



LOCATION BEFORE

No.

# COMPLETION RECORD

No. 1

STATE Michigan COUNTY Crawford TWP. Grayling SEC. 1 TOWN 40th RANGE 2nd

WELL No. 3 (SERIAL No. 1) FARM Selling - Transfer ACRES

NAME OF STREAM OR WATERS.

**QUADRANGLE**

OPERATOR Selling - Hansen MAP Shanghai Sp. Hayward Co

LOCATION REPORT SENT IN (DATE)

WELL STARTED (DATE)

WELL COMPLETED (DATE)

ON WEVL

~~GAS WELL~~

## DRY HOLE

## ABANDONED WELL

**CROSS OUT THREE OF THE ABOVE**

## WELL RECORD

DATE OF SHOT.

NUMBER OF QUARTS.

### 1st 24 HOURS PRODUCTION

**BARRELS OR FEET**

2nd " " " \_\_\_\_\_ " " "

3rd " " " \_\_\_\_\_ " " "

4th " " " \_\_\_\_\_ " " "

5th " " " \_\_\_\_\_ " " "

## SAND AND CASING

[illegible]

REMARKS.

NOTE:—MAKE COPY TO KEEP FOR REFERENCE AND SEND ORIGINAL TO CHICAGO OFFICE. LIST MATERIAL CHARGEABLE TO WELL ON OTHER SIDE.

SIGNED

**SUPT. OR FOREMAN**

Crawford Co #1.  
Mich. Geol. Series, Buil. 14, page 213  
upper Marshall 440540  
2280-2800  
Traverse

Elev. 1120

T.D. 2800