



Western Michigan University  
ScholarWorks at WMU

---

Legacy Scout Tickets from Pure Oil Company

---

8-20-2021

**MGRRE\_PureOilScoutTickets\_STARR, CHARLES  
W.\_1\_21039118070000**

MGRRE  
*Western Michigan University*

Follow this and additional works at: <https://scholarworks.wmich.edu/pure>



Part of the Geology Commons

---

#### WMU ScholarWorks Citation

MGRRE, "MGRRE\_PureOilScoutTickets\_STARR, CHARLES W.\_1\_21039118070000" (2021). *Legacy Scout Tickets from Pure Oil Company*. 1597.  
<https://scholarworks.wmich.edu/pure/1597>

This Document is brought to you for free and open access via ScholarWorks at WMU. It has been accepted for inclusion in Legacy Scout Tickets from Pure Oil Company by an authorized administrator of ScholarWorks at WMU. See the National Digital Catalogue - Science Base Catalogue for more collections submitted by MGRRE.



---

**MGRRE\_PureOilScoutTickets\_STARR, CHARLES W.\_1\_21039118070000**

API 21039118070000

Permit Number 11807

Lease Name STARR, CHARLES W.

Well Number 1

County Crawford

Township 25N

Range 1W

Section 30

2021 DEQ or Pure co\_name MCCLANAHAN OIL CO

Pure Number 32

Latitude 44.53133

Longitude -84.4726

## THE PURE OIL COMPANY

## LOCATION REPORT

Date September 12, 1945

A.F.E. No. \_\_\_\_\_

Division Mich. Producing

District \_\_\_\_\_

Lease \_\_\_\_\_

CHAS. W. STARR  
Chas. W. Starr

Acres \_\_\_\_\_ Lease No. \_\_\_\_\_

Elevation \_\_\_\_\_

Well No. 1 (Serial No. 32)Quadrangle NE NE SESec. 30Twp. 25 NRge. 1 W~~XXXX~~  
~~XXXX~~  
Twp. \_\_\_\_\_SOUTH BRANCH  
South BranchSurvey \_\_\_\_\_ County CrawfordState MichiganOperator McClanahan Oil CompanyMap South Branch Township, Crawford County330 330 Feet from North Line of Lease330 330 " " East " " "

" " South " " "

" " West " " "

330 330 Feet from North Line 1/4 Section330 330 " " East " " "

" " South " " "

" " West " " "

## LEGEND

○ Location



Gas Well



Dry Showing Gas



Oil Well



Abandoned Location



Gas-Distillate Well



Abandoned Gas Well



Dry Hole



Abandoned Oil Well



Dry Showing Oil



Input Well

N

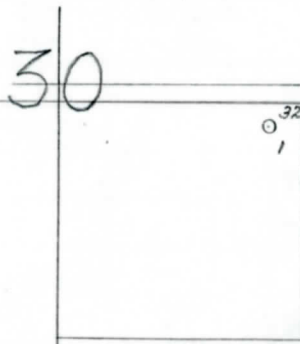

Scale \_\_\_\_\_

Remarks: \_\_\_\_\_

Submitted by \_\_\_\_\_

Civil Engineer

Approved by \_\_\_\_\_

Division Manager

Approved by \_\_\_\_\_

Vice-President - General Manager

COMPLETION RECORD OF WELLS DRILLED BY OTHER OPERATORS

Michigan Producing Division

Date February 28, 1946 No. 32  
 State Michigan Co. Crawford ~~Dixie~~ Twp. South Branch Sec. 30 Twp. 25 N Rge. 1 W  
 Well No. 1 Serial No. 32 Farm Chas. W. Starr Acres \_\_\_\_\_  
 Operator McClanahan Oil Company  
 Date started 10-6-45 Date completed 2-14-46 Elevation 1246.0

PRODUCTION RECORD

1st 24 hours natural \_\_\_\_\_  
 Date of shot \_\_\_\_\_ No. of quarts \_\_\_\_\_ From \_\_\_\_\_ To \_\_\_\_\_ From \_\_\_\_\_ to \_\_\_\_\_  
 Date of acid \_\_\_\_\_ No. of gallons \_\_\_\_\_  
 1st 24 hours after acid \_\_\_\_\_  
 Completed as: Oil Well \_\_\_\_\_ Gas Well \_\_\_\_\_ Dry Hole X

FORMATION AND CASING RECORD

| Formation       | Top  | Bottom   | Top Pay  | Bottom Pay | Remarks                                  | Casing  |         |
|-----------------|------|----------|----------|------------|--|---------|---------|
|                 |      |          |          |            |  | Size    | Set at  |
| Marshall        | 484  | (+762)   |          |            | H.F.S.W. 735. (+511)                     | 10"     | 490     |
| Antrim          | 1700 | 2255     | (-454)s  |            |  | 8-1/4"  | 755     |
| Traverse Lime   | 2271 | (-1025)s |          |            | Very small show                          | 6-5/8"  | 3182    |
| <i>Traverse</i> | 2255 | (-1009)  |          |            | oil 2285. (-1039)                        | 5-3/16" | 4282    |
| Dundee          | 3007 | SLM.     | (-1761)s |            |  |         |         |
| Detroit River   | ?    |          |          |            | Small show oil 3968-3977. (-272w)        |         |         |
|                 |      |          |          | (-2943)    | 700 ft. S.W. 4189 (water from Dundee)    |         |         |
|                 |      |          |          |            | Small show gas 4318. (-3072)             |         |         |
|                 |      |          |          | (-3158)    | Show gas 4404-gauged 67,000 cu. ft.      |         |         |
|                 |      |          |          |            | Very small show oil 5160. (-3914)        |         |         |
|                 |      |          |          |            | Show salt water 5175. (-3729)            |         |         |
|                 |      |          |          |            | 200 ft. black salt water in 4 hrs. 5215. |         |         |
| Total Depth     |      | 5215     | (-3969)  |            |  |         | (-3969) |

Remarks 1658' eq. 1667' SOM; 2265' eq. 2267' SOM; 3056' eq. 3056' SLM; 4308' eq. 4300' SLM; 4440' eq. 4427' CDM.

Salt-3395-4085

B. Anhy. 4220 PB-4442-D-A

Signed D. C. Shackelford