



Western Michigan University  
ScholarWorks at WMU

---

Legacy Scout Tickets from Pure Oil Company

---

8-20-2021

## MGRRE\_PureOilScoutTickets\_Test Hole\_19\_None

MGRRE

*Western Michigan University*

Follow this and additional works at: <https://scholarworks.wmich.edu/pure>



Part of the Geology Commons

---

### WMU ScholarWorks Citation

MGRRE, "MGRRE\_PureOilScoutTickets\_Test Hole\_19\_None" (2021). *Legacy Scout Tickets from Pure Oil Company*. 1601.

<https://scholarworks.wmich.edu/pure/1601>

This Document is brought to you for free and open access via ScholarWorks at WMU. It has been accepted for inclusion in Legacy Scout Tickets from Pure Oil Company by an authorized administrator of ScholarWorks at WMU. See the National Digital Catalogue - Science Base Catalogue for more collections submitted by MGRRE.



---

**MGRRE\_PureOilScoutTickets\_Test Hole\_19\_None**

API None

Permit Number None

Lease Name Test Hole

Well Number 19

County Eaton

Township 01N

Range 06W

Section 28

2021 DEQ or Pure co\_name Burt Portland Cement Company

Pure Number 4

Latitude 42.443675

Longitude -85.022990

THE PURE OIL COMPANY  
LOCATION REPORT

No. 4

DATE 7-13-34  
7-13-34

STATE Mich COUNTY Eaton DIST. Bellevue SEC. 28 TOWN 1N RANGE 6W  
 STATE Michigan COUNTY Eaton TWP. Bellevue SEC. 28 TOWN 1N RANGE 6W  
 WELL No. 19 (SERIAL No. 4) FARM Test Hole (Bellevue Village) ACRES

NAME OF STREAM OR WATERS \_\_\_\_\_ QUADRANGLE \_\_\_\_\_

OPERATOR \_\_\_\_\_ MAP Bellevue Township, Eaton County  
Bellevue Twp. - Eaton Co.

\_\_\_\_\_ Feet from North Line of Farm  
 \_\_\_\_\_ " " East " " "  
 \_\_\_\_\_ " " South " " "  
 \_\_\_\_\_ " " West " " "  
 \_\_\_\_\_ Feet from North Line of Section  
 \_\_\_\_\_ " " East " " "  
1300 1300 " " South " " "  
1500 1500 " " West " " "

LEGEND

- LOCATION
- ⊙ RIG
- ⊕ DRILLING
- ⊗ GAS WELL
- OIL WELL
- ⊙ SMALL OIL WELL
- ⊕ DRY HOLE
- ⊗ DRY SHOWING OIL
- ⊗ DRY SHOWING GAS
- ⊕ ABANDONED LOCATION
- ⊗ ABANDONED GAS WELL
- ⊙ ABANDONED OIL WELL

NOTE: Below make tracing from map, (when no map is obtainable make sketch) showing farm, center of section, this location with measurements and also wells, dry holes, or other locations in the vicinity of this location. Make copy to keep for reference and send original to Columbus office.

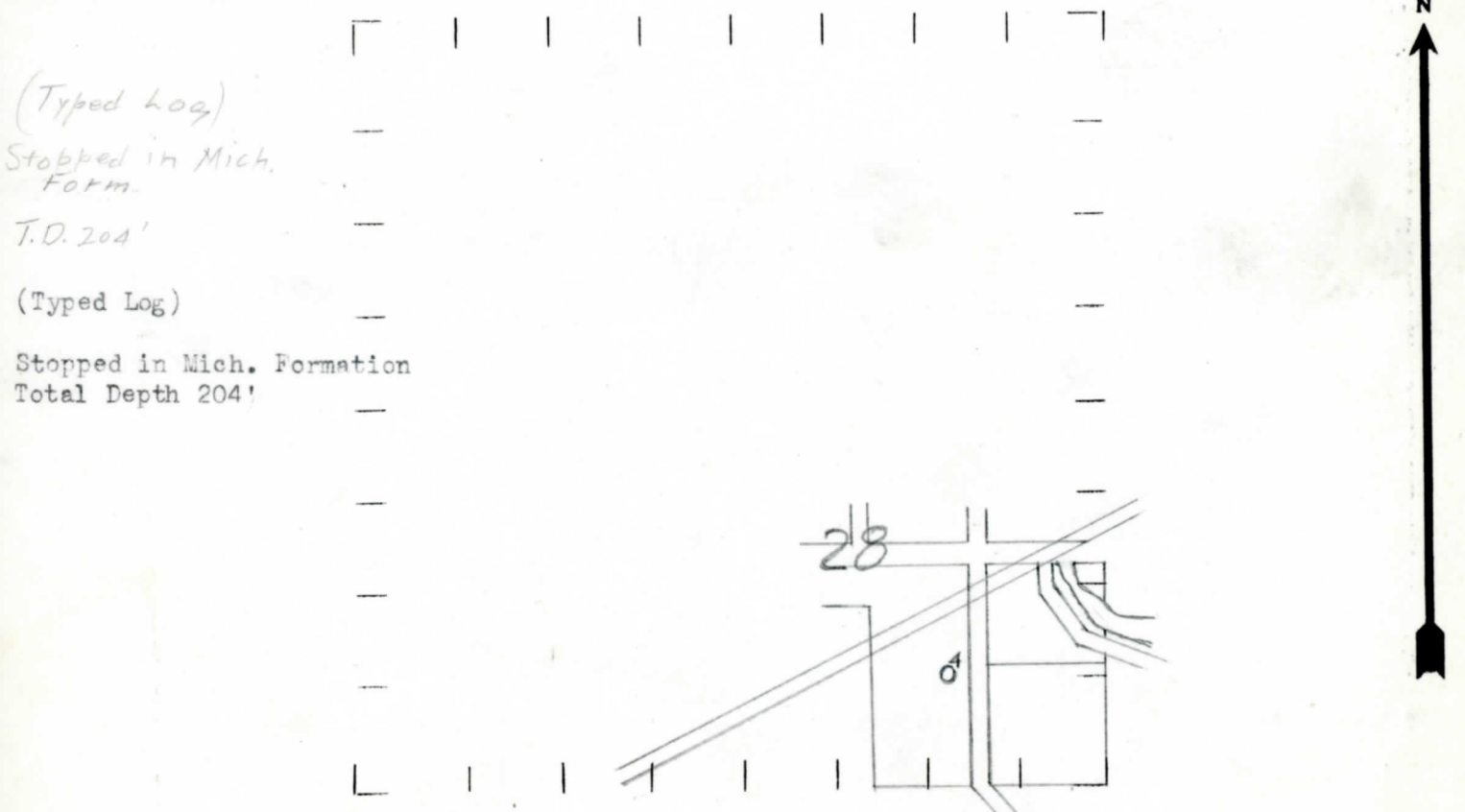

(Typed Log)  
 Stopped in Mich. Form.  
 T.D. 204'  
 (Typed Log)  
 Stopped in Mich. Formation  
 Total Depth 204'

REMARKS: \_\_\_\_\_  
 \_\_\_\_\_  
 \_\_\_\_\_

SIGNED R. P. Jensen  
 Superintendent or Foreman.