



Western Michigan University
ScholarWorks at WMU

Legacy Scout Tickets from Pure Oil Company

8-20-2021

MGRRE_PureOilScoutTickets_Huber Brothers_1_21045004209000

MGRRE

Western Michigan University

Follow this and additional works at: <https://scholarworks.wmich.edu/pure>



Part of the Geology Commons

WMU ScholarWorks Citation

MGRRE, "MGRRE_PureOilScoutTickets_Huber Brothers_1_21045004209000" (2021). *Legacy Scout Tickets from Pure Oil Company*. 1606.

<https://scholarworks.wmich.edu/pure/1606>

This Document is brought to you for free and open access via ScholarWorks at WMU. It has been accepted for inclusion in Legacy Scout Tickets from Pure Oil Company by an authorized administrator of ScholarWorks at WMU. See the National Digital Catalogue - Science Base Catalogue for more collections submitted by MGRRE.



MGRRE_PureOilScoutTickets_Huber Brothers_1_21045004209000

API 21045004209000

Permit Number 420

Lease Name Huber Brothers

Well Number 1

County Eaton

Township 2N

Range 4W

Section 28

2021 DEQ or Pure co_name Wittmer Oil and Gas Properties Co

Pure Number 9

Latitude 42.52397

Longitude -84.78781

THE PURE OIL COMPANY
LOCATION REPORT

No.

DATE July 9th 1927

STATE Michigan COUNTY Eaton DIST. Eaton DIVISION 28 TOWN 2N RANGE 4E
PREC.

WELL No. 1 (SERIAL No. 9) FARM Huber Bros 180 ACRES

NAME OF STREAM OR WATERS _____ QUADRANGLE _____

OPERATOR Wittmer Oil + Gas Properties MAP _____

Feet from North Line of Farm

“ “ East “ “ “

“ “ South “ “ “

“ “ West “ “ “

Feet from North Line of Section

“ “ East “ “ “

“ “ South “ “ “

“ “ West “ “ “

LEGEND

○ LOCATION

⊕ RIG

⊕ DRILLING

⊙ GAS WELL

● OIL WELL

⊙ SMALL OIL WELL

⊙ DRY HOLE

⊙ DRY SHOWING OIL

⊙ DRY SHOWING GAS

⊙ ABANDONED LOCATION

⊙ ABANDONED GAS WELL

⊙ ABANDONED OIL WELL

NOTE: Below make tracing from map, (when no map is obtainable make sketch) showing farm, center of section, this location with measurements and also wells, dry holes, or other locations in the vicinity of this location. Make copy to keep for reference and send original to Chicago office.

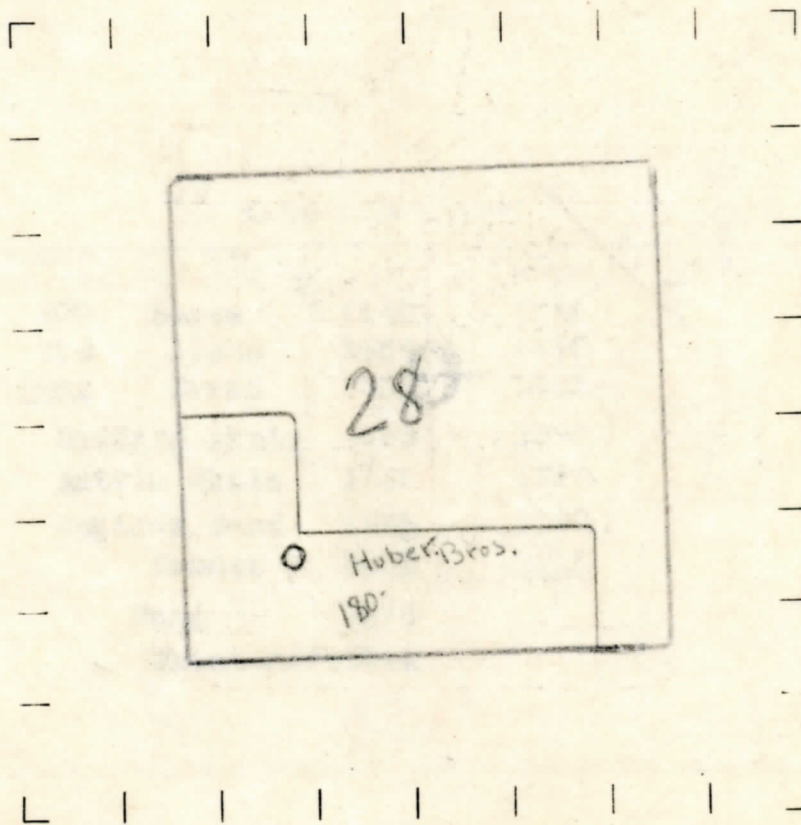

REMARKS:

SIGNED

Superintendent or Foreman.

DATE Mar. 17th 1928. **COMPLETION RECORD** No. 9

STATE Michigan COUNTY Eaton DIST. TWP. Eaton SEC. 28 TOWN 2N RANGE 4W
 PREC.

WELL No. 1 (SERIAL No. 9) Farm Huber Bros ACRES 180

NAME OF STREAM OR WATERS QUADRANGLE

OPERATOR Wittimer Oil & Gas Properties MAP Eaton Tp., Eaton Co.

LOCATION REPORT SENT IN (DATE) July 9th 1927

WELL STARTED (DATE) June 1927 WELL COMPLETED (DATE)

OIL WELL
 GAS WELL
 DRY HOLE
 ABANDONED WELL

CROSS OUT THREE OF THE ABOVE
WELL RECORD

DATE OF SHOT	NUMBER OF QUARTS	BARRELS OR FEET
1st 24 HOURS PRODUCTION		
2nd " " "		" " "
3rd " " "		" " "
4th " " "		" " "
5th " " "		" " "

SAND AND CASING

CASING SIZE	WEIGHT	CASING Feet Inches	SAND Name and Nature	TOP	BOTTOM	TOP PAY	BOTTOM PAY	SALT WATER
10"		100	Berea	1440	1454			
8 1/4		719	slate	1454	1460			
6 5/8		2300	Berea	1460	1483			
			Bedford shale	1483	1690			
			Antrim Shale	1730	1746			
			Saginaw Sand	1955	1990			
			Dundee	2078	2115			
			Sand	2570				
			Trenton(?)	2844				

REMARKS
