



Western Michigan University  
ScholarWorks at WMU

---

Legacy Scout Tickets from Pure Oil Company

---

8-20-2021

## MGRRE\_PureOilScoutTickets\_Heath, S.P. and G. W.\_1\_unk

MGRRE

*Western Michigan University*

Follow this and additional works at: <https://scholarworks.wmich.edu/pure>



Part of the Geology Commons

---

### WMU ScholarWorks Citation

MGRRE, "MGRRE\_PureOilScoutTickets\_Heath, S.P. and G. W.\_1\_unk" (2021). *Legacy Scout Tickets from Pure Oil Company*. 1631.

<https://scholarworks.wmich.edu/pure/1631>

This Document is brought to you for free and open access via ScholarWorks at WMU. It has been accepted for inclusion in Legacy Scout Tickets from Pure Oil Company by an authorized administrator of ScholarWorks at WMU. See the National Digital Catalogue - Science Base Catalogue for more collections submitted by MGRRE.



---

MGRRE\_PureOilScoutTickets\_Heath, S.P. and G. W.\_1\_unk

API unk

Permit Number unk

Lease Name Heath, S.P. and G. W.

Well Number 1

County Genesee

Township 9N

Range 6E

Section 3

2021 DEQ or Pure co\_name Smith Pet Co

Pure Number 8

Latitude 43.2139041

Longitude -83.7447898

THE PURE OIL COMPANY

DATE February 2, 1934

LOCATION REPORT

No. 8

STATE Michigan COUNTY Genesee DIST. Vienna TWP. Vienna SEC. 3 TOWN 9 N RANGE 6 E

WELL No. 1 (SERIAL No. 8) FARM S. P. & G. W. Heath ACRES

NAME OF STREAM OR WATERS QUADRANGLE SE-NE-NE

OPERATOR Smith Petroleum Company (Core Test) MAP Vienna Township, Genesee County

1000 Feet from North Line of Farm Elevation 677'  
50 " " East " " "  
 " " South " " "  
 " " West " " "  
1000 Feet from North Line of Section  
50 " " East " " "  
 " " South " " "  
 " " West " " "

**LEGEND**

- LOCATION
- ⊕ RIG
- ⊙ DRILLING
- ⊛ GAS WELL
- OIL WELL
- ⊕ SMALL OIL WELL
- ⊛ DRY HOLE
- ⊙ DRY SHOWING OIL
- ⊙ DRY SHOWING GAS
- ⊙ ABANDONED LOCATION
- ⊙ ABANDONED GAS WELL
- ⊙ ABANDONED OIL WELL

NOTE: Below make tracing from map, (when no map is obtainable make sketch) showing farm, center of section, this location with measurements and also wells, dry holes, or other locations in the vicinity of this location. Make copy to keep for reference and send original to Columbus office.

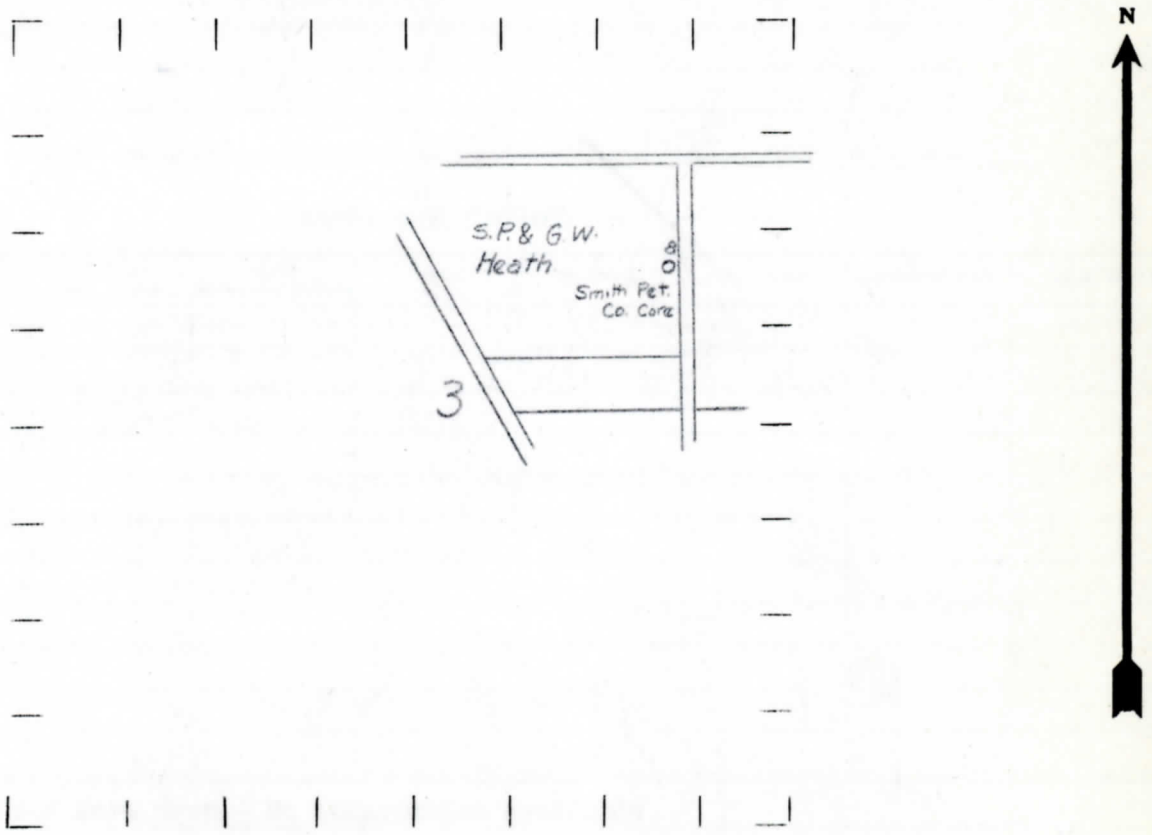

REMARKS:  
 -----  
 -----  
 -----

SIGNED R. L. Yeager  
 Superintendent or Foreman.

THE PURE OIL COMPANY

Michigan Producing DIVISION

COMPLETION RECORD

No. 8

DATE March 9, 1934

STATE Michigan COUNTY Genesee DIST. TWP. Vienna SEC. 3 TOWN 9 N RANGE 6 E  
PREC.

WELL No. 1 (SERIAL No. 8) FARM S. P. & G. W. Heath ACRES

NAME OF STREAM OR WATERS QUADRANGLE SE-NE-NE

OPERATOR Smith Petroleum Company MAP Vienna Township, Genesee County

LOCATION REPORT SENT IN (DATE) 2/2/34

WELL STARTED (DATE) January, 1934 WELL COMPLETED (DATE) February, 1934

OIL WELL     
  GAS WELL     
  DRY HOLE     
  ABANDONED WELL

Elevation 677'

CROSS OUT THREE OF THE ABOVE  
WELL RECORD

DATE OF SHOT \_\_\_\_\_ NUMBER OF QUARTS \_\_\_\_\_

1st 24 HOURS PRODUCTION	CORE TEST	BARRELS OR FEET
2nd " " "	_____	" " "
3rd " " "	_____	" " "
4th " " "	_____	" " "
5th " " "	_____	" " "

SAND AND CASING

CASING SIZE	WEIGHT	CASING		SAND Name and Nature	TOP	BOTTOM	TOP PAY	BOTTOM PAY	SALT WATER
		Feet	Inches						

REMARKS Completed Core Test - No information available.

NOTE:—MAKE COPY TO KEEP FOR REFERENCE AND SEND ORIGINAL TO CHICAGO OFFICE. LIST MATERIAL CHARGEABLE TO WELL ON OTHER SIDE.

SIGNED G. N. Bell SUPT. OR FOREMAN