



Western Michigan University
ScholarWorks at WMU

Legacy Scout Tickets from Pure Oil Company

8-20-2021

**MGRRE_PureOilScoutTickets_HERMANN, ADELBERT
C._1_21049072750000**

MGRRE
Western Michigan University

Follow this and additional works at: <https://scholarworks.wmich.edu/pure>



Part of the Geology Commons

WMU ScholarWorks Citation

MGRRE, "MGRRE_PureOilScoutTickets_HERMANN, ADELBERT C._1_21049072750000" (2021). *Legacy Scout Tickets from Pure Oil Company*. 1641.
<https://scholarworks.wmich.edu/pure/1641>

This Document is brought to you for free and open access via ScholarWorks at WMU. It has been accepted for inclusion in Legacy Scout Tickets from Pure Oil Company by an authorized administrator of ScholarWorks at WMU. See the National Digital Catalogue - Science Base Catalogue for more collections submitted by MGRRE.



MGRRE_PureOilScoutTickets_HERMANN, ADELBERT C._1_21049072750000

API 21049072750000

Permit Number 7275

Lease Name HERMANN, ADELBERT C.

Well Number 1

County Genesee

Township 6N

Range 5E

Section 13

2021 DEQ or Pure co_name BURR LEWIS

Pure Number 18

Latitude 42.92104

Longitude -83.82914

THE PURE OIL COMPANY

DATE January 24, 1940

COMPLETION RECORD OF LOCATION REPORT OTHER OPERATORS

No. 18

STATE Michigan

COUNTY Genesee

Genesee

DIST. Gaines
TWP. Gaines
RANGE. 13

TOWN 6 N

SEC. 13

RANGE 5 E

TOWN 6 N

RANGE 5 E

WELL No. 1 (SERIAL No. 18) FARM

A. C. Hermann

ACRES

NAME OF STREAM OR WATERS

QUADRANGLE SW SW NW

OPERATOR Lewis Burr

Map

Gaines Township, Genesee County

Lewis Burr

Gaines-Genesee

Feet from North Line of Farm

" " East " " "

33 330

" " South " " "

40 400

" " West " " "

Feet from North Line of Section

" " East " " "

33 330

" " South " 1/4

40 400

" " West " " "

LEGEND

○ LOCATION

⊕ RIG

⊕ DRILLING

☀ GAS WELL

● OIL WELL

● SMALL OIL WELL

⊖ DRY HOLE

● DRY SHOWING OIL

⊖ DRY SHOWING GAS

⊖ ABANDONED LOCATION

☀ ABANDONED GAS WELL

● ABANDONED OIL WELL

NOTE: Below make tracing from map, (when no map is obtainable make sketch) showing farm, center of section, this location with measurements and also wells, dry holes, or other locations in the vicinity of this location.

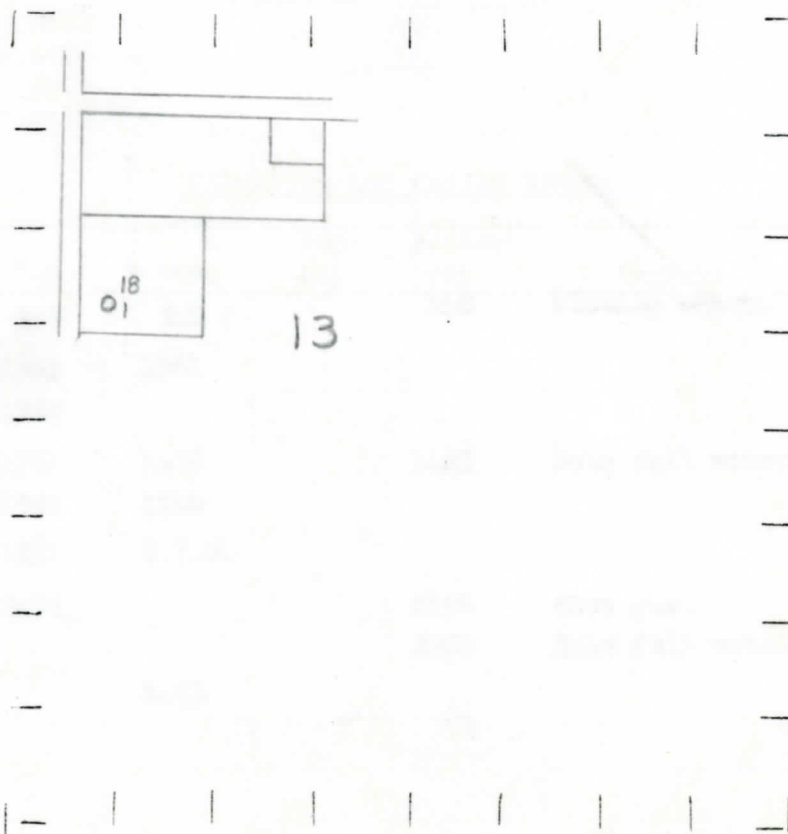

REMARKS:

SIGNED

Superintendent or Foreman.

Michigan Producing Division

Date August 14, 1940 No. 18
 State Mich. County Genesee ~~Rock~~ Twp. Gaines Sec. 13 Twp. 6 N Rge. 5 E
 Well No. 1 (Serial No.) ~~18~~ Farm A. C. Hermann Acres _____
 Operator Lewis Burr Information secured ~~from~~ ^{By} Scouting Department
 Date well started 6-13-40 Dated well completed 8-2-40 Elevation 796.6

PRODUCTION RECORD

1st 24 hours natural Dry Hole
 2nd 24 hours natural _____
 Date of shot _____ No. of quarts _____ From _____ to _____ From _____ to _____
 Date of acid _____ No. of gallons _____
 1st 24 hours after acid ^{shot} _____
 2nd 24 hours after acid ^{shot} _____

FORMATION AND CASING RECORD

Formation	Top	Bottom	Top Pay	Bottom Pay	Remarks	Casing	
						Size	Set at
Marshall	265	340 ?		148	Flowing water.	10"	118
Red Rock	1353	1361				8-1/4"	525
Sunbury	1368					6-5/8"	1501
Berea	1391	1478		1425	Hole full water.		
Antrim	1592	1740					
Traverse Lime	1831	C.T.M.					
Dundee	2198			2198	Show gas.		
				2359	Hole full water.		
Total Depth		2493					

Remarks _____

Signed D. C. Shackelford