



Western Michigan University
ScholarWorks at WMU

Legacy Scout Tickets from Pure Oil Company

8-20-2021

MGRRE_PureOilScoutTickets_LYON, L. T._1_21049100620000

MGRRE

Western Michigan University

Follow this and additional works at: <https://scholarworks.wmich.edu/pure>



Part of the Geology Commons

WMU ScholarWorks Citation

MGRRE, "MGRRE_PureOilScoutTickets_LYON, L. T._1_21049100620000" (2021). *Legacy Scout Tickets from Pure Oil Company*. 1648.

<https://scholarworks.wmich.edu/pure/1648>

This Document is brought to you for free and open access via ScholarWorks at WMU. It has been accepted for inclusion in Legacy Scout Tickets from Pure Oil Company by an authorized administrator of ScholarWorks at WMU. See the National Digital Catalogue - Science Base Catalogue for more collections submitted by MGRRE.



MGRRE_PureOilScoutTickets_LYON, L. T._1_21049100620000

API 21049100620000

Permit Number 10062

Lease Name LYON, L. T.

Well Number 1

County Genesee

Township 9N

Range 8E

Section 26

2021 DEQ or Pure co_name BURTON JOHN F

Pure Number 25

Latitude 43.15726

Longitude -83.481

THE PURE OIL COMPANY

LOCATION REPORT

Date April 21, 1943 A.F.E. No. _____

Division Michigan Producing District _____ Lease L.T. Lyon
L. T. Lyon

Acres _____ Lease No. _____ Elevation _____ Well No. 1 (Serial No. 25)

Quadrangle NE-NE-SE Sec. 26 Twp. 9 N Rge. 8 E Twp. Forest
NE NE SE 26 9 N 8 E Forest

Survey _____ County Genesee State Michigan

Operator John F. Burton Map Forest Twp - Genesee Co.
John F. Burton Forest Township, Genesee County

<u>550</u>	<u>550</u>	Feet from North Line of Lease
<u>330</u>	<u>330</u>	" " East " " "
		" " South " " "
		" " West " " "
<u>550</u>	<u>550</u>	Feet from North Line of Section
<u>330</u>	<u>330</u>	" " East " " "
		" " South " " "
		" " West " " "

Cum

LEGEND

- Location
- ☀ Gas Well
- Oil Well
- ☀ Gas - Distillate Well
- ∅ or ○ Dry Hole
- Dry Showing Oil
- ☀ Dry Showing Gas
- ⊗ Abandoned Location
- ☀ or ☀ Abandoned Gas Well
- or ● Abandoned Oil Well
- or ○ Input Well

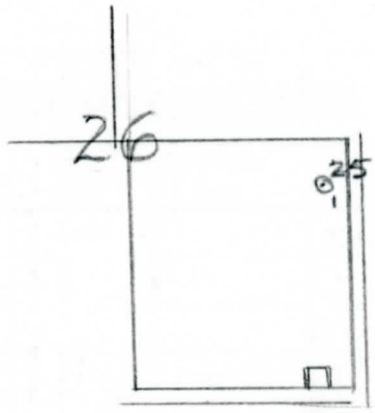

Scale _____

Remarks: _____

Submitted by RN _____
Civil Engineer

Approved by _____
Division Manager

Approved by _____
Vice-President - General Manager

COMPLETION RECORD OF WELLS DRILLED BY OTHER OPERATORS

Michigan Producing Division

Date 10-13-43 No. 25
State Mich. County Genesee Twp. Forest Sec. 26 Twp. 9 N Rge. 8 E
Well No. 1 (Serial No.) 25 Farm L. T. Lyon Acres
Operator John F. Burton Information secured By Scouting Department
Date well started 4-21-43 Date well completed 9-17-43 Elevation 845.3

PRODUCTION BOARD

1st 24 hours natural Dry Hole
2nd 24 hours natural
Date of shot No. of quarts From to From to
Date of acid No. of gallons
1st 24 hours after acid shot
2nd 24 hours after acid shot

FORMATION AND CASING RECORD

Table with columns: Formation, Top, Bottom, Top Pay, Bottom Pay, Remarks, Casing Size, Casing Set at. Rows include Drift, Marshall, Coldwater Red Rock, Sunbury, Berea, Antrim, Traverse Lime, and Total Depth.

Remarks

Signed Dean C. Shackelford