



Western Michigan University  
ScholarWorks at WMU

---

Legacy Scout Tickets from Pure Oil Company

---

8-20-2021

**MGRRE\_PureOilScoutTickets\_MC CARTY,  
DAN\_1\_21049112380000**

MGRRE  
*Western Michigan University*

Follow this and additional works at: <https://scholarworks.wmich.edu/pure>



Part of the Geology Commons

---

#### **WMU ScholarWorks Citation**

MGRRE, "MGRRE\_PureOilScoutTickets\_MC CARTY, DAN\_1\_21049112380000" (2021). *Legacy Scout Tickets from Pure Oil Company*. 1655.  
<https://scholarworks.wmich.edu/pure/1655>

This Document is brought to you for free and open access via ScholarWorks at WMU. It has been accepted for inclusion in Legacy Scout Tickets from Pure Oil Company by an authorized administrator of ScholarWorks at WMU. See the National Digital Catalogue - Science Base Catalogue for more collections submitted by MGRRE.



---

**MGRRE\_PureOilScoutTickets\_MC CARTY, DAN\_1\_21049112380000**

API 21049112380000

Permit Number 11238

Lease Name MC CARTY, DAN

Well Number 1

County Genesee

Township 9N

Range 8E

Section 11

2021 DEQ or Pure co\_name HEINIG HUGH H

Pure Number 32

Latitude 43.19613

Longitude -83.49191

THE PURE OIL COMPANY

LOCATION REPORT

Date November 29, 1914 A.F.E. No. Dan McCarty  
 Division Mich. Producing District \_\_\_\_\_ Lease 3 Dan McCarty  
 Acres \_\_\_\_\_ Lease No. \_\_\_\_\_ Elevation \_\_\_\_\_ Well No. 1 (Serial No. 32)  
 Quadrangle SE SE SW Sec. 11 Twp. 9 N Rge. 8 E Twp. Forest  
 Survey \_\_\_\_\_ County Genesee State Michigan  
 Operator Hugh H. Heinig Map Forest Twp, Genesee Co.  
Forest Township, Genesee County

|                                 |                         |
|---------------------------------|-------------------------|
| Feet from North Line of Lease   |                         |
| <u>450</u> <u>450</u>           | " " East " " "          |
| <u>400</u> <u>400</u>           | " " South " " "         |
|                                 | " " West " " "          |
| Feet from North Line of Section |                         |
| <u>450</u> <u>450</u>           | " " East " " <u>1/4</u> |
| <u>400</u> <u>400</u>           | " " South " " "         |
|                                 | " " West " " "          |

**LEGEND**

- Location
- ☉ Gas Well
- Oil Well
- ☉ Gas - Distillate Well
- ∅ or ○ Dry Hole
- Dry Showing Oil
- ☉ Dry Showing Gas
- ⊗ Abandoned Location
- ☉ or ☉ Abandoned Gas Well
- or ● Abandoned Oil Well
- or ○ Input Well

*Reu*

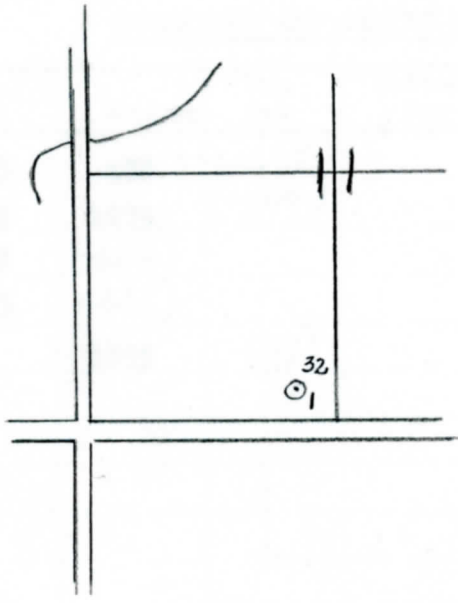

Remarks: \_\_\_\_\_ Scale \_\_\_\_\_

Submitted by \_\_\_\_\_ Civil Engineer Approved by \_\_\_\_\_ Division Manager  
 Approved by \_\_\_\_\_ Vice-President - General Manager

Michigan Producing Division

Date December 28, 1944 No. 32  
 State Mich. County Genesee Dist. Forest Twp. Forest Sec. 11 Twp. 9 N Rge. 8 E  
 Well No. 1 (Serial No.) 32 Farm Dan McCarty Acres \_\_\_\_\_  
 Operator Hugh H. Heinig Information secured ~~from~~ Scouting Department By \_\_\_\_\_  
 Date well started 12-2-44 Date well completed 12-21-44 Elevation 858.0

PRODUCTION BOARD

1st 24 hours natural Dry Hole  
 2nd 24 hours natural \_\_\_\_\_  
 Date of shot \_\_\_\_\_ No. of quarts \_\_\_\_\_ From \_\_\_\_\_ to \_\_\_\_\_ From \_\_\_\_\_ to \_\_\_\_\_  
 Date of acid \_\_\_\_\_ No. of gallons \_\_\_\_\_  
 1st 24 hours after acid shot \_\_\_\_\_  
 2nd 24 hours after acid shot \_\_\_\_\_

FORMATION AND CASING RECORD

| Formation       | Top  | Bottom | Top Pay | Bottom Pay | Remarks             | Casing |        |
|-----------------|------|--------|---------|------------|---------------------|--------|--------|
|                 |      |        |         |            |                     | Size   | Set at |
| Marshall        | 223  | 490    | (+635)  |            |                     | 10"    | 192    |
| Coldw. Red Rock | 1255 | 1273   | (-397)  |            |                     | 8-1/4" | 520    |
| Sunbury         | 1502 | (-644) |         |            |                     |        |        |
| Berea           | 1543 | (-685) |         |            | H.F.S.W. 1548-1555. |        |        |
| Total Depth     |      | 1555   | (-697)  |            | (-690)              |        |        |
|                 |      |        |         |            |                     |        |        |
|                 |      |        |         |            |                     |        |        |
|                 |      |        |         |            |                     |        |        |
|                 |      |        |         |            |                     |        |        |
|                 |      |        |         |            |                     |        |        |
|                 |      |        |         |            |                     |        |        |
|                 |      |        |         |            |                     |        |        |
|                 |      |        |         |            |                     |        |        |
|                 |      |        |         |            |                     |        |        |
|                 |      |        |         |            |                     |        |        |
|                 |      |        |         |            |                     |        |        |

Remarks \_\_\_\_\_  
 \_\_\_\_\_  
 \_\_\_\_\_

Signed D. C. Shackelford