



Western Michigan University
ScholarWorks at WMU

Legacy Scout Tickets from Pure Oil Company

8-20-2021

**MGRRE_PureOilScoutTickets_LANFEAR,
HARRY_2_21049155840000**

MGRRE
Western Michigan University

Follow this and additional works at: <https://scholarworks.wmich.edu/pure>



Part of the Geology Commons

WMU ScholarWorks Citation

MGRRE, "MGRRE_PureOilScoutTickets_LANFEAR, HARRY_2_21049155840000" (2021). *Legacy Scout Tickets from Pure Oil Company*. 1670.
<https://scholarworks.wmich.edu/pure/1670>

This Document is brought to you for free and open access via ScholarWorks at WMU. It has been accepted for inclusion in Legacy Scout Tickets from Pure Oil Company by an authorized administrator of ScholarWorks at WMU. See the National Digital Catalogue - Science Base Catalogue for more collections submitted by MGRRE.



MGRRE_PureOilScoutTickets_LANFEAR, HARRY_2_21049155840000

API 21049155840000

Permit Number 15584

Lease Name LANFEAR, HARRY

Well Number 2

County Genesee

Township 9N

Range 8E

Section 6

2021 DEQ or Pure co_name PALMER CLYDE L

Pure Number 47

Latitude 43.22111

Longitude -83.5613

WELL REPORT - OUTSIDE OPERATIONS

SERIAL NO. 47

STATE Michigan ^{PSM} _{CO.} Genesee

OPERATOR Clyde L. Palmer

FARM Harry Lanfear WELL NO. 2

TWP Forest S. 6 T. 9N R. 3E

LOC. SE NE NE - 590' from north and 330'
from east line of quarter section.

WILDCAT FIELD FIELD NAME Otisville

MAP NO. _____ CO-ORD. _____ ELEV. _____

STATUS Spudded 11-11-49. Drilling 130'.

The NE-1/4 of this section is
Fractional

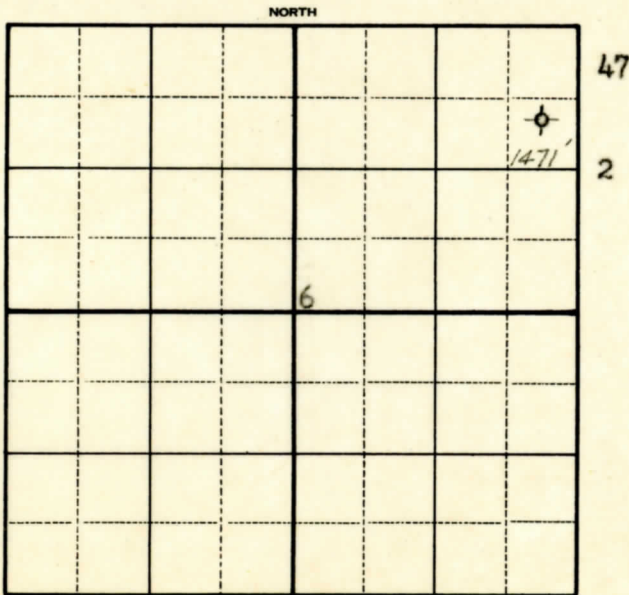

DATE 11-14-49 SCOUT H. J. G.