



Western Michigan University
ScholarWorks at WMU

Legacy Scout Tickets from Pure Oil Company

8-20-2021

MGRRE_PureOilScoutTickets_George Spicer_1_na

MGRRE

Western Michigan University

Follow this and additional works at: <https://scholarworks.wmich.edu/pure>



Part of the Geology Commons

WMU ScholarWorks Citation

MGRRE, "MGRRE_PureOilScoutTickets_George Spicer_1_na" (2021). *Legacy Scout Tickets from Pure Oil Company*. 1725.

<https://scholarworks.wmich.edu/pure/1725>

This Document is brought to you for free and open access via ScholarWorks at WMU. It has been accepted for inclusion in Legacy Scout Tickets from Pure Oil Company by an authorized administrator of ScholarWorks at WMU. See the National Digital Catalogue - Science Base Catalogue for more collections submitted by MGRRE.



MGRRE_PureOilScoutTickets_George Spicer_1_na

API na

Permit Number na

Lease Name George Spicer

Well Number 1

County Gladwin

Township 17N

Range 2W

Section 11

2021 DEQ or Pure co_name Doran and Sprenger

Pure Number 50

Latitude 43.8797401

Longitude -84.515333

THE PURE OIL COMPANY
 LOCATION REPORT

DATE October 22, 1936 No. 50
 STATE Michigan COUNTY Gladwin DIST. Beaverton SEC. 11 TOWN 17 N RANGE 2 W
 WELL No. 1 (SERIAL No. 50) FARM George Spicer ACRES _____

NAME OF STREAM OR WATERS _____ QUADRANGLE NW NE NW

OPERATOR O. B. Doran and W. W. Sprenger Map Beaverton Township, Gladwin County
193 193 O.B. Doran & W.W. Sprenger Beaverton - Glad. Co.

193 193 Feet from North Line of Farm
 " " East " " "
108 108 " " South " " "
405 405 Feet from North Line of Section
1212 1212 " " East " 1/4
 " " South " " "
 " " West " " "

LEGEND

- LOCATION
- ⊙ RIG
- ⊕ DRILLING
- ☀ GAS WELL
- OIL WELL
- ⬮ SMALL OIL WELL
- ⊖ DRY HOLE
- ◆ DRY SHOWING OIL
- ⊙ DRY SHOWING GAS
- ⊖ ABANDONED LOCATION
- ☀ ABANDONED GAS WELL
- ⬮ ABANDONED OIL WELL

NOTE: Below make tracing from map, (when no map is obtainable make sketch) showing farm, center of section, this location with measurements and also wells, dry holes, or other locations in the vicinity of this location.

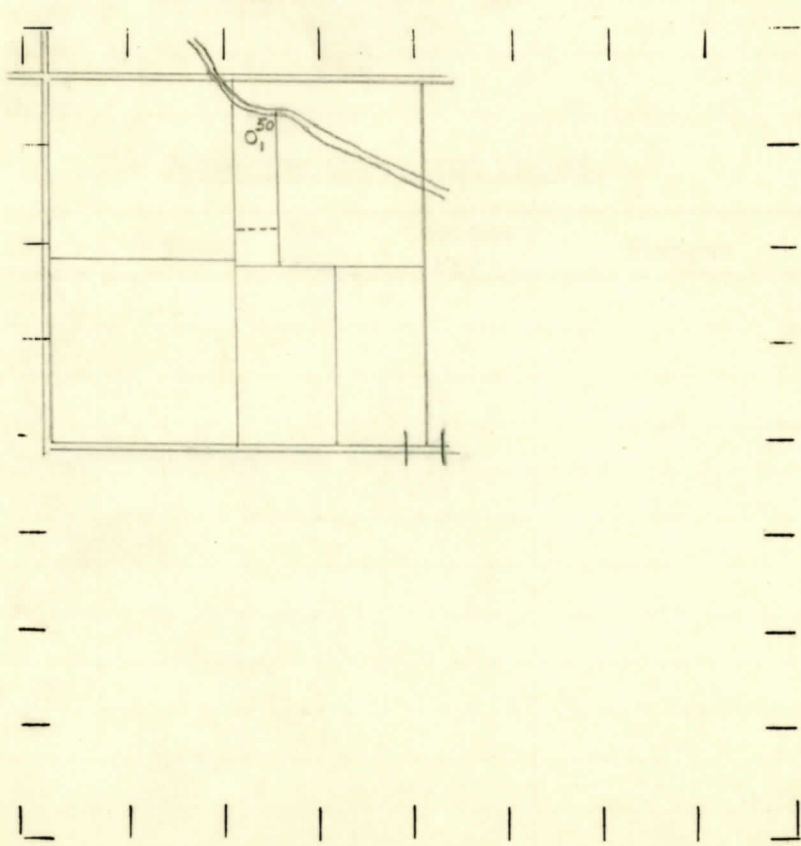

REMARKS:

SIGNED R. L. Younger
 Superintendent or Foreman.

COMPLETION RECORD OF WELLS DRILLED BY OTHER OPERATORS

Michigan Producing Division

Date November 5, 1936 No. 50
State Michigan County Gladwin Dist. Twp. Beaverton Sec. 11 Twp. 17 N Rge. 2 W
Well No. 1 (County No.) 50 Farm George Spicer Acres
Operator O. B. Doran & W. W. Sprenger Information secured by Scouting Department

Date well started Not started Date well completed Not completed Elevation

PRODUCTION RECORD

1st 24 hours natural Location abandoned
2nd 24 hours natural
Date of shot No. of quarts From to From to
Date of acid No. of gallons
1st 24 hours after acid shot
2nd 24 hours after acid shot

FORMATION AND CASING RECORD

Table with columns: Formation, Top, Bottom, Top Pay, Bottom Pay, Remarks, Casing Size, Casing Set At. Includes note: Location abandoned 11-3-36.

Remarks

Signed G. H. Bell