



Western Michigan University
ScholarWorks at WMU

Legacy Scout Tickets from Pure Oil Company

8-20-2021

MGRRE_PureOilScoutTickets_Felix Gerard_1_na

MGRRE

Western Michigan University

Follow this and additional works at: <https://scholarworks.wmich.edu/pure>



Part of the Geology Commons

WMU ScholarWorks Citation

MGRRE, "MGRRE_PureOilScoutTickets_Felix Gerard_1_na" (2021). *Legacy Scout Tickets from Pure Oil Company*. 1943.

<https://scholarworks.wmich.edu/pure/1943>

This Document is brought to you for free and open access via ScholarWorks at WMU. It has been accepted for inclusion in Legacy Scout Tickets from Pure Oil Company by an authorized administrator of ScholarWorks at WMU. See the National Digital Catalogue - Science Base Catalogue for more collections submitted by MGRRE.



MGRRE_PureOilScoutTickets_Felix Gerard_1_na

API na

Permit Number na

Lease Name Felix Gerard

Well Number 1

County Gladwin

Township 17N

Range 1W

Section 12

2021 DEQ or Pure co_name Bond. Oil Dev Co

Pure Number 269

Latitude 43.8789929

Longitude -84.3760079

The Pure Oil Company
THE PURE OIL COMPANY

DATE May 28, 1937

LOCATION REPORT

No. 269

STATE Michigan COUNTY Gladwin DIST. Tobacco TWP. Tobacco SEC. 12 TOWN 17 N RANGE 1 W

WELL No. 1 (SERIAL No. 269) FARM Felix Girard ACRES

NAME OF STREAM OR WATERS QUADRANGLE NW-NE-NE

OPERATOR Bond Oil Development Company Map Tobacco Township, Gladwin County

330 330 Feet from North Line of Farm

" " East " " "

" " South " " "

330 330 " " West " " "

330 330 Feet from North Line of Section

990 990 " " East " " "

" " South " " "

" " West " " "

C. W.

- LOCATION
- ⊙ RIG
- ⊕ DRILLING
- ☀ GAS WELL
- OIL WELL
- ⊙ SMALL OIL WELL

LEGEND

- ⊙ DRY HOLE
- ⊙ DRY SHOWING OIL
- ⊙ DRY SHOWING GAS
- ⊙ ABANDONED LOCATION
- ☀ ABANDONED GAS WELL
- ⊙ ABANDONED OIL WELL

NOTE: Below make tracing from map, (when no map is obtainable make sketch) showing farm, center of section, this location with measurements and also wells, dry holes, or other locations in the vicinity of this location.

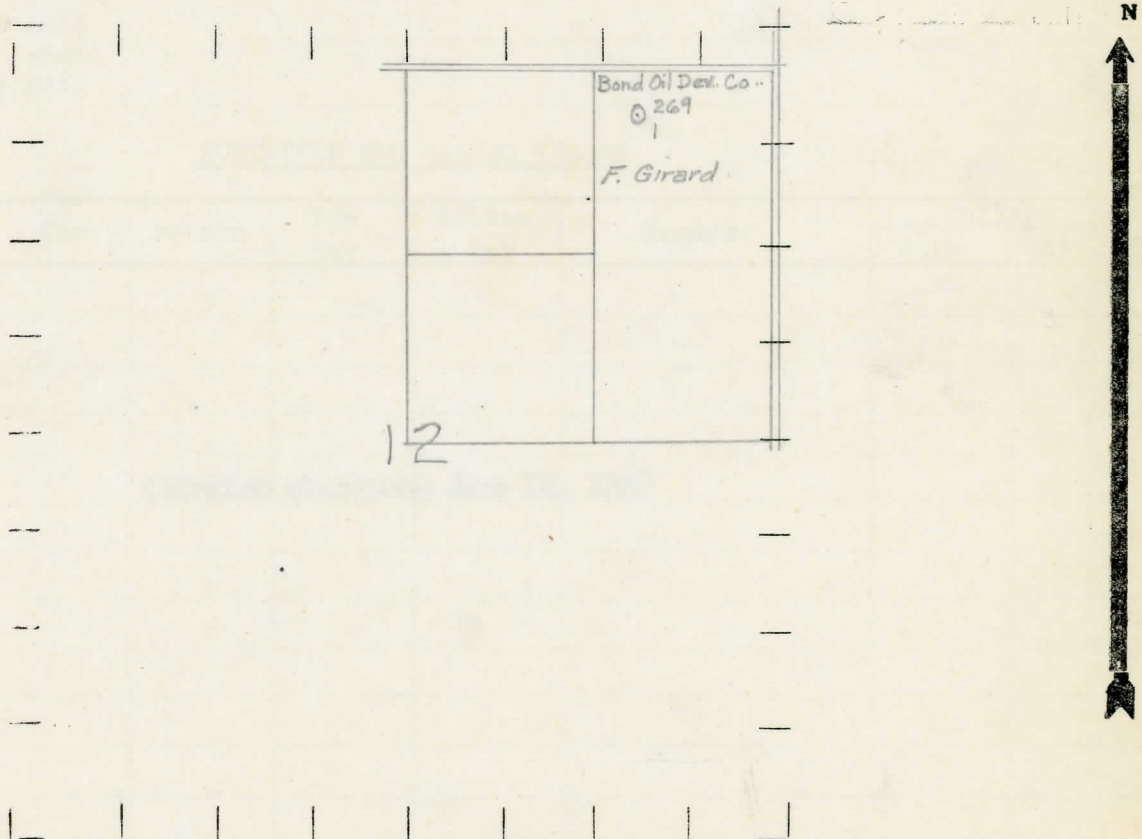

REMARKS:

SIGNED

R. L. Yager
Superintendent or Foreman.

