



Western Michigan University
ScholarWorks at WMU

Legacy Scout Tickets from Pure Oil Company

8-20-2021

MGRRE_PureOilScoutTickets_BAUM MIKE_1_21051041730000

MGRRE

Western Michigan University

Follow this and additional works at: <https://scholarworks.wmich.edu/pure>



Part of the Geology Commons

WMU ScholarWorks Citation

MGRRE, "MGRRE_PureOilScoutTickets_BAUM MIKE_1_21051041730000" (2021). *Legacy Scout Tickets from Pure Oil Company*. 1944.

<https://scholarworks.wmich.edu/pure/1944>

This Document is brought to you for free and open access via ScholarWorks at WMU. It has been accepted for inclusion in Legacy Scout Tickets from Pure Oil Company by an authorized administrator of ScholarWorks at WMU. See the National Digital Catalogue - Science Base Catalogue for more collections submitted by MGRRE.



MGRRE_PureOilScoutTickets_BAUM MIKE_1_21051041730000

API 21051041730000

Permit Number 4173

Lease Name BAUM MIKE

Well Number 1

County Gladwin

Township 18N

Range 1W

Section 3

2021 DEQ or Pure co_name ORYX ENERGY CO

Pure Number 270

Latitude 43.97798

Longitude -84.42265

THE PURE OIL COMPANY

LOCATION REPORT

DATE June 3, 1937

No. 270

STATE Michigan COUNTY Gladwin DIST. Buckeye TWP. Buckeye SEC. 3 TOWN 18 N RANGE 1 W.

WELL No. 1 (SERIAL No. 270) FARM Mike Baum ACRES

NAME OF STREAM OR WATERS QUADRANGLE SE-NW-SW SE NW SW

OPERATOR The Sun Oil Company Map Buckeye Township, Gladwin County

Feet from North Line of Farm 320 330 East

330 330 South West

Feet from North Line of Section 990 990 East

990 990 South West

- LEGEND: O LOCATION, DRY HOLE, RIG, DRILLING, GAS WELL, OIL WELL, SMALL OIL WELL, DRY SHOWING OIL, DRY SHOWING GAS, ABANDONED LOCATION, ABANDONED GAS WELL, ABANDONED OIL WELL

NOTE: Below make tracing from map, (when no map is obtainable make sketch) showing farm, center of section, this location with measurements and also wells, dry holes, or other locations in the vicinity of this location.

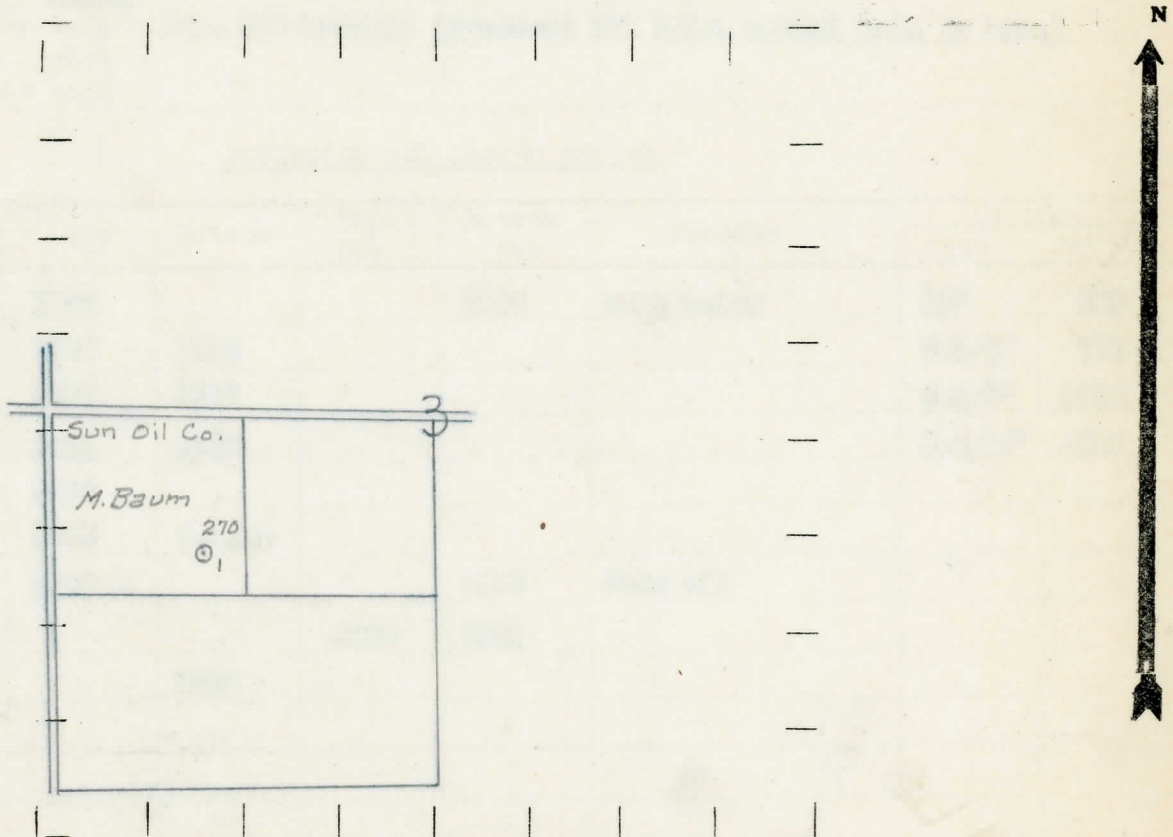

REMARKS:

SIGNED

R. L. Hagen Superintendent or Foreman.

Superintendent or Foreman.

COMPLETION RECORD OF WELLS DRILLED BY OTHER OPERATORS

Michigan Producing Division

Date August 5, 1937 No. 270
 State Michigan County Gladwin Dist. Twp. Buckeye Sec. 3 Twp. 18 N Rge. 1 W
 Well No. 1 (Serial No.) (County No.) 270 Farm Mike Baum Acres _____
 Operator Sun Oil Company Information secured ~~from~~ Scouting Department by _____
 Date well started 6-11-37 Date well completed 7-29-37 Elevation 766.8

PRODUCTION RECORD

1st 24 hours natural Filled up 2000 ft.
 2nd 24 hours natural _____
 Date of shot _____ No. of quarts _____ From _____ to _____ From _____ to _____
 Date of acid 8-2-37 No. of gallons 2000
 1st 24 hours after acid shot Est. 550 barrels (Produced 231 bbls. actual 1st. 12 hrs.)
 2nd 24 hours after acid _____

FORMATION AND CASING RECORD

| Formation | Top | Bottom | Top Pay | Bottom Pay | Remarks | Casing | |
|-------------|------|--------|---------|------------|------------|---------|------|
| | | | | | | Size | Set |
| Marshall | 1056 | | | 1056 | Salt water | 10" | 225 |
| Red Rock | 1166 | 1226 | | | | 8-1/4" | 785 |
| Sunbury | 2272 | 2312 | | | | 6-5/8" | 1250 |
| Berea | 2312 | 2360 | | | | 5-3/16" | 3600 |
| Antrim | 2390 | | | | | | |
| Traverse | 2646 | C.T.M. | | | | | |
| Dundee | 3595 | | | 3658 | Show oil | | |
| | | | 3666 | 3671 | | | |
| Total Depth | | 3690 | | | | | |

Remarks _____

Signed D. C. Shackelford