



Western Michigan University
ScholarWorks at WMU

Legacy Scout Tickets from Pure Oil Company

8-20-2021

MGRRE_PureOilScoutTickets_BAUM MIKE_2_21051042090000

MGRRE

Western Michigan University

Follow this and additional works at: <https://scholarworks.wmich.edu/pure>



Part of the Geology Commons

WMU ScholarWorks Citation

MGRRE, "MGRRE_PureOilScoutTickets_BAUM MIKE_2_21051042090000" (2021). *Legacy Scout Tickets from Pure Oil Company*. 1967.

<https://scholarworks.wmich.edu/pure/1967>

This Document is brought to you for free and open access via ScholarWorks at WMU. It has been accepted for inclusion in Legacy Scout Tickets from Pure Oil Company by an authorized administrator of ScholarWorks at WMU. See the National Digital Catalogue - Science Base Catalogue for more collections submitted by MGRRE.



MGRRE_PureOilScoutTickets_BAUM MIKE_2_21051042090000

API 21051042090000

Permit Number 4209

Lease Name BAUM MIKE

Well Number 2

County Gladwin

Township 18N

Range 1W

Section 3

2021 DEQ or Pure co_name ORYX ENERGY CO

Pure Number 293

Latitude 43.97804

Longitude -84.42516

THE PURE OIL COMPANY

DATE June 3, 1937

LOCATION REPORT

No. 293

STATE Michigan COUNTY Gladwin DIST. Buckeye TWP. Buckeye SEC. 3 TOWN 18 N RANGE 1 W

WELL No. 2 2 (SERIAL No. 293) FARM Mike Baum ACRES

NAME OF STREAM OR WATERS QUADRANGLE SW-NW-SW

OPERATOR The Sun Oil Company Map Buckeye Township, Gladwin County

Sun Oil Co.
Feet from North Line of Farm

330 330 " " East " " "

330 330 " " South " " "

330 330 " " West " " "

990 990 Feet from North Line of Section

" " East " " "

" " South " " "

330 330 " " West " " "

Low

LEGEND

- LOCATION
- ① RIG
- ⊕ DRILLING
- ☀ GAS WELL
- OIL WELL
- ⬮ SMALL OIL WELL
- ⊖ DRY HOLE
- ⊕ DRY SHOWING OIL
- ⊖ DRY SHOWING GAS
- ⊖ ABANDONED LOCATION
- ☀ ABANDONED GAS WELL
- ⬮ ABANDONED OIL WELL

NOTE: Below make tracing from map, (when no map is obtainable make sketch) showing farm, center of section, this location with measurements and also wells, dry holes, or other locations in the vicinity of this location.

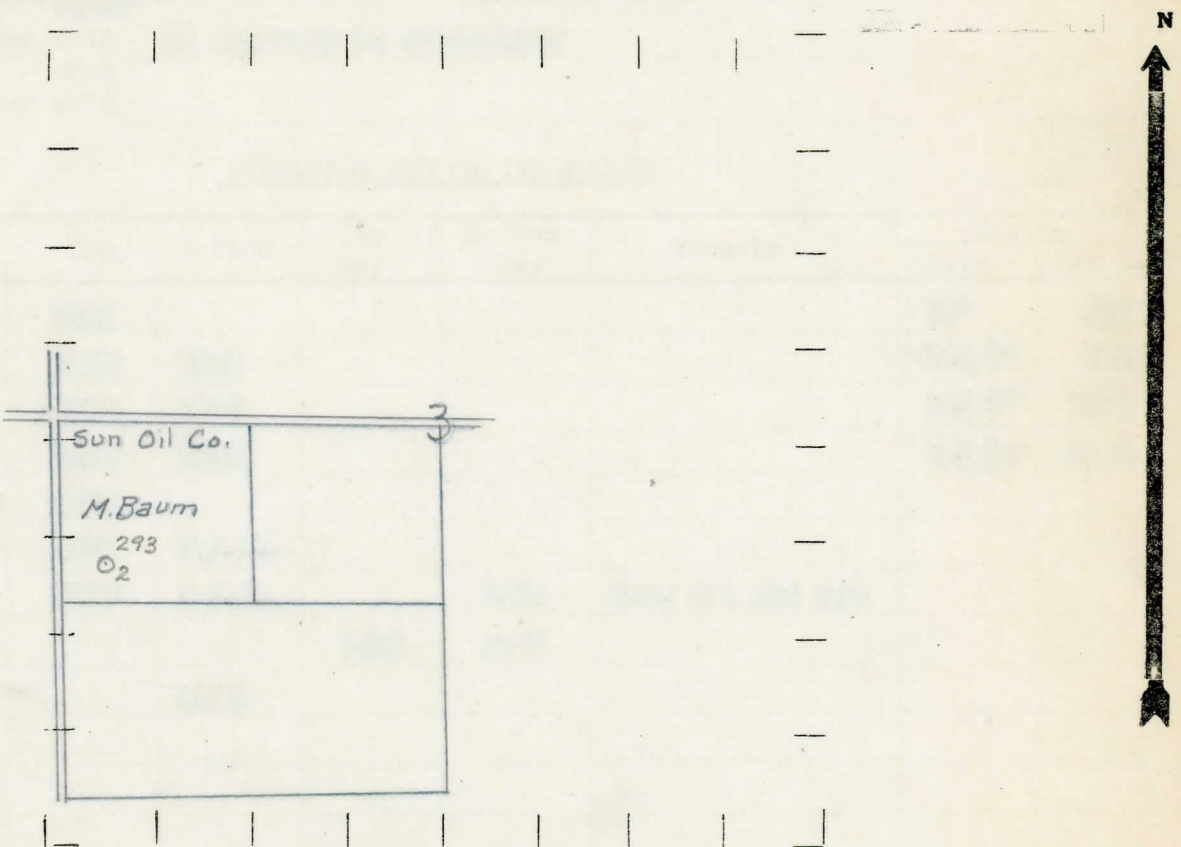

REMARKS:

SIGNED

R. d. Yeager

Superintendent or Foreman.

COMPLETION RECORD OF WELLS DRILLED BY OTHER OPERATORS

Michigan Producing Division

Date September 2, 1937 No. 293
 State Michigan County Gladwin Dist. _____
 Twp. Duckeye Sec. 5 Twp. 18 N Rge. 1 W
 Well No. 2 (Serial No.) _____
 (County No.) 293 Farm Mike Baum Acres _____
 Operator Sun Oil Company Information secured ~~from~~ Scouting Department by _____
 Date well started 7-3-37 Date well completed 8-27-37 Elevation 767.3

PRODUCTION RECORD

1st 24 hours natural 240 Barrels
 2nd 24 hours natural _____
 Date of shot _____ No. of quarts _____ From _____ to _____ From _____ to _____
 Date of acid 8-30-37 No. of gallons 1000
 1st 24 hours after acid No increase in production
 shot _____
 2nd 24 hours after acid _____

FORMATION AND CASING RECORD

Formation	Top	Bottom	Top Pay	Bottom Pay	Remarks	Casing	
						Size	Set At
Marshall	1054					10"	233
Red Rock	1180	1227				8-1/4"	305
Sunbury	2270	2295				6-5/8"	1255
Berea	2295	2353				5-3/16"	3530
Antrim	2376						
Traverse	2341	S.L.M.					
Dundee	3576	S.L.M.		3639	Show oil and gas		
			3639	3646			
Total Depth		3676					

Remarks _____

Signed D. C. Shackelford