



Western Michigan University
ScholarWorks at WMU

Legacy Scout Tickets from Pure Oil Company

8-20-2021

MGRRE_PureOilScoutTickets_Campbell _1_na

MGRRE

Western Michigan University

Follow this and additional works at: <https://scholarworks.wmich.edu/pure>



Part of the Geology Commons

WMU ScholarWorks Citation

MGRRE, "MGRRE_PureOilScoutTickets_Campbell _1_na" (2021). *Legacy Scout Tickets from Pure Oil Company*. 1970.

<https://scholarworks.wmich.edu/pure/1970>

This Document is brought to you for free and open access via ScholarWorks at WMU. It has been accepted for inclusion in Legacy Scout Tickets from Pure Oil Company by an authorized administrator of ScholarWorks at WMU. See the National Digital Catalogue - Science Base Catalogue for more collections submitted by MGRRE.



MGRRE_PureOilScoutTickets_Campbell _1_na

API na

Permit Number na

Lease Name Campbell

Well Number 1

County Gladwin

Township 18N

Range 1W

Section 1

2021 DEQ or Pure co_name J V Wicklund Dev Co

Pure Number 296

Latitude 43.9801543

Longitude -84.3762306

The Pure Oil Company
THE PURE OIL COMPANY

DATE June 10, 1937

LOCATION REPORT

No. 296

STATE Michigan COUNTY Gladwin DIST. Buckeye TWP. Buckeye SEC. 1 TOWN 18 N RANGE 1 W
WELL No. 1 (SERIAL No. 296) FARM _____ ACRES _____
PREC. Campbell

NAME OF STREAM OR WATERS _____ QUADRANGLE SW-SW-SW, SW SW SW

OPERATOR J. V. Wicklund Development Company Map Buckeye Township, Gladwin County
J.V. Wicklund Dev Co. Buckeye-Glad

_____ Feet from North Line of Farm
" " East " " "
330 330 " " South " " "
330 330 " " West " " "

_____ Feet from North Line of Section
" " East " " "
330 330 " " South " " "
330 330 " " West " " "

LEGEND

- LOCATION
- ⊕ DRILLING
- ☀ GAS WELL
- OIL WELL
- ⊙ SMALL OIL WELL
- ⊖ DRY HOLE
- ⊕ DRY SHOWING OIL
- ⊖ DRY SHOWING GAS
- ⊖ ABANDONED LOCATION
- ☀ ABANDONED GAS WELL
- ⊖ ABANDONED OIL WELL

NOTE: Below make tracing from map, (when no map is obtainable make sketch) showing farm, center of section, this location with measurements and also wells, dry holes, or other locations in the vicinity of this location.

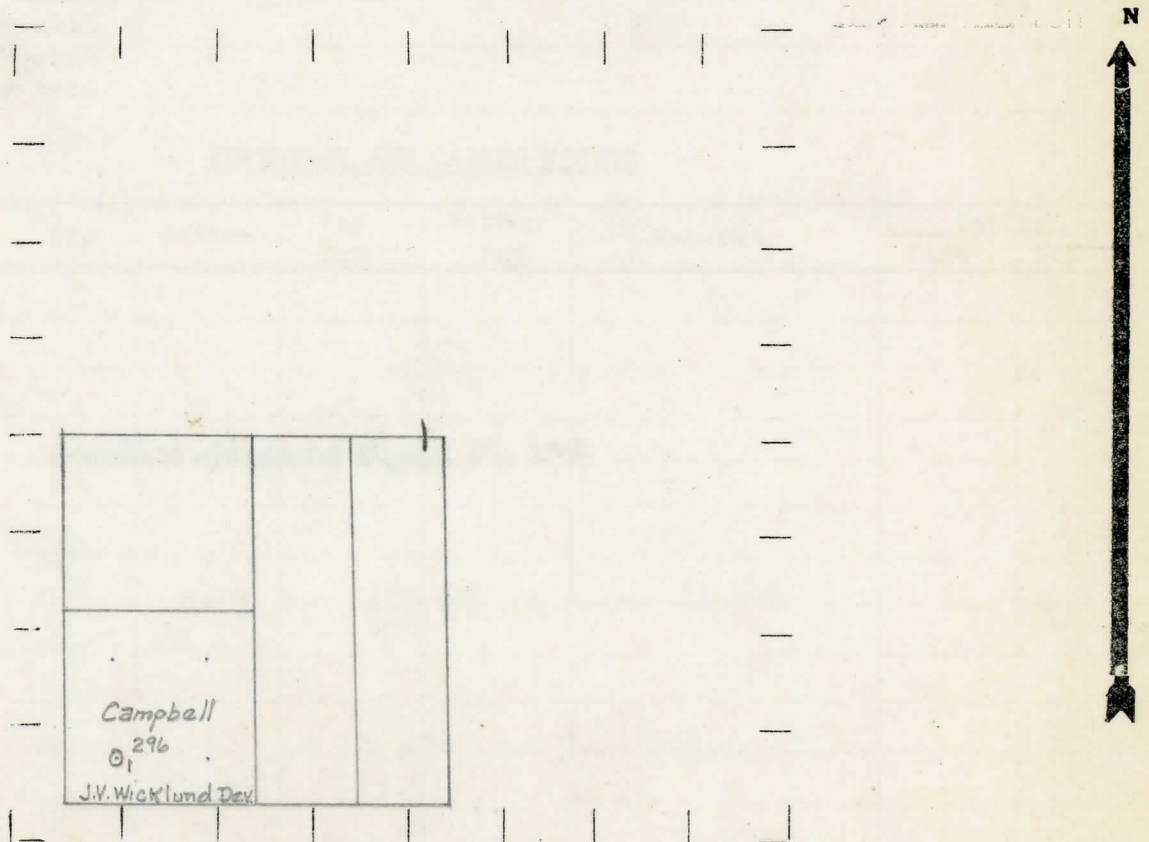

REMARKS: _____

SIGNED

R. L. Yeager

Superintendent or Foreman. \$

COMPLETION RECORD OF WELLS DRILLED BY OTHER OPERATORS

Michigan Producing Division

Date August 19, 1937 No. 296
 State Michigan County Gladwin Dist. Duckeye
 (Serial No.) Twp. 18 N Sec. 1 Rge. 1 W
 Well No. -1- (County No.) 296 Farm Campbell Acres
 Operator J. V. Wicklund Development Co. Information secured from Scouting Department
 Date well started Not started Date well completed Not completed Elevation

PRODUCTION RECORD

1st 24 hours natural Location abandoned
 2nd 24 hours natural
 Date of shot No. of quarts From to From to
 Date of acid No. of gallons
 shot
 1st 24 hours after acid shot
 2nd 24 hours after acid shot

FORMATION AND CASING RECORD

Formation	Top	Bottom	Top Pay	Bottom Pay	Remarks	Casing	
						Size	Set
<u>Location abandoned August 18, 1937</u>							

Remarks

Signed D. C. Shackelford