



Western Michigan University
ScholarWorks at WMU

Legacy Scout Tickets from Pure Oil Company

8-20-2021

MGRRE_PureOilScoutTickets_Campbell _2_na

MGRRE

Western Michigan University

Follow this and additional works at: <https://scholarworks.wmich.edu/pure>



Part of the Geology Commons

WMU ScholarWorks Citation

MGRRE, "MGRRE_PureOilScoutTickets_Campbell _2_na" (2021). *Legacy Scout Tickets from Pure Oil Company*. 1971.

<https://scholarworks.wmich.edu/pure/1971>

This Document is brought to you for free and open access via ScholarWorks at WMU. It has been accepted for inclusion in Legacy Scout Tickets from Pure Oil Company by an authorized administrator of ScholarWorks at WMU. See the National Digital Catalogue - Science Base Catalogue for more collections submitted by MGRRE.



MGRRE_PureOilScoutTickets_Campbell _2_na

API na

Permit Number na

Lease Name Campbell

Well Number 2

County Gladwin

Township 18N

Range 1W

Section 1

2021 DEQ or Pure co_name J V Wicklund Dev Co

Pure Number 297

Latitude 43.9801543

Longitude -84.3762306

The Pure Oil Company
THE PURE OIL COMPANY

COMPLETION RECORD OF OTHER OPERATORS

DATE June 10, 1937

LOCATION REPORT

No. 297

STATE Michigan COUNTY Gladwin DIST. Buckeye TWP. Buckeye SEC. 1 TOWN 18 N RANGE 1 W

WELL No. 2 2 (SERIAL No. 297) FARM Campbell ACRES

NAME OF STREAM OR WATERS QUADRANGLE SE-SW-SW SE SW SW

OPERATOR J. V. Wicklund Development Company Map Buckeye Township, Gladwin County
J.V. Wicklund Dev. Co. Buckeye-Glad.

Feet from North Line of Farm

330 330 " " East " " "

330 330 " " South " " "

" " West " " "

Feet from North Line of Section

" " East " " "

330 330 " " South " " "

990 990 " " West " " "

LEGEND

- LOCATION
- ⊕ RIG
- ⊕ DRILLING
- ☀ GAS WELL
- OIL WELL
- ⬮ SMALL OIL WELL
- ⊙ DRY HOLE
- ⬮ DRY SHOWING OIL
- ⊙ DRY SHOWING GAS
- ⊙ ABANDONED LOCATION
- ☀ ABANDONED GAS WELL
- ⬮ ABANDONED OIL WELL

NOTE: Below make tracing from map, (when no map is obtainable make sketch) showing farm, center of section, this location with measurements and also wells, dry holes, or other locations in the vicinity of this location.

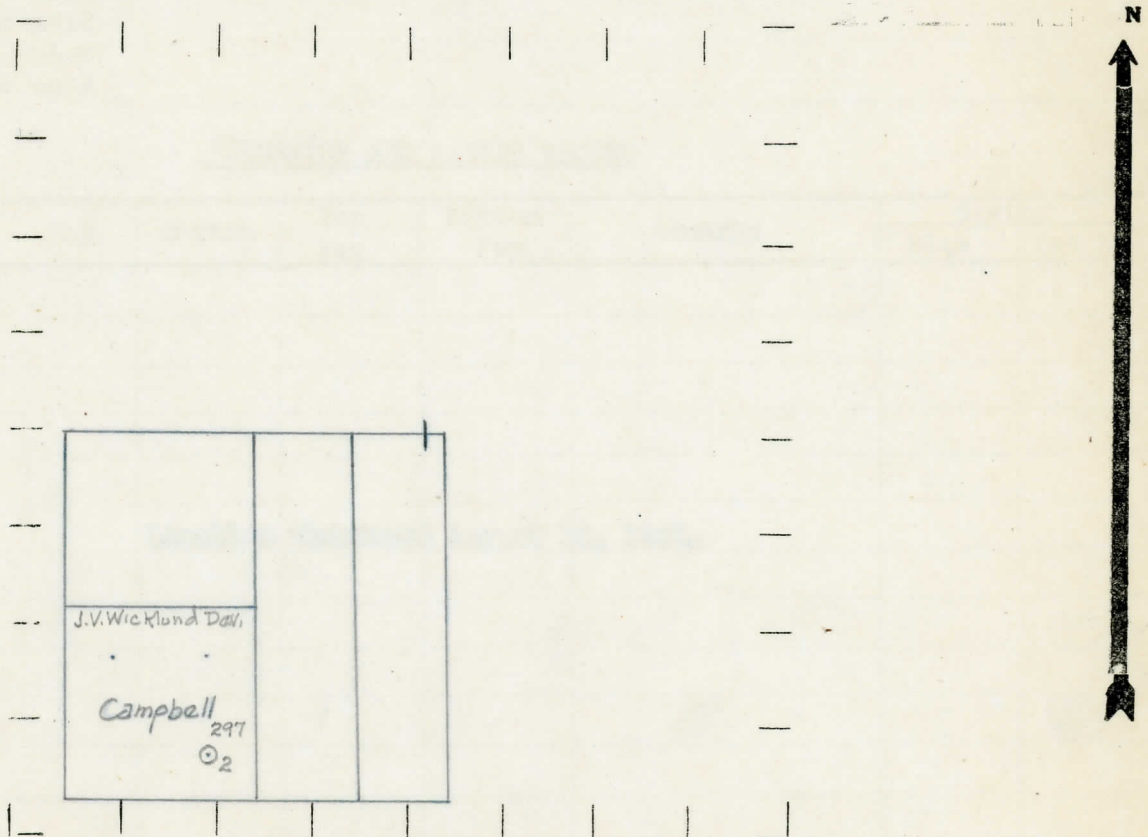

REMARKS:

SIGNED

R. L. Yeager
Superintendent or Foreman.

THE PUMP OUT SYSTEM
COMPLETION RECORD OF WELLS DRILLED BY OTHER OPERATORS

37

Michigan Producing Division

Date August 19, 1937 No. 297
 State Michigan County Gladwin Dist. _____
 Twp. Buckeye Sec. 1 Twp. 18 N Rge. 1 W
 Well No. 2 (Serial No.) _____
 (County No.) 297 Farm Campbell Acres _____
 Operator J. V. Wicklund Development Co. Information secured from Scouting Department by _____
 Date well started Not started Date well completed Not completed Elevation _____

PRODUCTION RECORD

1st 24 hours natural Location abandoned
 2nd 24 hours natural _____
 Date of shot _____ No. of quarts _____ From _____ to _____ From _____ to _____
 Date of acid _____ No. of gallons _____
 shot _____
 1st 24 hours after acid _____
 shot _____
 2nd 24 hours after acid _____

FORMATION AND CASING RECORD

Formation	Top	Bottom	Top Pay	Bottom Pay	Remarks	Casing	
						Size	Set At
<u>Location abandoned August 18, 1937.</u>							

Remarks _____

Signed D. C. Shackelford