



Western Michigan University
ScholarWorks at WMU

Legacy Scout Tickets from Pure Oil Company

8-20-2021

MGRRE_PureOilScoutTickets_STEEL, W. W._1_21051042370000

MGRRE

Western Michigan University

Follow this and additional works at: <https://scholarworks.wmich.edu/pure>



Part of the Geology Commons

WMU ScholarWorks Citation

MGRRE, "MGRRE_PureOilScoutTickets_STEEL, W. W._1_21051042370000" (2021). *Legacy Scout Tickets from Pure Oil Company*. 1980.

<https://scholarworks.wmich.edu/pure/1980>

This Document is brought to you for free and open access via ScholarWorks at WMU. It has been accepted for inclusion in Legacy Scout Tickets from Pure Oil Company by an authorized administrator of ScholarWorks at WMU. See the National Digital Catalogue - Science Base Catalogue for more collections submitted by MGRRE.



MGRRE_PureOilScoutTickets_STEEL, W. W._1_21051042370000

API 21051042370000

Permit Number 4237

Lease Name STEEL, W. W.

Well Number 1

County Gladwin

Township 20N

Range 1E

Section 22

2021 DEQ or Pure co_name BELL AND MARKS INC AND UNION OIL AND GAS CO

Pure Number 306

Latitude 44.11868

Longitude -84.33727

THE PURE OIL COMPANY

DATE June 10, 1937

LOCATION REPORT

No. 306

STATE Michigan COUNTY Gladwin DIST. Clement SEC. 22 TOWN 20 N. RANGE 1 E.
 WELL No. 1 (SERIAL No. 306) FARM _____ ACRES _____
 PREC. W. W. Steel

NAME OF STREAM OR WATERS _____ QUADRANGLE NW-NW-SE

OPERATOR H.E. Bell, Monroe Marks & Union Oil & Gas Co. Map Clement Township, Gladwin County
Monroe Marks - H.E. Bell & Union O. Gas Co. Clement - Glad.

330 330 Feet from North Line of Farm
 " " East " " "
 " " South " " "
330 330 " " West " " "
330 330 Feet from North Line of Section
 " " East " " "
 " " South " " "
330 330 " " West 1/4 1/4 "

- LEGEND**
- LOCATION
 - ⊕ RIG
 - ⊕ DRILLING
 - ☀ GAS WELL
 - OIL WELL
 - SMALL OIL WELL
 - ⊙ DRY HOLE
 - DRY SHOWING OIL
 - ☀ DRY SHOWING GAS
 - ⊙ ABANDONED LOCATION
 - ☀ ABANDONED GAS WELL
 - ABANDONED OIL WELL

NOTE: Below make tracing from map, (when no map is obtainable make sketch) showing farm, center of section, this location with measurements and also wells, dry holes, or other locations in the vicinity of this location.

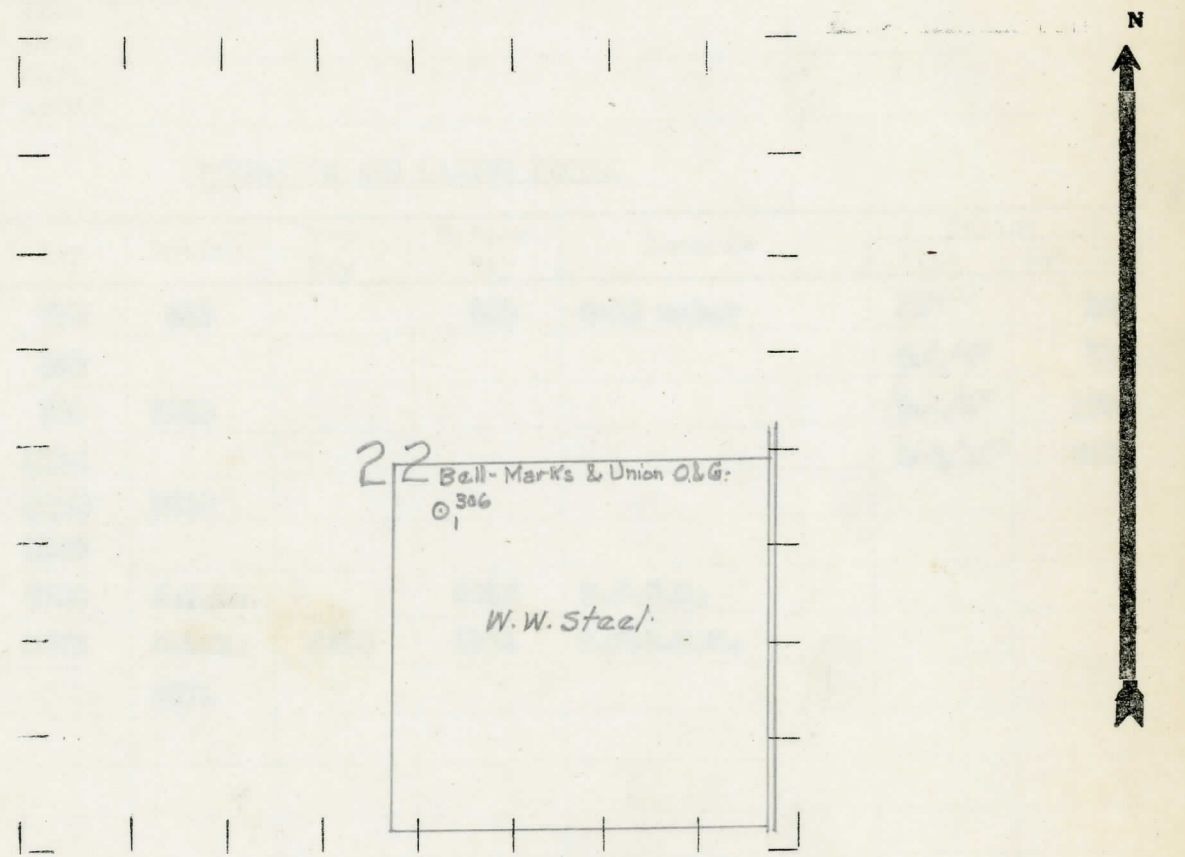

REMARKS: _____

SIGNED R. L. Yeager
 Superintendent or Foreman.

COMPLETION RECORD OF WELLS DRILLED BY OTHER OPERATORS

Michigan Producing Division

Date August 12, 1937 No. 306
 State Michigan County Gladwin Dist. _____
 Twp. Clement Sec. 22 Twp. 20 N Rge. 1 E
 Well No. 1 (Serial No.) _____
 (County No.) 306 Farm W. W. Steel Acres _____
 Operator Bell & Marks, et al Information secured ~~from~~ Scouting Department by _____
 Date well started 6-5-37 Date well completed 8-9-37 Elevation 795.7

PRODUCTION RECORD

1st 24 hours natural Dry Hole
 2nd 24 hours natural _____
 Date of shot _____ No. of quarts _____ From _____ to _____ From _____ to _____
 Date of acid _____ No. of gallons _____
 1st 24 hours after acid shot _____
 2nd 24 hours after acid shot _____

FORMATION AND CASING RECORD

Formation	Top	Bottom	Top Pay	Bottom Pay	Remarks	Casing	
						Size	Set
Stray	790	825		800	Salt water	10"	208
Marshall	890					8-1/4"	716
Red Rock	980	1050				6-5/8"	1081
Sunbury	2126					5-3/16"	5479
Berea	2155	2210					
Antrim	2245						
Traverse	2700	C.T.M.		2825	H.F.S.W.		
Dundee	3476	S.L.M.	3570	3571	H.F.B.S.W.		
Total Depth		3571					

Remarks _____

Signed D. C. Shackelford