



Western Michigan University
ScholarWorks at WMU

Legacy Scout Tickets from Pure Oil Company

8-20-2021

**MGRRE_PureOilScoutTickets_BUSHOMG,
ROBERT_1_21051042910000**

MGRRE
Western Michigan University

Follow this and additional works at: <https://scholarworks.wmich.edu/pure>



Part of the Geology Commons

WMU ScholarWorks Citation

MGRRE, "MGRRE_PureOilScoutTickets_BUSHOMG, ROBERT_1_21051042910000" (2021). *Legacy Scout Tickets from Pure Oil Company*. 2002.
<https://scholarworks.wmich.edu/pure/2002>

This Document is brought to you for free and open access via ScholarWorks at WMU. It has been accepted for inclusion in Legacy Scout Tickets from Pure Oil Company by an authorized administrator of ScholarWorks at WMU. See the National Digital Catalogue - Science Base Catalogue for more collections submitted by MGRRE.



MGRRE_PureOilScoutTickets_BUSHOMG, ROBERT_1_21051042910000

API 21051042910000

Permit Number 4291

Lease Name BUSHOMG, ROBERT

Well Number 1

County Gladwin

Township 18N

Range 1E

Section 16

2021 DEQ or Pure co_name STOVER F C

Pure Number 328

Latitude 43.9655

Longitude -84.35095

THE PURE OIL COMPANY

LOCATION REPORT

No. 328

DATE July 8, 1937

STATE Michigan COUNTY Gladwin DIST. Hay TWP. Hay SEC. 16 TOWN 18 N RANGE 1 E

WELL No. 11 (SERIAL No. 328) FARM Robert Bushong ACRES

NAME OF STREAM OR WATERS QUADRANGLE SW SE NE

OPERATOR F. C. Stover Map Hay Township, Gladwin County

Feet from North Line of Farm

East " " "

330 330 South " " "

330 330 West " " "

Feet from North Line of Section

970 990 East " " "

330 330 South " 1/4 "

West " " "

LEGEND

- LOCATION
- ⊕ RIG
- ⊕ DRILLING
- ☀ GAS WELL
- OIL WELL
- ⊕ SMALL OIL WELL
- ⊕ DRY HOLE
- DRY SHOWING OIL
- ⊕ DRY SHOWING GAS
- ☀ ABANDONED LOCATION
- ☀ ABANDONED GAS WELL
- ABANDONED OIL WELL

NOTE: Below make tracing from map, (when no map is obtainable make sketch) showing farm, center of section, this location with measurements and also wells, dry holes, or other locations in the vicinity of this location.

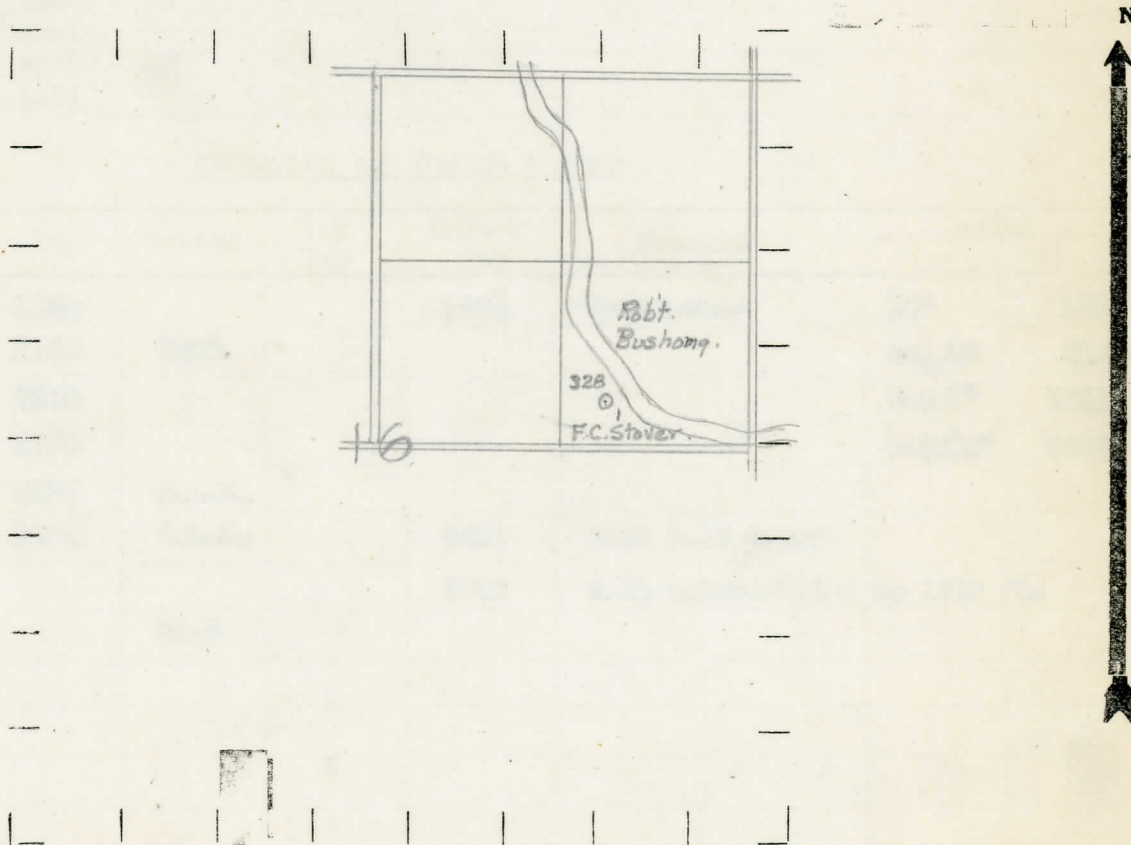

REMARKS:

SIGNED

R. A. Yeager

Superintendent or Foreman.

COMPLETION RECORD OF WELLS DRILLED BY OTHER OPERATORS

Michigan Producing Division

Date September 16, 1937 No. 328
 State Michigan County Gladwin Dist. Hay Sec. 16 Twp. 18 N Rge. 1 E
 Well No. 1 (Serial No.) (County No.) 328 Farm Robert Bushong Acres _____
 Operator F. C. Stover Information secured ~~from~~ by Scouting Department
 Date well started 8-2-37 Date well completed 9-10-37 Elevation 730.7

PRODUCTION RECORD

1st 24 hours natural Dry Hole
 2nd 24 hours natural _____
 Date of shot _____ No. of quarts _____ From _____ to _____ From _____ to _____
 Date of acid _____ No. of gallons _____
 1st 24 hours after acid shot _____
 2nd 24 hours after acid shot _____

FORMATION AND CASING RECORD

Formation	Top	Bottom	Top Pay	Bottom Pay	Remarks	Casing	
						Size	Set At
Marshall	1040			1045	Salt water	10"	186
Red Rock	1166	1208				8-1/4"	810
Berea	2315					6-5/8"	1231
Antrim	2390					5-3/16"	3592
Traverse	2835	S.L.M.					
Dundee	3575	S.L.M.		3656	Show salt water		
				3667	Salt water-filled up 1500 ft.		
Total Depth		3667					

Remarks _____

Signed D. C. Shackelford