



Western Michigan University
ScholarWorks at WMU

Legacy Scout Tickets from Pure Oil Company

8-20-2021

MGRRE_PureOilScoutTickets_DELBRIDGE, D._1_21051043360000

MGRRE

Western Michigan University

Follow this and additional works at: <https://scholarworks.wmich.edu/pure>



Part of the Geology Commons

WMU ScholarWorks Citation

MGRRE, "MGRRE_PureOilScoutTickets_DELBRIDGE, D._1_21051043360000" (2021). *Legacy Scout Tickets from Pure Oil Company*. 2012.

<https://scholarworks.wmich.edu/pure/2012>

This Document is brought to you for free and open access via ScholarWorks at WMU. It has been accepted for inclusion in Legacy Scout Tickets from Pure Oil Company by an authorized administrator of ScholarWorks at WMU. See the National Digital Catalogue - Science Base Catalogue for more collections submitted by MGRRE.



MGRRE_PureOilScoutTickets_DELBRIDGE, D._1_21051043360000

API 21051043360000

Permit Number 4336

Lease Name DELBRIDGE, D.

Well Number 1

County Gladwin

Township 17N

Range 2E

Section 1

2021 DEQ or Pure co_name DIBBLE BROTHERS

Pure Number 338

Latitude 43.91133

Longitude -84.17511

COMPLETION RECORD OF WELLS DRILLED BY OTHER OPERATORS

The Pure Oil Company
THE PURE OIL COMPANY

DATE July 22, 1937

LOCATION REPORT

No. 338

STATE Michigan COUNTY Gladwin DIST. TWP. Bentley SEC. 1 TOWN 17 N RANGE 2 E

WELL No. 11 (SERIAL No. 338) FARM D. Delbridge ACRES

NAME OF STREAM OR WATERS QUADRANGLE NW-NW-NE, NW-NW-NE

OPERATOR Dibble Brothers Map Bentley Township, Gladwin County

32320 Feet from North Line of Farm

East " " "

South " " "

22820 West " " "

32320 Feet from North Line of Section

East " " "

South " " "

22820 West " 1/4 "

140 = Sp 7-13-37

- LEGEND
- LOCATION
 - ⊕ RIG
 - ⊕ DRILLING
 - ☀ GAS WELL
 - OIL WELL
 - ⊕ SMALL OIL WELL
 - ⊖ DRY HOLE
 - ⊕ DRY SHOWING OIL
 - ⊖ DRY SHOWING GAS
 - ⊖ ABANDONED LOCATION
 - ☀ ABANDONED GAS WELL
 - ⊖ ABANDONED OIL WELL

NOTE: Below make tracing from map, (when no map is obtainable make sketch) showing farm, center of section, this location with measurements and also wells, dry holes, or other locations in the vicinity of this location.

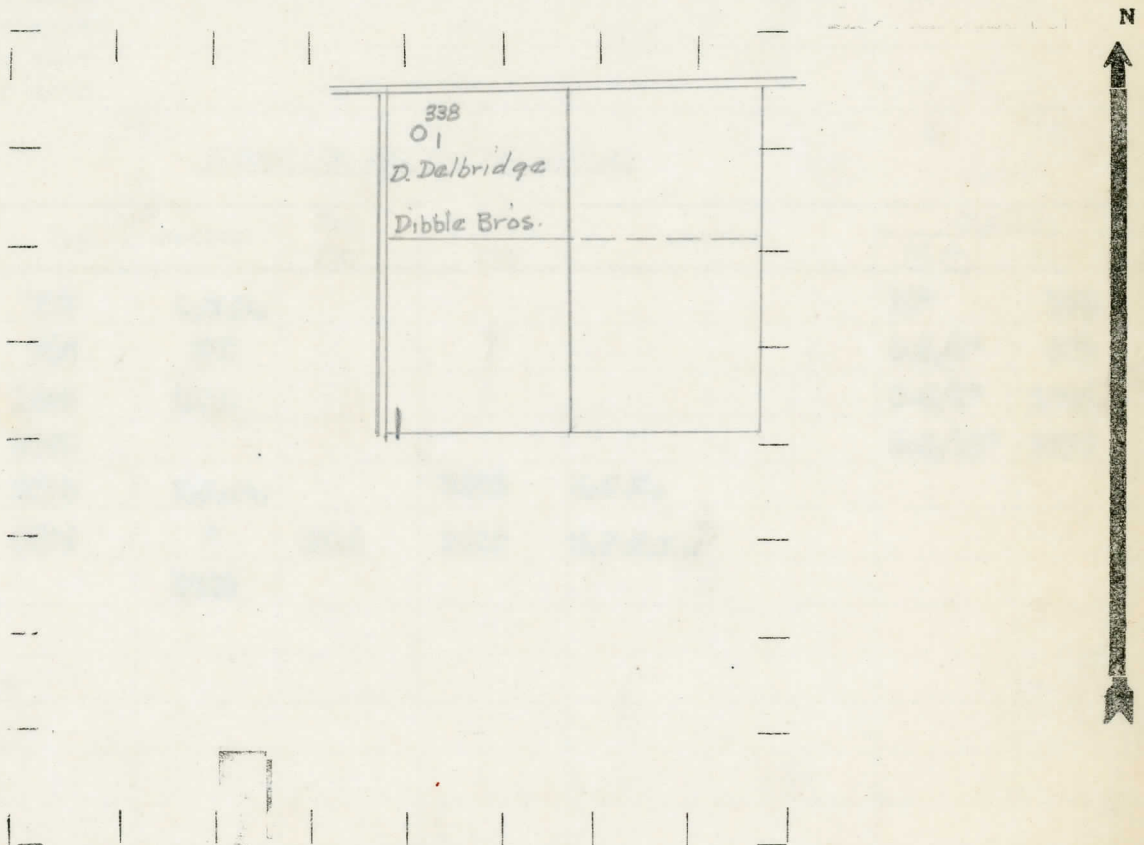

REMARKS:

SIGNED

Superintendent or Foreman.

Michigan Producing Division

Date **February 10, 1938** No. **338**
 State **Michigan** County **Gladwin** Dist. _____
 Twp. **Bentley** Sec. **1** Twp. **17 N** Rge. **2 E**
 Well No. **1** (Serial No.) _____
 (County No.) **338** Farm **D. Delbridge** Acres _____
 Operator **Dibble Brothers** Information secured ~~from~~ **Scouting Department** by _____
 Date well started **7-13-37** Date well completed **2-2-38** Elevation **748.5**

PRODUCTION RECORD

1st 24 hours natural **Dry Hole**
 2nd 24 hours natural _____
 Date of shot _____ No. of quarts _____ From _____ to _____ From _____ to _____
 Date of acid _____ No. of gallons _____
 shot _____
 1st 24 hours after acid _____
 shot _____
 2nd 24 hours after acid _____

FORMATION AND CASING RECORD

| Formation | Top | Bottom | Top Pay | Bottom Pay | Remarks | Casing | |
|--------------------|-------------|---------------|-------------|-------------|-----------------|----------------|-------------|
| | | | | | | Size | Set At |
| Marshall | 823 | C.T.M. | | | | 10" | 156 |
| Red Rock | 936 | 989 | | | | 8-1/4" | 450 |
| Sunbury | 1985 | 2015 | | | | 6-5/8" | 1046 |
| Antrim | 2090 | | | | | 5-3/16" | 3339 |
| Traverse | 2575 | S.L.M. | | 2580 | H.F.W. | | |
| Dundee | 3334 | " | 3516 | 3520 | H.F.S.M. | | |
| Total Depth | | 3520 | | | | | |
| | | | | | | | |
| | | | | | | | |
| | | | | | | | |
| | | | | | | | |
| | | | | | | | |
| | | | | | | | |
| | | | | | | | |
| | | | | | | | |

Remarks _____

Signed **D. C. Shackelford**