



Western Michigan University  
ScholarWorks at WMU

---

Legacy Scout Tickets from Pure Oil Company

---

8-20-2021

**MGRRE\_PureOilScoutTickets\_CARD, CLAUDE  
S\_2\_21051043390000**

MGRRE  
*Western Michigan University*

Follow this and additional works at: <https://scholarworks.wmich.edu/pure>



Part of the Geology Commons

---

#### **WMU ScholarWorks Citation**

MGRRE, "MGRRE\_PureOilScoutTickets\_CARD, CLAUDE S\_2\_21051043390000" (2021). *Legacy Scout Tickets from Pure Oil Company*. 2015.  
<https://scholarworks.wmich.edu/pure/2015>

This Document is brought to you for free and open access via ScholarWorks at WMU. It has been accepted for inclusion in Legacy Scout Tickets from Pure Oil Company by an authorized administrator of ScholarWorks at WMU. See the National Digital Catalogue - Science Base Catalogue for more collections submitted by MGRRE.



---

**MGRRE\_PureOilScoutTickets\_CARD, CLAUDE S\_2\_21051043390000**

API 21051043390000

Permit Number 4339

Lease Name CARD, CLAUDE S

Well Number 2

County Gladwin

Township 18N

Range 1W

Section 10

2021 DEQ or Pure co\_name ORYX ENERGY CO

Pure Number 341

Latitude 43.96706

Longitude -84.42018

The Pure Oil Company  
THE PURE OIL COMPANY

DATE July 22, 1937

LOCATION REPORT

No. 341

STATE Michigan COUNTY Gladwin DIST. Buckeye TWP. Buckeye SEC. 10 TOWN. 18 N RANGE 1 W

WELL No. 2 (SERIAL No. 341) FARM Claude S. Card ACRES

NAME OF STREAM OR WATERS QUADRANGLE SW-SE-NW  
SW SE NW

OPERATOR Sun Oil Company Map Buckeye Township, Gladwin County

Sun Oil Co  
Feet from North Line of Farm

330330 " " East " " "

330330 " " South " " "

" " West " " "

Feet from North Line of Section

99090 " " East " 1/4 "

330330 " " South " 1/4 "

" " West " " "

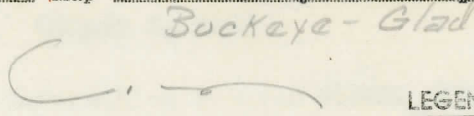

LEGEND

- LOCATION
- ⊙ RIG
- ⊕ DRILLING
- ☀ GAS WELL
- OIL WELL
- ⊙ SMALL OIL WELL
- ⊙ DRY HOLE
- ⊙ DRY SHOWING OIL
- ⊙ DRY SHOWING GAS
- ⊙ ABANDONED LOCATION
- ⊙ ABANDONED GAS WELL
- ⊙ ABANDONED OIL WELL

NOTE: Below make tracing from map, (when no map is obtainable make sketch) showing farm, center of section, this location with measurements and also wells, dry holes, or other locations in the vicinity of this location.

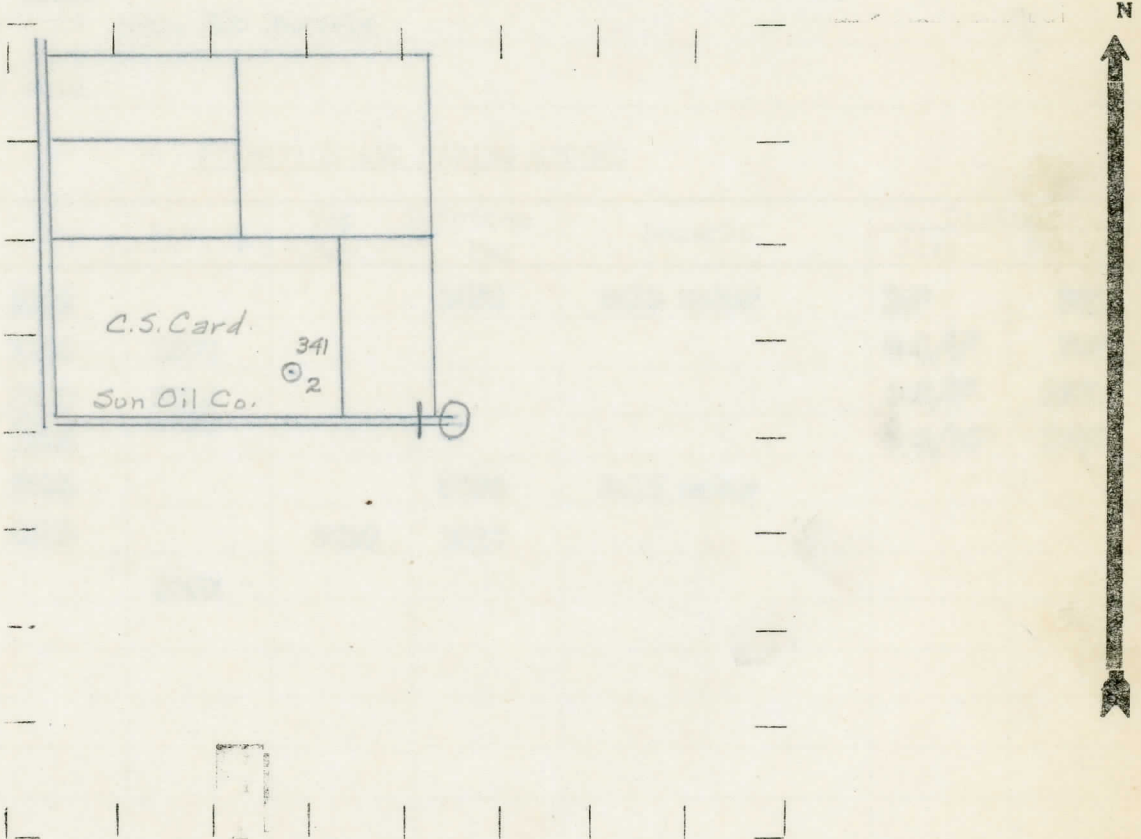

REMARKS:

SIGNED

Superintendent or Foreman.

COMPLETION RECORD OF WELLS DRILLED BY OTHER OPERATORS

Michigan Producing Division

Date October 7, 1937 No. 341  
 State Michigan County Gladwin Dist. Buckeye Twp. 10 Sec. 10 Twp. 18 N Rge. 1 W  
 Well No. 2 (Serial No.) (County No.) 341 Farm Claude S. Card Acres \_\_\_\_\_  
 Operator Sun Oil Company Information secured ~~from~~ Scouting Department by \_\_\_\_\_  
 Date well started 8-9-37 Date well completed 9-29-37 Elevation 759.9

PRODUCTION RECORD

1st 24 hours natural 113 Barrels  
 2nd 24 hours natural \_\_\_\_\_  
 Date of shot \_\_\_\_\_ No. of quarts \_\_\_\_\_ From \_\_\_\_\_ to \_\_\_\_\_ From \_\_\_\_\_ to \_\_\_\_\_  
 Date of acid 10-4-37 No. of gallons 1000  
 1st 24 hours after acid Est. 900 Barrels  
 shot \_\_\_\_\_  
 2nd 24 hours after acid \_\_\_\_\_

FORMATION AND CASING RECORD

Formation	Top	Bottom	Top Pay	Bottom Pay	Remarks	Casing	
						Size	Set At
Marshall	1026			1026	Salt water	10"	368
Red Rock	1150	1207				8-1/4"	785
Sunbury	2240	2270				6-5/8"	1250
Deree	2270	2330					
Antrim	2350					5-3/16"	3568
Traverse	2815			3005	Salt water		
Dundee	3550		3610	3618			
Total Depth		3650					

Remarks \_\_\_\_\_  
 \_\_\_\_\_  
 \_\_\_\_\_

Signed D. C. Shackelford