



Western Michigan University
ScholarWorks at WMU

Legacy Scout Tickets from Pure Oil Company

8-20-2021

MGRRE_PureOilScoutTickets_NUNN, R._1_21051044050000

MGRRE

Western Michigan University

Follow this and additional works at: <https://scholarworks.wmich.edu/pure>

 Part of the Geology Commons

WMU ScholarWorks Citation

MGRRE, "MGRRE_PureOilScoutTickets_NUNN, R._1_21051044050000" (2021). *Legacy Scout Tickets from Pure Oil Company*. 2046.

<https://scholarworks.wmich.edu/pure/2046>

This Document is brought to you for free and open access via ScholarWorks at WMU. It has been accepted for inclusion in Legacy Scout Tickets from Pure Oil Company by an authorized administrator of ScholarWorks at WMU. See the National Digital Catalogue - Science Base Catalogue for more collections submitted by MGRRE.



MGRRE_PureOilScoutTickets_NUNN, R._1_21051044050000

API 21051044050000

Permit Number 4405

Lease Name NUNN, R.

Well Number 1

County Gladwin

Township 17N

Range 2W

Section 18

2021 DEQ or Pure co_name MAMMOTH PRODUCING AND REFINING CORP

Pure Number 372

Latitude 43.87206

Longitude -84.59846

The Pure Oil Company
THE PURE OIL COMPANY

DATE August 12, 1937

LOCATION REPORT

No. 372

STATE Michigan COUNTY Gladwin DIST. Beaverston TWP. Beaverston SEC. 18 TOWN 17 N RANGE 2 W
WELL No. 1 (SERIAL No. 372) FARM R. Nunn ACRES

NAME OF STREAM OR WATERS QUADRANGLE NW-NE-NW
NW NE NW

OPERATOR Mammoth Producing & Refining Corp. Map Beaverston Township, Gladwin County
300 300 Mammoth Prod & Ref. Corp. Beaverston - Glad.

300 300 Feet from North Line of Farm

" " East " " "

" " South " " "

300 300 " " West " " "

300 300 Feet from North Line of Section

690 690 " " East " 1/4 "

" " South " " "

" " West " " "

Sp 8-11-37

LEGEND

- LOCATION
- ⊕ RIG
- ⊕ DRILLING
- ☀ GAS WELL
- OIL WELL
- ⊕ SMALL OIL WELL
- ⊕ DRY HOLE
- ⊕ DRY SHOWING OIL
- ☀ DRY SHOWING GAS
- ⊕ ABANDONED LOCATION
- ☀ ABANDONED GAS WELL
- ⊕ ABANDONED OIL WELL

NOTE: Below make tracing from map, (when no map is obtainable make sketch) showing farm, center of section, this location with measurements and also wells, dry holes, or other locations in the vicinity of this location.

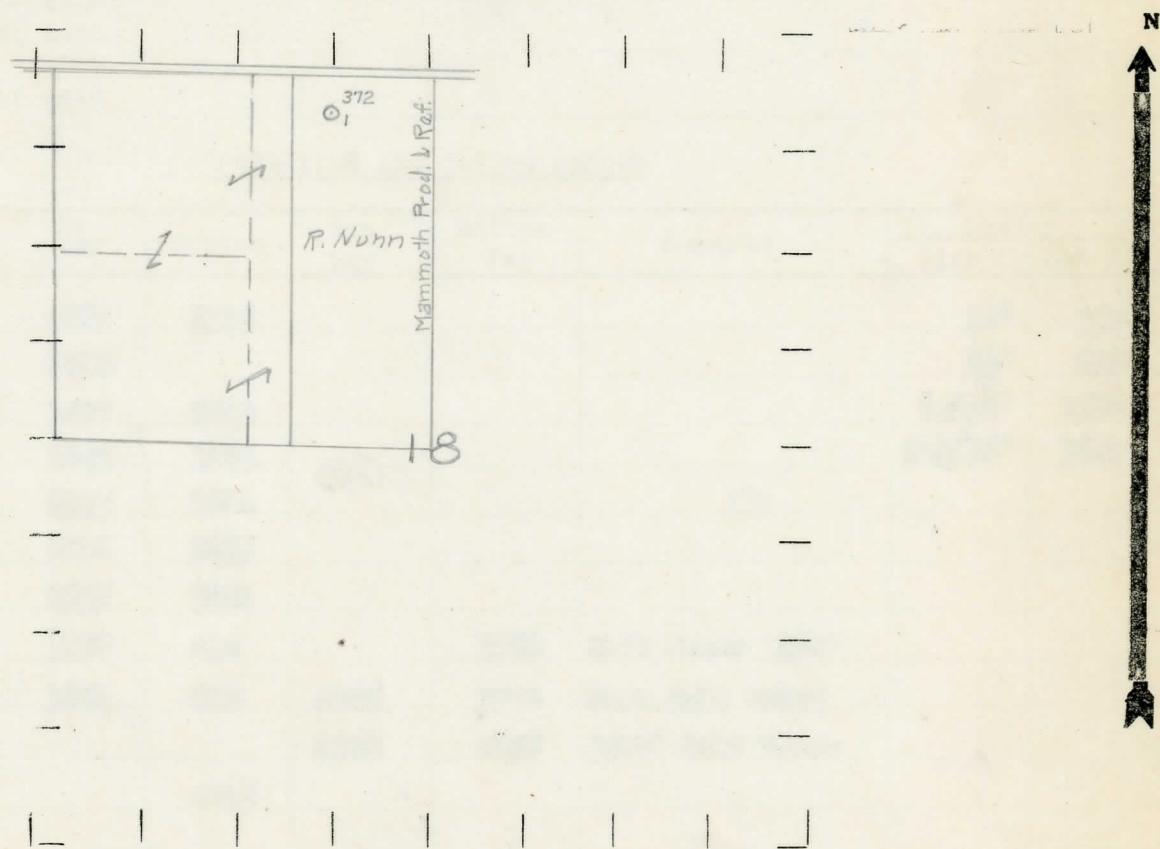

REMARKS:

SIGNED R. L. Yeager
Superintendent or Foreman.

COMPLETION RECORD OF WELLS DRILLED BY OTHER OPERATORS

Michigan Producing Division

Date September 30, 1937 No. 372
 State Mich. County Gladwin Dist. Beaverton Twp. 18 Sec. 18 Twp. 17N Rge. 2W
 Well No. 1 (Serial No.) 372 (County No.) 372 Farm R. Hum Acres
 Operator Mammoth Prod. & Refng. Corp. Information secured from Scouting Dept. by
 Date well started 8-11-37 Date well completed 9-25-37 Elevation 770.8'

PRODUCTION RECORD

1st 24 hours natural Dry Hole
 2nd 24 hours natural
 Date of shot No. of quarts From to From to
 Date of acid No. of gallons
 1st 24 hours after acid shot
 2nd 24 hours after acid shot

FORMATION AND CASING RECORD

Formation	Top	Bottom	Top Pay	Bottom Pay	Remarks	Casing	
						Size	Set At
Michigan Stray	1281	1315				10"	337
Marshall	1380					8 1/2"	818
Red Rock	1497	1560				6-5/8"	1596
" "	1575	1585				5-3/16"	3082
Sunbury	2575	2608					
Berea	2608	2655					
Antrim	2655	3031					
Traverse Lime	3170	SLM		3350	Salt Water 150'		
Dundee	3872	SLM	3985	3990	Show Salt Water		
			4065	4095	3500' Salt Water		
Total Depth		4095					

Remarks

Signed Dean C. Shackelford