



---

Legacy Scout Tickets from Pure Oil Company

---

8-20-2021

**MGRRE\_PureOilScoutTickets\_OCKERMAN, MARTHA  
J\_8\_21051045640000**

MGRRE  
*Western Michigan University*

Follow this and additional works at: <https://scholarworks.wmich.edu/pure>



Part of the Geology Commons

---

#### WMU ScholarWorks Citation

MGRRE, "MGRRE\_PureOilScoutTickets\_OCKERMAN, MARTHA J\_8\_21051045640000" (2021). *Legacy Scout Tickets from Pure Oil Company*. 2111.  
<https://scholarworks.wmich.edu/pure/2111>

This Document is brought to you for free and open access via ScholarWorks at WMU. It has been accepted for inclusion in Legacy Scout Tickets from Pure Oil Company by an authorized administrator of ScholarWorks at WMU. See the National Digital Catalogue - Science Base Catalogue for more collections submitted by MGRRE.



---

**MGRRE\_PureOilScoutTickets\_OCKERMAN, MARTHA J\_8\_21051045640000**

API 21051045640000

Permit Number 4564

Lease Name OCKERMAN, MARTHA J

Well Number 8

County Gladwin

Township 18N

Range 1W

Section 10

2021 DEQ or Pure co\_name T AND E INVESTMENTS CO OF MICHIGAN

Pure Number 437

Latitude 43.96515

Longitude -84.41515

The Pure Oil Company  
THE PURE OIL COMPANY

DATE October 14, 1937

LOCATION REPORT

No. 437

STATE Michigan COUNTY Gladwin

DIST. Buckeye  
TWP. Buckeye SEC. 10  
PREC. Martha J. Ockerman

TOWN. 18 N RANGE. 1 W

WELL No. 88 (SERIAL No. 437) FARM

Martha J. Ockerman

ACRES

NAME OF STREAM OR WATERS

QUADRANGLE

NW-NW-SE  
NW NW SE

OPERATOR Sun Oil Company

Map Buckeye Township, Gladwin County

330 330 Feet from North Line of Farm

" " East " " "

" " South " " "

330 330 " " West " " "

330 330 Feet from North Line of Section

" " East " " "

" " South " " "

330 330 " " West " 1/4 "

*Sp 10-13-37*

LEGEND

- LOCATION
- ⊕ RIG
- ⊕ DRILLING
- ☀ GAS WELL
- OIL WELL
- SMALL OIL WELL

- ⊙ DRY HOLE
- ⊙ DRY SHOWING OIL
- ⊙ DRY SHOWING GAS
- ⊙ ABANDONED LOCATION
- ☀ ABANDONED GAS WELL
- ABANDONED OIL WELL

NOTE: Below make tracing from map, (when no map is obtainable make sketch) showing farm, center of section, this location with measurements and also wells, dry holes, or other locations in the vicinity of this location.

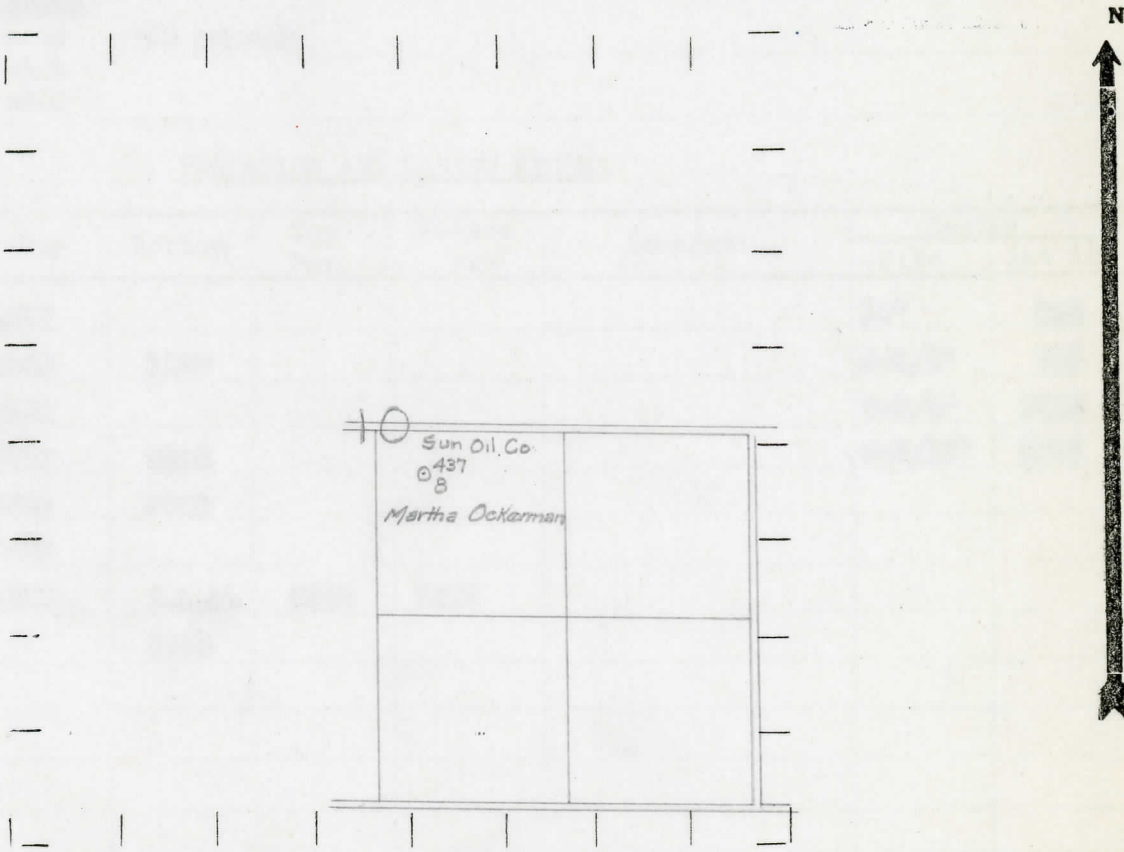

REMARKS:

SIGNED

*R. L. Yeager*

Superintendent or Foreman



COMPLETION RECORD OF WELLS DRILLED BY OTHER OPERATORS

Michigan Producing Division

Date December 2, 1937 No. 437  
 State Michigan County Gladwin Dist. \_\_\_\_\_  
 (Serial No.) Twp. Buckeye Sec. 10 Twp. 18 N Rge. 1 W  
 Well No. 8 (County No.) 437 Farm Martha J. Ockerman Acres \_\_\_\_\_  
 Operator Sun Oil Company Information secured ~~from~~ Scouting Department by \_\_\_\_\_  
 Date well started 10-13-37 Date well completed 11-18-37 Elevation 755.4

PRODUCTION RECORD

1st 24 hours natural Filled up 2500 ft.  
 2nd 24 hours natural \_\_\_\_\_  
 Date of shot \_\_\_\_\_ No. of quarts \_\_\_\_\_ From \_\_\_\_\_ to \_\_\_\_\_ From \_\_\_\_\_ to \_\_\_\_\_  
 Date of acid 11-22-37 No. of gallons 1000  
shots  
 1st 24 hours after acid 750 Barrels  
 shot \_\_\_\_\_  
 2nd 24 hours after acid \_\_\_\_\_

FORMATION AND CASING RECORD

Formation	Top	Bottom	Top Pay	Bottom Pay	Remarks	Casing	
						Size	Set At
Marshall	1015					10"	365
Red Rock	1140	1190				8-1/4"	780
Sunbury	2230					6-5/8"	1225
Berea	2250	2308				5-3/16"	3576
Antrim	2350	2800					
Traverse	2800						
Dundee	3565	S.L.M.	3615	3626			
Total Depth		3655					

Remarks \_\_\_\_\_  
 \_\_\_\_\_  
 \_\_\_\_\_

Signed D. C. Shackelford