



Western Michigan University
ScholarWorks at WMU

Legacy Scout Tickets from Pure Oil Company

8-20-2021

MGRRE_PureOilScoutTickets_FITZWATER_2_21051046310000

MGRRE

Western Michigan University

Follow this and additional works at: <https://scholarworks.wmich.edu/pure>



Part of the Geology Commons

WMU ScholarWorks Citation

MGRRE, "MGRRE_PureOilScoutTickets_FITZWATER_2_21051046310000" (2021). *Legacy Scout Tickets from Pure Oil Company*. 2144.

<https://scholarworks.wmich.edu/pure/2144>

This Document is brought to you for free and open access via ScholarWorks at WMU. It has been accepted for inclusion in Legacy Scout Tickets from Pure Oil Company by an authorized administrator of ScholarWorks at WMU. See the National Digital Catalogue - Science Base Catalogue for more collections submitted by MGRRE.



MGRRE_PureOilScoutTickets_FITZWATER_2_21051046310000

API 21051046310000

Permit Number 4631

Lease Name FITZWATER

Well Number 2

County Gladwin

Township 18N

Range 1W

Section 26

2021 DEQ or Pure co_name SUMMIT PETROLEUM CORP

Pure Number 470

Latitude 43.9253809

Longitude -84.3897368

DATE Nov. 4, 1937

LOCATION REPORT

No. 470

STATE Michigan COUNTY Gladwin DIST. Buckeye TWP. Buckeye SEC. 26 TOWN 18-N RANGE 1-W

WELL No. 2 (SERIAL No. 470) FARM Fritzwater ACRES

NAME OF STREAM OR WATERS QUADRANGLE NW-SE-NE

OPERATOR S. & S. Oil Co. Map Buckeye Twp., Gladwin Co.

Feet from North Line of Farm
200 200 " " East " " "

" " South " " "

200 200 " " West " " "

Feet from North Line of Section

1120 1120 " " East " " "

1120 1120 " " South " 1/4 "

" " West " " "

○ LOCATION

⊕ RIG

⊕ DRILLING

☀ GAS WELL

● OIL WELL

● SMALL OIL WELL

LEGEND

○ DRY HOLE

● DRY SHOWING OIL

○ DRY SHOWING GAS

⊕ ABANDONED LOCATION

☀ ABANDONED GAS WELL

● ABANDONED OIL WELL

NOTE: Below make tracing from map, (when no map is obtainable make sketch) showing farm, center of section, this location with measurements and also wells, dry holes, or other locations in the vicinity of this location.

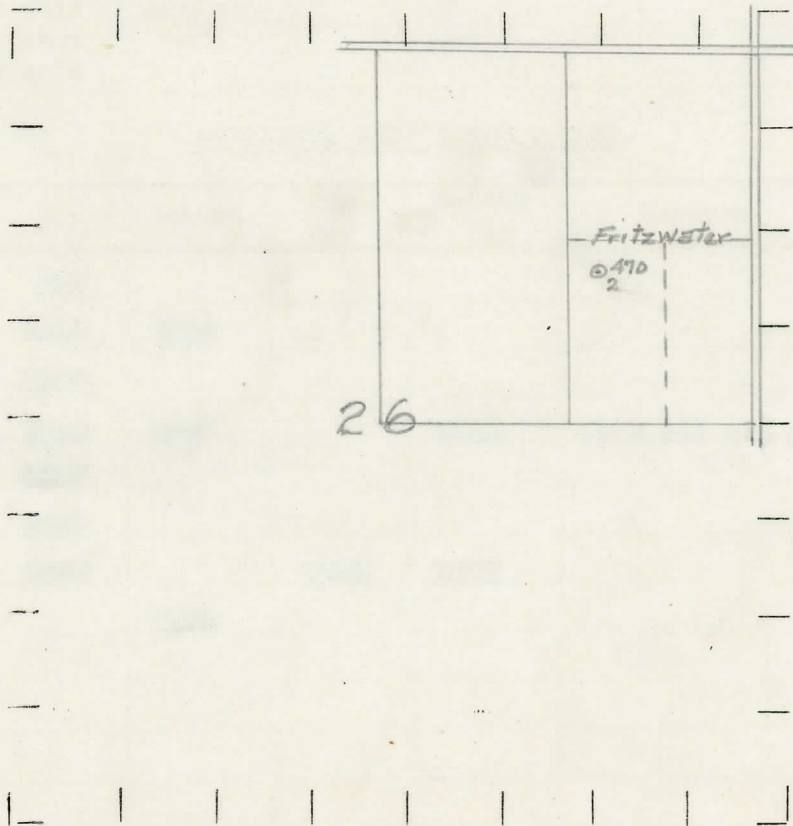

REMARKS:

SIGNED

R. L. Yeager

Superintendent or Foreman.

Michigan Producing Division

Date January 6, 1938 No. 470
 State Michigan County Gladwin Dist. _____
 (Serial No.) Twp. Buckeye Sec. 26 Twp. 18 N Rge. 1 W
 Well No. 2 (County No.) 470 Farm Fritzwater Acres _____
 Operator S. and S. Oil Company Information secured ~~from~~ Scouting Department by _____
 Date well started 11-23-37 Date well completed 1-2-38 Elevation 736.0

PRODUCTION RECORD

1st 24 hours natural 420 Barrels
 2nd 24 hours natural _____
 Date of shot _____ No. of quarts _____ From _____ to _____ From _____ to _____
 Date of acid _____ No. of gallons _____
 shot _____
 1st 24 hours after acid _____
 shot _____
 2nd 24 hours after acid _____

FORMATION AND CASING RECORD

Formation	Top	Bottom	Top Pay	Bottom Pay	Remarks	Casing	
						Size	Set to
Marshall	953					10"	240
Red Rock	1078	1116				6-5/8"	1176
Sunbury	2158					5-3/16"	3512
Berea	2192	2267		2194	Show oil and gas		
Antrim	2267						
Traverse	2752						
Dundee	3497		3563	3571			
Total Depth		3574					

Remarks _____

Signed D. C. Shackelford