



Western Michigan University
ScholarWorks at WMU

Legacy Scout Tickets from Pure Oil Company

8-20-2021

MGRRE_PureOilScoutTickets_VANTICK, JOE_1_21051046890000

MGRRE

Western Michigan University

Follow this and additional works at: <https://scholarworks.wmich.edu/pure>



Part of the Geology Commons

WMU ScholarWorks Citation

MGRRE, "MGRRE_PureOilScoutTickets_VANTICK, JOE_1_21051046890000" (2021). *Legacy Scout Tickets from Pure Oil Company*. 2177.

<https://scholarworks.wmich.edu/pure/2177>

This Document is brought to you for free and open access via ScholarWorks at WMU. It has been accepted for inclusion in Legacy Scout Tickets from Pure Oil Company by an authorized administrator of ScholarWorks at WMU. See the National Digital Catalogue - Science Base Catalogue for more collections submitted by MGRRE.



MGRRE_PureOilScoutTickets_VANTICK, JOE_1_21051046890000

API 21051046890000

Permit Number 4689

Lease Name VANTICK, JOE

Well Number 1

County Gladwin

Township 17N

Range 2E

Section 30

2021 DEQ or Pure co_name SWANSON CONSOLIDATED OIL CO

Pure Number 503

Latitude 43.85574

Longitude -84.28406

DATE December 2, 1937

LOCATION REPORT

No. 503

STATE Michigan COUNTY Gladwin DIST. Bentley TWP. Bentley SEC. 30 TOWN 17 N RANGE 2 E
WELL No. 1 (SERIAL No. 503) FARM Joe Vantick ACRES

NAME OF STREAM OR WATERS _____ QUADRANGLE NE NW NW

OPERATOR Swanson Consolidated Oil Company Map Bentley Township, Gladwin County

330 330 Feet from North Line of Farm

330 " " East " " "

" " South " " "

" " West " " "

330 330 Feet from North Line of Section

" " East " " "

" " South " " "

990 990 " " West " " "

Handwritten notes:
Swanson Consolidated Oil Co.
Bentley - Glad
re. Loo.

LEGEND

- LOCATION
- ⊙ RIG
- ⊕ DRILLING
- ☀ GAS WELL
- OIL WELL
- SMALL OIL WELL
- ⊙ DRY HOLE
- DRY SHOWING OIL
- ⊙ DRY SHOWING GAS
- ⊙ ABANDONED LOCATION
- ☀ ABANDONED GAS WELL
- ABANDONED OIL WELL

NOTE: Below make tracing from map, (when no map is obtainable make sketch) showing farm, center of section, this location with measurements and also wells, dry holes, or other locations in the vicinity of this location.

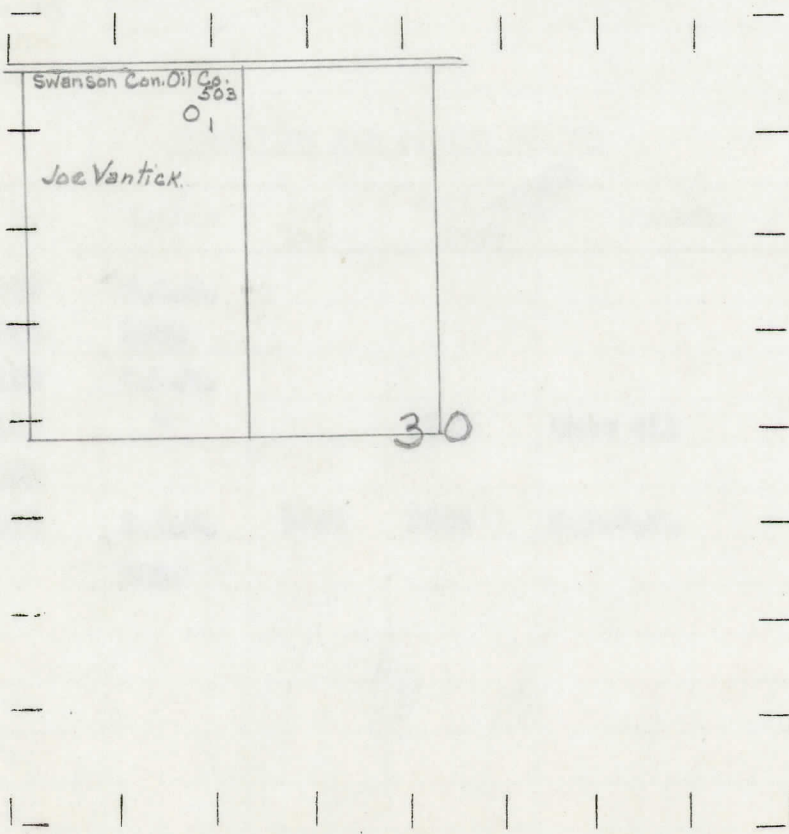

REMARKS:

SIGNED

R. L. Yeager

Superintendent or Foreman.

COMPLETION RECORD OF WELLS DRILLED BY OTHER OPERATORS

Michigan Producing Division

Date February 17, 1938 No. 503
 State Michigan County Gladwin Dist. Bentley Twp. Bentley Sec. 30 Twp. 17 N Rge. 2 E
 Well No. 1 (Serial No.) (County No.) 503 Farm Joe Vantick Acres _____
 Operator Swanson Consolidated Oil Co. Information secured ~~from~~ Scouting Department by _____
 Date well started 12-23-37 Date well completed 2-10-38 Elevation 712.1

PRODUCTION RECORD

1st 24 hours natural Dry Hole
 2nd 24 hours natural _____
 Date of shot _____ No. of quarts _____ From _____ to _____ From _____ to _____
 Date of acid _____ No. of gallons _____
 1st 24 hours after acid shot _____
 2nd 24 hours after acid shot _____

FORMATION AND CASING RECORD

Formation	Top	Bottom	Top Pay	Bottom Pay	Remarks	Casing	
						Size	Set At
Marshall	939	S.L.M.				10"	303
Red Rock	1050	1080				6-5/8"	1185 ?
Sunbury	2150	S.L.M.				5-3/16"	3480
Berea	2185	"		2190	Show oil		
Traverse	2755						
Dundee	3472	S.L.M.	3645	3655	H.F.S.W.		
Total Depth		3655					

Remarks _____

Signed D. C. Shackelford