



Western Michigan University
ScholarWorks at WMU

Legacy Scout Tickets from Pure Oil Company

8-20-2021

MGRRE_PureOilScoutTickets_STATE_1_21051048910000

MGRRE

Western Michigan University

Follow this and additional works at: <https://scholarworks.wmich.edu/pure>



Part of the Geology Commons

WMU ScholarWorks Citation

MGRRE, "MGRRE_PureOilScoutTickets_STATE_1_21051048910000" (2021). *Legacy Scout Tickets from Pure Oil Company*. 2241.

<https://scholarworks.wmich.edu/pure/2241>

This Document is brought to you for free and open access via ScholarWorks at WMU. It has been accepted for inclusion in Legacy Scout Tickets from Pure Oil Company by an authorized administrator of ScholarWorks at WMU. See the National Digital Catalogue - Science Base Catalogue for more collections submitted by MGRRE.



MGRRE_PureOilScoutTickets_STATE_1_21051048910000

API 21051048910000

Permit Number 4891

Lease Name STATE

Well Number 1

County Gladwin

Township 17N

Range 2E

Section 35

2021 DEQ or Pure co_name MCCLANAHAN OIL CO

Pure Number 567

Latitude 43.82765

Longitude -84.20089

THE PURE OIL COMPANY
 COMPLETION RECORD FOR OTHER OPERATORS

567

DATE March 24, 1938

LOCATION REPORT

No. 567

STATE Michigan COUNTY Gladwin DIST. Bentley TWP. Bentley SEC. 35 TOWN 17 N RANGE 2 E

WELL No. 1 (SERIAL No. 567) FARM State ACRES

NAME OF STREAM OR WATERS QUADRANGLE SW-SE-SW

OPERATOR McClanahan Oil Company Map Bentley Township, Gladwin County

McClanahan Oil Co.
 Feet from North Line of Farm

" " East " " "

3330 " " South " " "

3330 " " West " " "

Feet from North Line of Section

9990 " " East 1/4 "

3330 " " South " " "

" " West " " "

Bentley - Glad.

LEGEND

- LOCATION
- ⊕ RIG
- ⊕ DRILLING
- ☀ GAS WELL
- OIL WELL
- SMALL OIL WELL
- ⊖ DRY HOLE
- ⊖ DRY SHOWING OIL
- ⊖ DRY SHOWING GAS
- ⊖ ABANDONED LOCATION
- ☀ ABANDONED GAS WELL
- ABANDONED OIL WELL

NOTE: Below make tracing from map, (when no map is obtainable make sketch) showing farm, center of section, this location with measurements and also wells, dry holes, or other locations in the vicinity of this location.

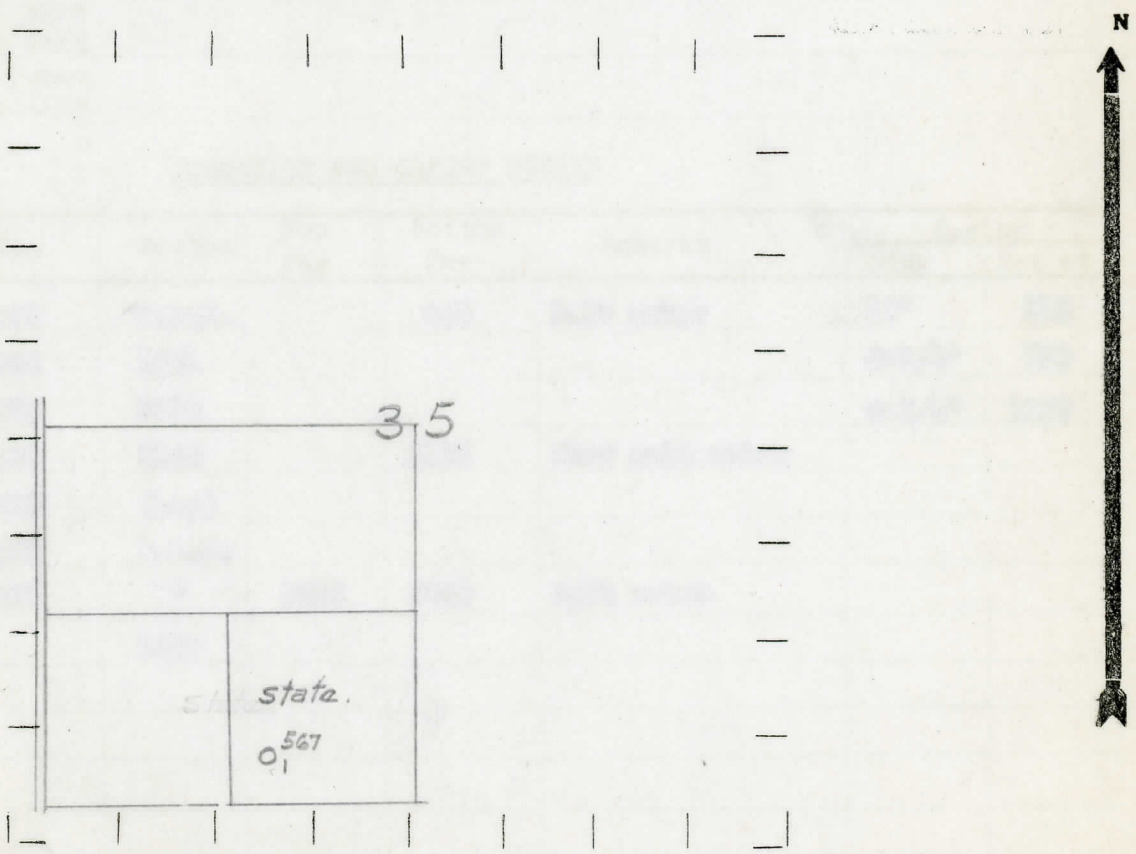

REMARKS:

SIGNED R. L. Yeager
 Superintendent or Foreman.

COMPLETION RECORD OF WELLS DRILLED BY OTHER OPERATORS

Michigan Producing Division

Date May 19, 1938 No. 567
 State Mich. County Gladwin ~~District~~ Twp. Dentley Sec. 35 Twp. 17 N Rge. 2 E
 Well No. 1 (Serial No.) (County No.) 567 Farm State Acres _____
 Operator McClanahan Oil Company Information secured ~~from~~ Scouting Department By _____
 Date well started 4-14-38 Date well completed 5-19-38 Elevation 684.5

PRODUCTION RECORD

1st 24 hours natural Dry Hole
 2nd 24 hours natural _____
 Date of shot _____ No. of quarts _____ From _____ to _____ From _____ to _____
 Date of acid _____ No. of gallons _____
 1st 24 hours after acid shot _____
 2nd 24 hours after acid shot _____

FORMATION AND CASING RECORD

Formation	Top	Bottom	Top Pay	Bottom Pay	Remarks	Casing	
						Size	Set at
Marshall	835	S.L.M.		845	Salt water	10"	215
Red Rock	964	1012				8-1/4"	720
Sunbury	2058	2090				6-5/8"	1120
Berea	2090	2140		2135	Show salt water		
Antrim	2235	(Log)					
Traverse	2655	S.L.M.					
Dundee	3412	"	3626	3628	Salt water		
Total Depth		3628					

Remarks _____

Signed D. C. Shackelford