



Western Michigan University
ScholarWorks at WMU

Legacy Scout Tickets from Pure Oil Company

8-20-2021

**MGRRE_PureOilScoutTickets_NASH, WALTER
L_1_21051050650000**

MGRRE

Western Michigan University

Follow this and additional works at: <https://scholarworks.wmich.edu/pure>



Part of the Geology Commons

WMU ScholarWorks Citation

MGRRE, "MGRRE_PureOilScoutTickets_NASH, WALTER L_1_21051050650000" (2021). *Legacy Scout Tickets from Pure Oil Company*. 2275.

<https://scholarworks.wmich.edu/pure/2275>

This Document is brought to you for free and open access via ScholarWorks at WMU. It has been accepted for inclusion in Legacy Scout Tickets from Pure Oil Company by an authorized administrator of ScholarWorks at WMU. See the National Digital Catalogue - Science Base Catalogue for more collections submitted by MGRRE.



MGRRE_PureOilScoutTickets_NASH, WALTER L_1_21051050650000

API 21051050650000

Permit Number 5065

Lease Name NASH, WALTER L

Well Number 1

County Gladwin

Township 20N

Range 2W

Section 28

2021 DEQ or Pure co_name SMITH PETROLEUM CO

Pure Number 603

Latitude 44.09046

Longitude -84.54983

The Pure Oil Company
THE PURE OIL COMPANY
COMPLETION RECORD OF WELLS DRILLED BY OTHER OPERATORS

DATE June 9, 1938

LOCATION REPORT

No. 603

STATE Michigan COUNTY Gladwin DIST. Sherman TWP. Sherman SEC. 28 TOWN 20 N RANGE 2 W

WELL No. 1 (SERIAL No. 603) FARM Walter L. Nash ACRES

NAME OF STREAM OR WATERS QUADRANGLE SW-SE-SE

OPERATOR Smith Petroleum Company Map Sherman Township, Gladwin County
Smith Pet. Co. Sherman - Glad.

Feet from North Line of Farm

990 990 " " East " " "

330 330 " " South " " "

" " West " " "

Feet from North Line of Section

990 990 " " East " " "

330 330 " " South " " "

" " West " " "

- LOCATION
- ⊕ RIG
- ⊕ DRILLING
- ☀ GAS WELL
- OIL WELL
- ⊕ SMALL OIL WELL

LEGEND

- ⊕ DRY HOLE
- ⊕ DRY SHOWING OIL
- ⊕ DRY SHOWING GAS
- ⊕ ABANDONED LOCATION
- ☀ ABANDONED GAS WELL
- ⊕ ABANDONED OIL WELL

NOTE: Below make tracing from map, (when no map is obtainable make sketch) showing farm, center of section, this location with measurements and also wells, dry holes, or other locations in the vicinity of this location.

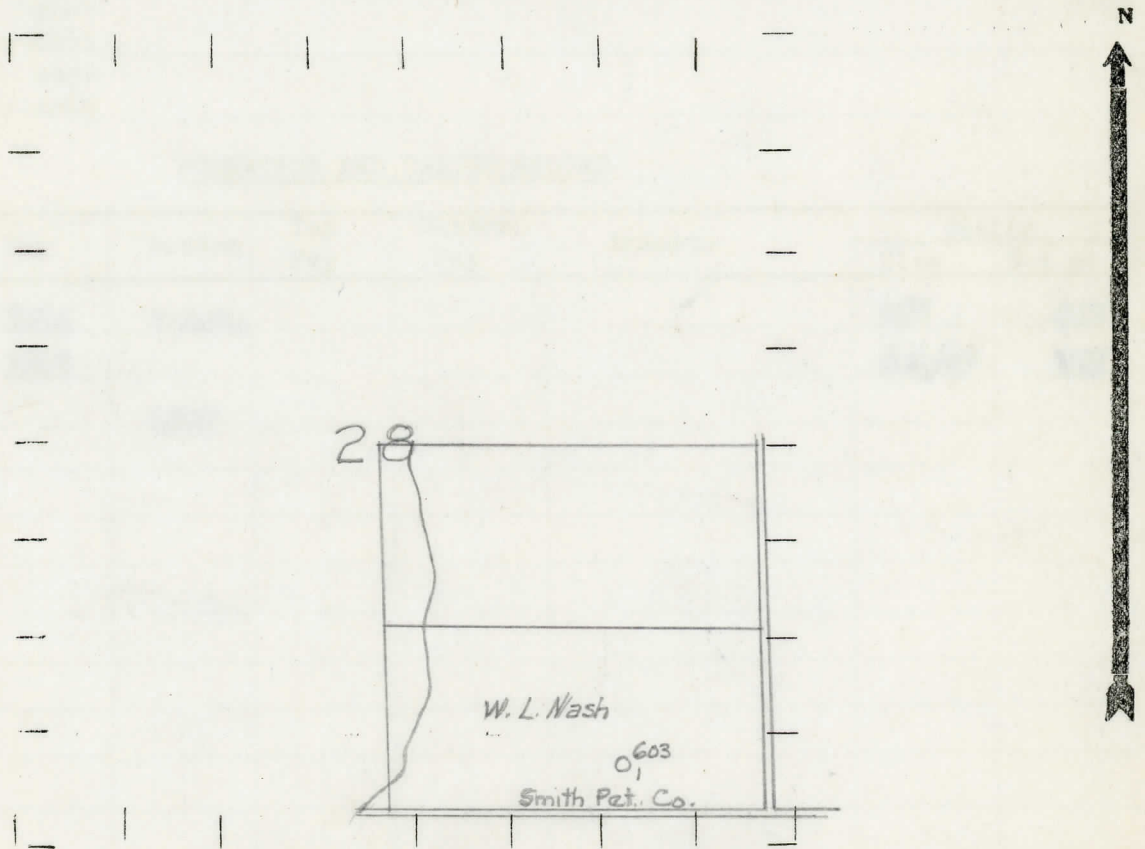

REMARKS:

SIGNED

R. L. Y.

Superintendent or Foreman.

