



Western Michigan University
ScholarWorks at WMU

Legacy Scout Tickets from Pure Oil Company

8-20-2021

MGRRE_PureOilScoutTickets_RUCK, W_A-2_21051054760000

MGRRE

Western Michigan University

Follow this and additional works at: <https://scholarworks.wmich.edu/pure>



Part of the Geology Commons

WMU ScholarWorks Citation

MGRRE, "MGRRE_PureOilScoutTickets_RUCK, W_A-2_21051054760000" (2021). *Legacy Scout Tickets from Pure Oil Company*. 2312.

<https://scholarworks.wmich.edu/pure/2312>

This Document is brought to you for free and open access via ScholarWorks at WMU. It has been accepted for inclusion in Legacy Scout Tickets from Pure Oil Company by an authorized administrator of ScholarWorks at WMU. See the National Digital Catalogue - Science Base Catalogue for more collections submitted by MGRRE.



MGRRE_PureOilScoutTickets_RUCK, W_A-2_21051054760000

API 21051054760000

Permit Number 5476

Lease Name RUCK, W

Well Number A-2

County Gladwin

Township 18N

Range 1W

Section 26

2021 DEQ or Pure co_name SUMMIT PETROLEUM CORP

Pure Number 644

Latitude 43.9218547

Longitude -84.3996512

DATE October 13, 1938

LOCATION REPORT

No. 644

STATE Michigan COUNTY Gladwin DIST. Buckeye TWP. Buckeye SEC. 26 TOWN 18 N RANGE 1 W

WELL No. 22 (SERIAL No. 644) FARM W. Ruck "A" ACRES _____

NAME OF STREAM OR WATERS _____ QUADRANGLE NW NE SW

OPERATOR Rex Oil & Gas Company Map Buckeye Township, Gladwin County

3330 Feet from North Line of Farm

9990 " " East " " "

" " South " " "

" " West " " "

33330 Feet from North Line of Section 1/4

99090 " " East " 1/4 "

" " South " " "

" " West " " "

Low

LEGEND

- | | |
|------------------|----------------------|
| ○ LOCATION | ⊙ DRY HOLE |
| ⊕ RIG | ⊙ DRY SHOWING OIL |
| ⊕ DRILLING | ⊙ DRY SHOWING GAS |
| ⊙ GAS WELL | ⊙ ABANDONED LOCATION |
| ● OIL WELL | ⊙ ABANDONED GAS WELL |
| ● SMALL OIL WELL | ⊙ ABANDONED OIL WELL |

NOTE: Below make tracing from map, (when no map is obtainable make sketch) showing farm, center of section, this location with measurements and also wells, dry holes, or other locations in the vicinity of this location.

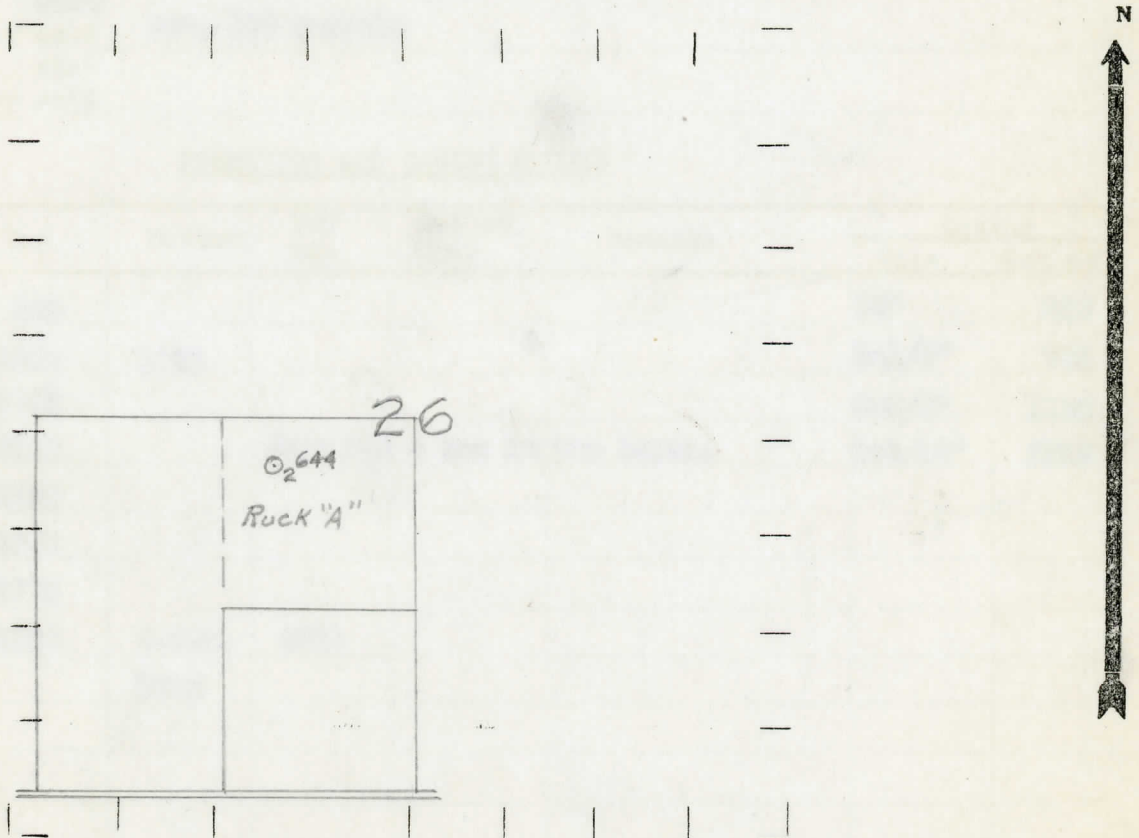

REMARKS:

SIGNED _____

Superintendent or Foreman.

COMPLETION RECORD OF WELLS DRILLED BY OTHER OPERATORS

Michigan Producing Division

Date December 10, 1938 No. 644
 State Mich. County Gladwin Dist. Buckeye Twp. Buckeye Sec. 26 Twp. 18 N Rge. 1 W
 (Serial No.)
 Well No. 2 (County No.) 644 Farm W. Ruck "A" Acres _____
 Operator Rox Oil & Gas Company Information secured ~~from~~ Scouting Department By _____
 Date well started 10-10-38 Date well completed 12-6-38 Elevation 738.4

PRODUCTION RECORD

1st 24 hours natural Hole filled up with Oil.
 2nd 24 hours natural _____
 Date of shot _____ No. of quarts _____ From _____ to _____ From _____ to _____
 Date of acid 12-10-38 No. of gallons 500
shot
 1st 24 hours after acid Est. 100 Barrels
shot
 2nd 24 hours after acid _____

FORMATION AND CASING RECORD

Formation	Top	Bottom	Top Pay	Bottom Pay	Remarks	Casing	
						Size	Set at
Marshall	955					10"	229
Red Rock	1080	1125				8-1/4"	744
Sunbury	2145					6-5/8"	1150
Berea	2190				Show oil & gas in the Berea.	5-3/16"	3505
Antrim	2280						
Traverse Form.	2750						
Traverse Line	2770						
Dundee	3500	C.T.M.	3571				
Total Depth		3590					

Remarks _____

Signed D. C. Shackelford