



Western Michigan University
ScholarWorks at WMU

Legacy Scout Tickets from Pure Oil Company

8-20-2021

**MGRRE_PureOilScoutTickets_SCHLICHTER
ESTATE_1_21051057400000**

MGRRE
Western Michigan University

Follow this and additional works at: <https://scholarworks.wmich.edu/pure>



Part of the Geology Commons

WMU ScholarWorks Citation

MGRRE, "MGRRE_PureOilScoutTickets_SCHLICHTER ESTATE_1_21051057400000" (2021). *Legacy Scout Tickets from Pure Oil Company*. 2316.

<https://scholarworks.wmich.edu/pure/2316>

This Document is brought to you for free and open access via ScholarWorks at WMU. It has been accepted for inclusion in Legacy Scout Tickets from Pure Oil Company by an authorized administrator of ScholarWorks at WMU. See the National Digital Catalogue - Science Base Catalogue for more collections submitted by MGRRE.



MGRRE_PureOilScoutTickets_SCHLICHTER ESTATE_1_21051057400000

API 21051057400000

Permit Number 5740

Lease Name SCHLICHTER ESTATE

Well Number 1

County Gladwin

Township 19N

Range 1W

Section 23

2021 DEQ or Pure co_name BOVELL E A

Pure Number 648

Latitude 44.02441

Longitude -84.39822

DATE Dec. 29, 1938

LOCATION REPORT

No. 648

STATE Michigan COUNTY Gladwin DIST. Gladwin TWP. Gladwin SEC. 23 TOWN. 19 N RANGE 1 W

WELL No. 1 (SERIAL No. 648) FARM Schlichter Estate ACRES _____

NAME OF STREAM OR WATERS _____ QUADRANGLE SE SE NW

OPERATOR E. A. Bovell Map Gladwin Township, Gladwin County

E. A. Bovell

Glad-Glad.

Feet from North Line of Farm

" " East " " "

" " South " " "

" " West " " "

Feet from North Line of Section

330 330 " " East " 1/4 "

330 330 " " South " 1/4 "

" " West " " "

LEGEND

- LOCATION
- ⊕ RIG
- ⊕ DRILLING
- ☀ GAS WELL
- OIL WELL
- SMALL OIL WELL
- ⊙ DRY HOLE
- ⊙ DRY SHOWING OIL
- ⊙ DRY SHOWING GAS
- ⊙ ABANDONED LOCATION
- ⊙ ABANDONED GAS WELL
- ⊙ ABANDONED OIL WELL

NOTE: Below make tracing from map, (when no map is obtainable make sketch) showing farm, center of section, this location with measurements and also wells, dry holes, or other locations in the vicinity of this location.

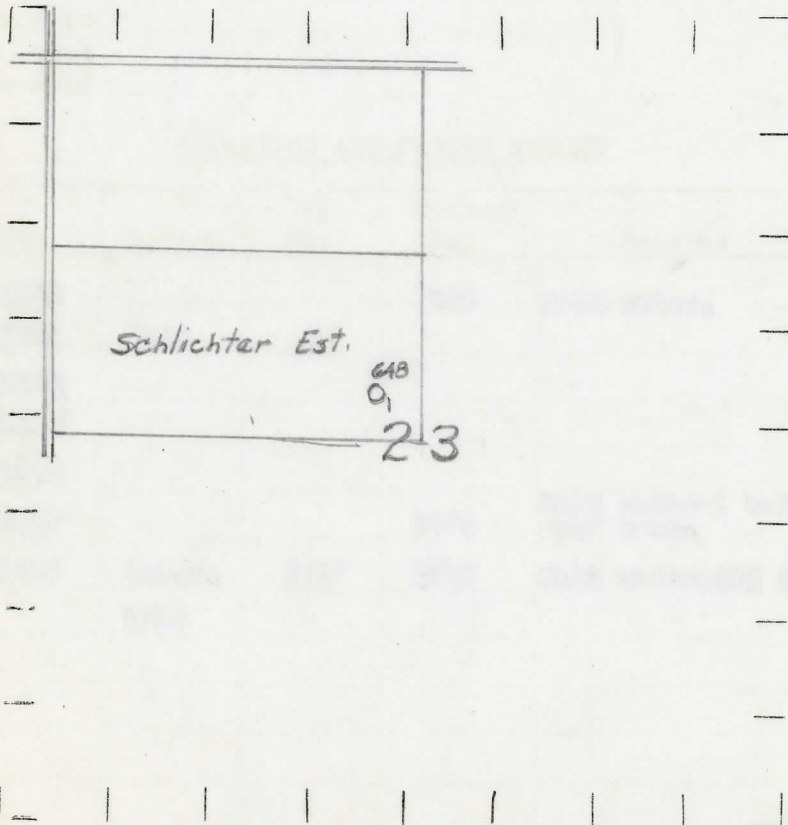

REMARKS:

SIGNED

Superintendent or Foreman.

Michigan Producing Division

Date April 15, 1939 No. 648
 State Mich. County Gladwin Dist. Gladwin Twp. Gladwin Sec. 23 Twp. 19 N Rge. 1 W
 Well No. 1 (Serial No.) 648 Farm Schlichter Estate Acres _____
 Operator E. A. Bovell Information secured from Scouting Department
 Date well started 1-3-39 Dated well completed 4-10-39 Elevation 755.1

PRODUCTION RECORD

1st 24 hours natural Dry Hole
 2nd 24 hours natural _____
 Date of shot _____ No. of quarts _____ From _____ to _____ From _____ to _____
 Date of acid _____ No. of gallons _____
 shot _____
 1st 24 hours after acid _____
 shot _____
 2nd 24 hours after acid _____

FORMATION AND CASING RECORD

Formation	Top	Bottom	Top Pay	Bottom Pay	Remarks	Casing	
						Size	Set at
Marshall	1076			1086	Salt water.	10"	441
Red Rock	1193	1240				8-1/4"	774
Sunbury	2275					6-5/8"	1275
Berea	2310					5-3/16"	3619
Antrim	2400						
Traverse	2840			3075	Salt water-1 bailer per hour.		
Dundee	3615	S.L.M.	3717	3723	Salt water-400 ft.		
Total Depth		3723					

Remarks 1046' C.T.M. equals 1046' S.L.M.