



Western Michigan University
ScholarWorks at WMU

Legacy Scout Tickets from Pure Oil Company

8-20-2021

**MGRRE_PureOilScoutTickets_TUCKERMAN, CARL OTTO, ET
AL_1_21051057830000**

MGRRE
Western Michigan University

Follow this and additional works at: <https://scholarworks.wmich.edu/pure>



Part of the Geology Commons

WMU ScholarWorks Citation

MGRRE, "MGRRE_PureOilScoutTickets_TUCKERMAN, CARL OTTO, ET AL_1_21051057830000" (2021).
Legacy Scout Tickets from Pure Oil Company. 2317.
<https://scholarworks.wmich.edu/pure/2317>

This Document is brought to you for free and open access via ScholarWorks at WMU. It has been accepted for inclusion in Legacy Scout Tickets from Pure Oil Company by an authorized administrator of ScholarWorks at WMU. See the National Digital Catalogue - Science Base Catalogue for more collections submitted by MGRRE.



**MGRRE_PureOilScoutTickets_TUCKERMAN, CARL OTTO, ET
AL_1_21051057830000**

API 21051057830000

Permit Number 5783

Lease Name TUCKERMAN, CARL OTTO, ET AL

Well Number 1

County Gladwin

Township 17N

Range 2W

Section 2

2021 DEQ or Pure co_name ORYX ENERGY CO

Pure Number 649

Latitude 43.89972

Longitude -84.50631

THE PURE OIL COMPANY
 COMPLETION RECORD OF WELLS DRILLED BY OTHER OPERATORS
 LOCATION REPORT

DATE January 26, 1939

No. 649

STATE Michigan COUNTY Gladwin DIST. Beaverton TWP. Beaverton SEC. 2 TOWN 17 N RANGE 2 W

WELL No. 1 (SERIAL No. 649) FARM Carl Otto Tuckerman, et al. ACRES

NAME OF STREAM OR WATERS _____ QUADRANGLE 64-NE-NE

OPERATOR Sun Oil Company Map Beaverton Township, Gladwin County

66660 Feet from North Line of Farm

33330 " " East " " "

" " South " " "

" " West " " "

660660 Feet from North Line of Section

330330 " " East " " "

" " South " " "

" " West " " "

LEGEND

- LOCATION
- ⊕ RIG
- ⊕ DRILLING
- ☀ GAS WELL
- OIL WELL
- ⊙ SMALL OIL WELL
- ⊙ DRY HOLE
- ⊙ DRY SHOWING OIL
- ⊙ DRY SHOWING GAS
- ⊙ ABANDONED LOCATION
- ⊙ ABANDONED GAS WELL
- ⊙ ABANDONED OIL WELL

NOTE: Below make tracing from map, (when no map is obtainable make sketch) showing farm, center of section, this location with measurements and also wells, dry holes, or other locations in the vicinity of this location.

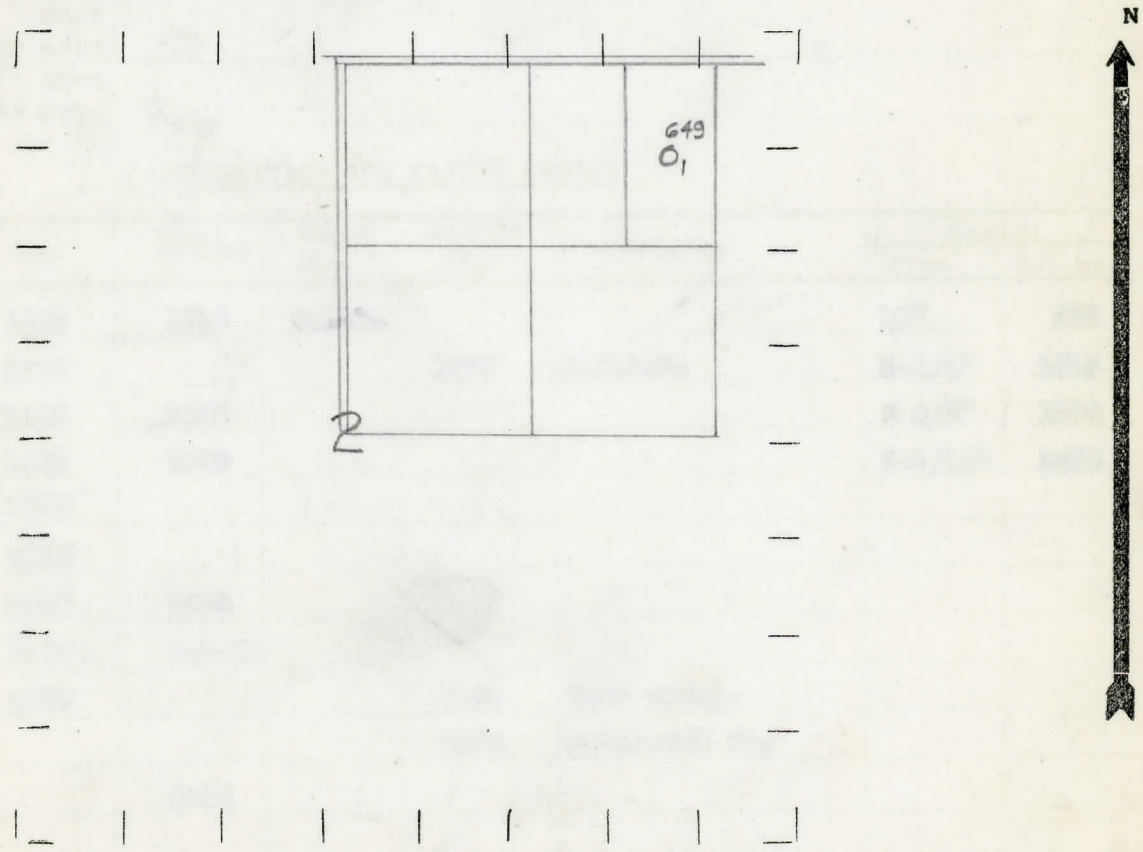

REMARKS: _____

SIGNED

 Superintendent or Foreman.

Michigan Producing Division

Date March 16, 1939 No. 649
 State Mich. County Gladwin Dist. Beaverton Twp. Beaverton Sec. 2 Twp. 17 N Rge. 2 W
 Well No. 1 (County No.) 649 Farm Tuckerman, et al Acres _____
 Operator Sun Oil Company Information secured from Scouting Department
 Date well started 1-28-39 Date well completed 3-15-39 Elevation 741.4

PRODUCTION RECORD

1st 24 hours natural Dry Hole
 2nd 24 hours natural _____
 Date of shot _____ No. of quarts _____ From _____ to _____ From _____ to _____
 Date of acid _____ No. of gallons _____
 1st 24 hours after acid shot _____
 2nd 24 hours after acid shot _____

FORMATION AND CASING RECORD

Formation	Top	Bottom	Top Pay	Bottom Pay	Remarks	Casing	
						Size	Set at
Stray	1292	1316	S.L.M.			10"	392
Marshall	1355			1363	H.F.S.W.	8-1/4"	1013
Red Rock	1402	1530				6-5/8"	1574
" "	1553	1559				5-3/16"	3878
Sunbury	2582						
Berea	2618						
Antrim	2670	3054					
Traverse	3170	S.L.M.					
Dundee	3870			3965	Show water.		
				3978	Water-500 ft.		
Total Depth		3999					

Remarks 1322' C.T.M. equals 1334' S.L.M. Show water 1292'-1316'.

Signed D. C. Shackelford