



Western Michigan University
ScholarWorks at WMU

Legacy Scout Tickets from Pure Oil Company

8-20-2021

**MGRRE_PureOilScoutTickets_LOCKWOOD, H.
C._1_21051062090000**

MGRRE
Western Michigan University

Follow this and additional works at: <https://scholarworks.wmich.edu/pure>



Part of the Geology Commons

WMU ScholarWorks Citation

MGRRE, "MGRRE_PureOilScoutTickets_LOCKWOOD, H. C._1_21051062090000" (2021). *Legacy Scout Tickets from Pure Oil Company*. 2319.
<https://scholarworks.wmich.edu/pure/2319>

This Document is brought to you for free and open access via ScholarWorks at WMU. It has been accepted for inclusion in Legacy Scout Tickets from Pure Oil Company by an authorized administrator of ScholarWorks at WMU. See the National Digital Catalogue - Science Base Catalogue for more collections submitted by MGRRE.



MGRRE_PureOilScoutTickets_LOCKWOOD, H. C._1_21051062090000

API 21051062090000

Permit Number 6209

Lease Name LOCKWOOD, H. C.

Well Number 1

County Gladwin

Township 17N

Range 1E

Section 34

2021 DEQ or Pure co_name LOCKWOOD H C

Pure Number 652

Latitude 43.84199

Longitude -84.34674

THE PURE OIL COMPANY

COMPLETION RECORD OF OTHER OPERATORS

DATE May 25, 1939

LOCATION REPORT

No. 652

STATE Michigan COUNTY Gladwin DIST. Billings TWP. Billings SEC. 34 TOWN 17 N RANGE 1 E

WELL No. 1 (SERIAL No. 652) FARM _____ ACRES _____

NAME OF STREAM OR WATERS _____ QUADRANGLE NW-NW-NW
NW NW NW

OPERATOR H. C. Lockwood Map Billings Township, Gladwin County

330 330 Feet from North Line of Farm

" " East " " "

" " South " " "

330 330

" " West " " "

330 330

Feet from North Line of Section

" " East " " "

" " South " " "

330 330

" " West " " "

Low

- LOCATION
- ⊙ RIG
- ⊕ DRILLING
- ☀ GAS WELL
- OIL WELL
- ⦿ SMALL OIL WELL

LEGEND

- ⊙ DRY HOLE
- ⦿ DRY SHOWING OIL
- ⊕ DRY SHOWING GAS
- ⊙ ABANDONED LOCATION
- ☀ ABANDONED GAS WELL
- ⦿ ABANDONED OIL WELL

NOTE: Below make tracing from map, (when no map is obtainable make sketch) showing farm, center of section, this location with measurements and also wells, dry holes, or other locations in the vicinity of this location.

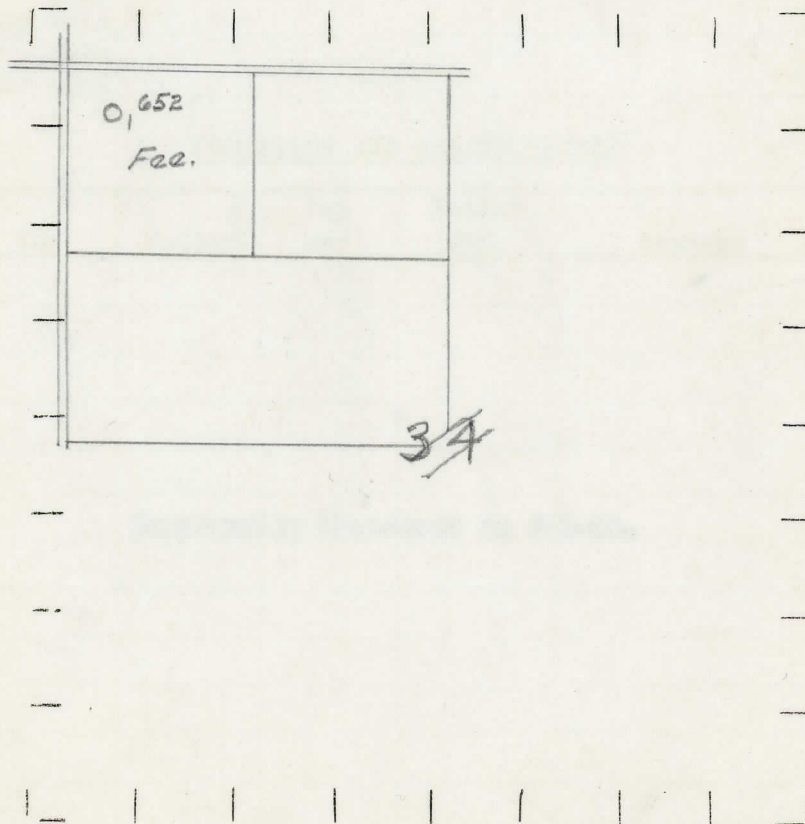

REMARKS:

SIGNED

Superintendent or Foreman.

Michigan Producing Division

Date August 3, 1939 No. 652
State Mich. County Gladwin Dist. Billings Twp. 17 N Rge. 1 E
Well No. 1 (Serial No.) 652 Farm H. C. Lockwood Acres
Operator H. C. Lockwood Information secured from Scouting Department
Date well started Not started Dated well completed Not completed. Elevation

PRODUCTION RECORD

1st 24 hours natural Temporarily abandoned.
2nd 24 hours natural
Date of shot No. of quarts From to From to
Date of acid No. of gallons
1st 24 hours after acid shot
2nd 24 hours after acid shot

FORMATION AND CASING RECORD

Table with columns: Formation, Top, Bottom, Top Pay, Bottom Pay, Remarks, Casing Size, Casing Set at. Includes note: Temporarily abandoned on 8-1-39.

Remarks

Signed D. C. Shackelford