



Western Michigan University
ScholarWorks at WMU

Legacy Scout Tickets from Pure Oil Company

8-20-2021

**MGRRE_PureOilScoutTickets_STAHL,
NEWTON_1_21051075260000**

MGRRE

Western Michigan University

Follow this and additional works at: <https://scholarworks.wmich.edu/pure>



Part of the Geology Commons

WMU ScholarWorks Citation

MGRRE, "MGRRE_PureOilScoutTickets_STAHL, NEWTON_1_21051075260000" (2021). *Legacy Scout Tickets from Pure Oil Company*. 2324.

<https://scholarworks.wmich.edu/pure/2324>

This Document is brought to you for free and open access via ScholarWorks at WMU. It has been accepted for inclusion in Legacy Scout Tickets from Pure Oil Company by an authorized administrator of ScholarWorks at WMU. See the National Digital Catalogue - Science Base Catalogue for more collections submitted by MGRRE.



MGRRE_PureOilScoutTickets_STAHL, NEWTON_1_21051075260000

API 21051075260000

Permit Number 7526

Lease Name STAHL, NEWTON

Well Number 1

County Gladwin

Township 18N

Range 1W

Section 24

2021 DEQ or Pure co_name TEATER C W

Pure Number 659

Latitude 43.9323

Longitude -84.37947

THE PURE OIL COMPANY

DATE April 10, 1940 COMPLETION RECORD OF LOCATION REPORT OTHER OPERATORS

No. 659

STATE Michigan COUNTY Gladwin DIST. Buckeye TWP. Buckeye SEC. 24 TOWN 18 N RANGE 1 W
WELL No. 1 (SERIAL No. 659) FARM Newton Stahl ACRES

NAME OF STREAM OR WATERS QUADRANGLE NW SE SW

OPERATOR C. W. Teater Map Buckeye Township, Gladwin County

Feet from North Line of Farm

990 " " East " " "

330 " " South " " "

330 " " West " " "

Feet from North Line of Section

990 " " East " 1/4 "

990 " " South " " "

" " West " " "

LEGEND

- LOCATION
- ⊕ RIG
- ⊕ DRILLING
- ☀ GAS WELL
- OIL WELL
- SMALL OIL WELL
- ⊕ DRY HOLE
- DRY SHOWING OIL
- ☀ DRY SHOWING GAS
- ⊕ ABANDONED LOCATION
- ☀ ABANDONED GAS WELL
- ABANDONED OIL WELL

NOTE: Below make tracing from map. (when no map is obtainable make sketch) showing farm, center of section, this location with measurements and also wells, dry holes, or other locations in the vicinity of this location.

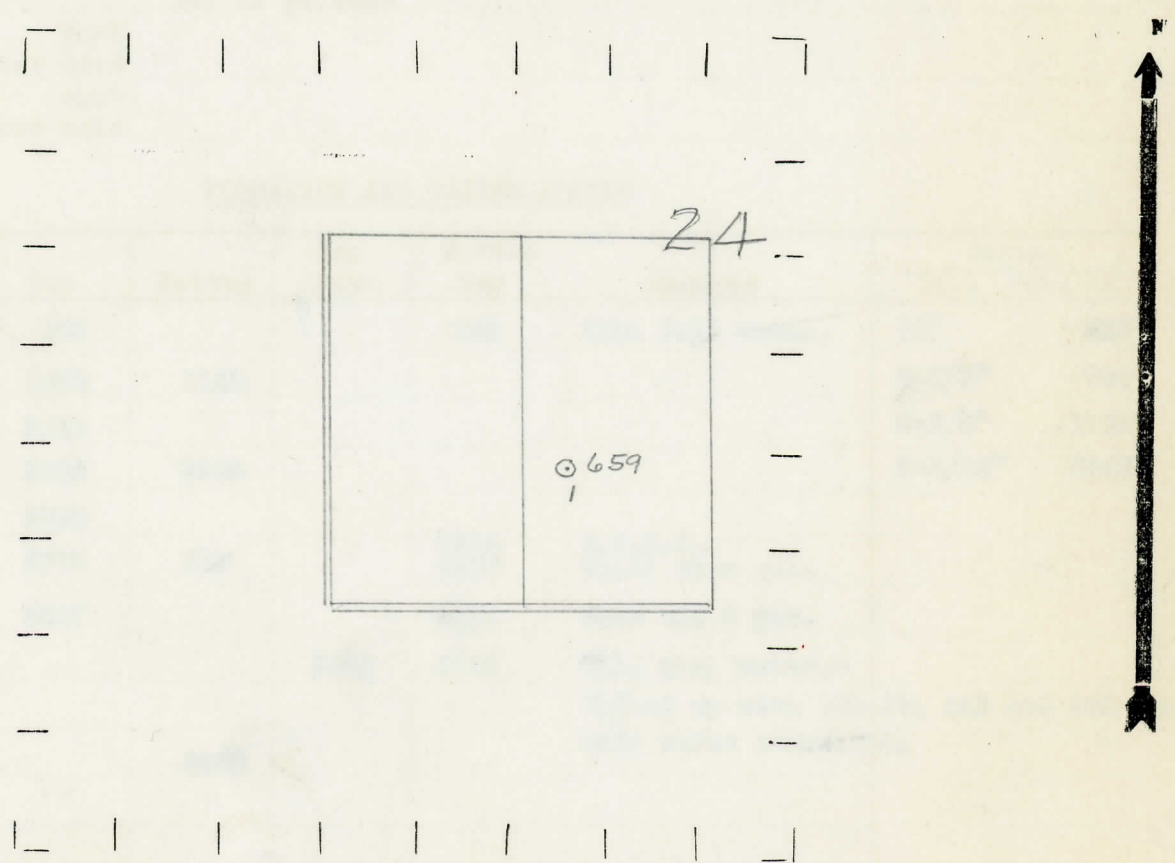

REMARKS:

SIGNED

Subintendent or Foreman.

Michigan Producing Division

Date **May 29, 1940** No. **659**
 State **Mich.** County **Gladwin** Dist. **Buckeye** Sec. **24** Twp. **18 N** Rge. **1 W**
 Well No. **1** (Serial No.) (County No.) **659** Farm **Newton Stahl** Acres
 Operator **C. W. Teater** Information secured ~~from~~ **Scouting Department**
 Date well started **4-8-40** Dated well completed **5-22-40** Elevation **740.1**

PRODUCTION RECORD

1st 24 hours natural **Dry Hole**
 2nd 24 hours natural
 Date of shot No. of quarts From to From to
 Date of acid No. of gallons
 shot
 1st 24 hours after acid
 shot
 2nd 24 hours after acid

FORMATION AND CASING RECORD

Formation	Top	Bottom	Top Pay	Bottom Pay	Remarks	Casing	
						Size	Set at
Marshall	965			965	Hole full water.	10"	215
Red Rock	1085	1145				8-1/4"	790
Sunbury	2175					6-5/8"	1193
Berea	2205	2240				5-3/16"	3529
Antrim	2290						
Traverse Lime	2775	SLM		2910 2907	H.P.S.W. Small show oil.		
Dundee	3517			3598	Show oil & gas.		
			3602	3605	Oil, gas, water.- Filled up with 150 ft. oil and 150 ft. salt water overnight.		
Total Depth		3605					

Remarks **2788' C.T.M. equals 2788' S.L.M.**

Signed **D. C. Shackelford**