



Western Michigan University  
ScholarWorks at WMU

---

Legacy Scout Tickets from Pure Oil Company

---

8-20-2021

**MGRRE\_PureOilScoutTickets\_STATE\_1\_21051089310000**

MGRRE

*Western Michigan University*

Follow this and additional works at: <https://scholarworks.wmich.edu/pure>



Part of the Geology Commons

---

#### **WMU ScholarWorks Citation**

MGRRE, "MGRRE\_PureOilScoutTickets\_STATE\_1\_21051089310000" (2021). *Legacy Scout Tickets from Pure Oil Company*. 2353.

<https://scholarworks.wmich.edu/pure/2353>

This Document is brought to you for free and open access via ScholarWorks at WMU. It has been accepted for inclusion in Legacy Scout Tickets from Pure Oil Company by an authorized administrator of ScholarWorks at WMU. See the National Digital Catalogue - Science Base Catalogue for more collections submitted by MGRRE.



---

**MGRRE\_PureOilScoutTickets\_STATE\_1\_21051089310000**

API 21051089310000

Permit Number 8931

Lease Name STATE

Well Number 1

County Gladwin

Township 19N

Range 2E

Section 14

2021 DEQ or Pure co\_name MCCLANAHAN W L AND BAGWELL CLINE

Pure Number 691

Latitude 44.04695

Longitude -84.20369

DATE September 4, 1941

LOCATION REPORT

No. 691

STATE Michigan COUNTY Gladwin DIST Sheridan TWP Sheridan SEC 14 TOWN 19 N RANGE 2 E  
WELL No. 1 (SERIAL No. 691) FARM State ACRES

NAME OF STREAM OR WATERS QUADRANGLE C 1/2 NW SW W-SW

OPERATOR W. L. McClanahan and Cline Bagwell Map Sheridan Township, Gladwin County

330 330 Feet from North Line of Farm

“ “ East “ “ “

“ “ South “ “ “

660 660 “ “ West “ “ “

330 330 Feet from North Line of Section 1/4 1/4

“ “ East “ “ “

“ “ South “ “ “

660 660 “ “ West “ “ “

LEGEND

- LOCATION
- ⊙ RIG
- ⊕ DRILLING
- ☀ GAS WELL
- OIL WELL
- SMALL OIL WELL
- ⊙ DRY HOLE
- DRY SHOWING OIL
- ⊙ DRY SHOWING GAS
- ⊙ ABANDONED LOCATION
- ☀ ABANDONED GAS WELL
- ABANDONED OIL WELL

NOTE: Below make tracing from map. (when no map is obtainable make sketch) showing farm, center of section, this location with measurements and also wells, dry holes, or other locations in the vicinity of this location.

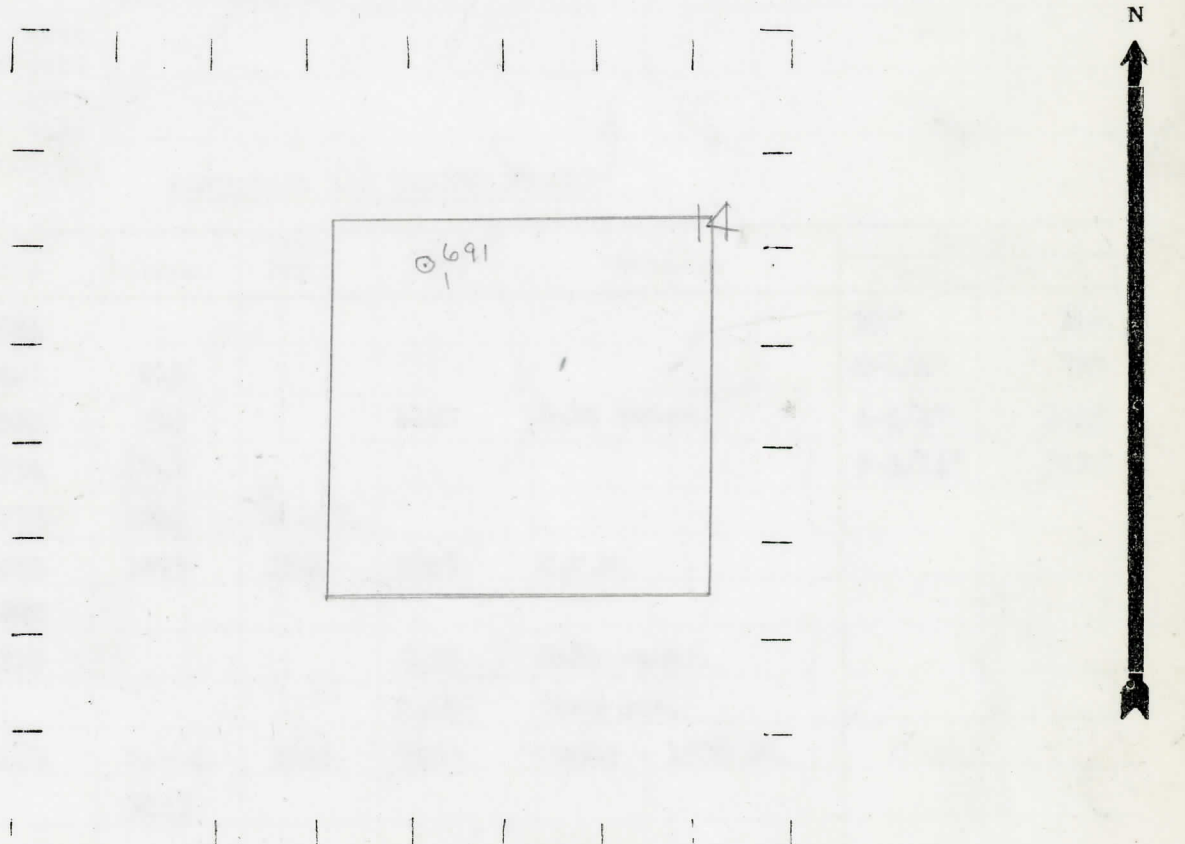

REMARKS:

SIGNED

Superintendent or Foreman.

**Michigan Producing** Division

Date **December 17, 1941** No. **691**  
 State **Mich.** County **Gladwin** Dist. **Sheridan** Sec. **14** Twp. **19 N** Rge. **2 E**  
 Well No. **1** (Serial No. **691**) Farm **State** Acres \_\_\_\_\_  
 Operator **W. L. McClanahan-Cline Bagwell** Information secured ~~from~~ **Scouting Department**  
 Date well started **9-12-41** Date well completed **12-11-41** Elevation **756.6**

PRODUCTION RECORD

1st 24 hours natural **Dry Hole**  
 2nd 24 hours natural \_\_\_\_\_  
 Date of shot \_\_\_\_\_ No. of quarts \_\_\_\_\_ From \_\_\_\_\_ to \_\_\_\_\_ From \_\_\_\_\_ to \_\_\_\_\_  
 Date of acid \_\_\_\_\_ No. of gallons \_\_\_\_\_  
 1st 24 hours after acid \_\_\_\_\_ shot  
 2nd 24 hours after acid \_\_\_\_\_ shot

FORMATION AND CASING RECORD

Formation	Top	Bottom	Top Pay	Bottom Pay	Remarks	Casing	
						Size	Set at
Marshall	564					10"	140
Red Rock	800	815				8-1/4"	763
" "	680	740		1140	Salt water.	6-5/8"	2615
Coldw. Red Rock	1734	1741				5-3/16"	3125
Sunbury	1773	1810	S.L.M.				
Berea	1810	1875	1840	1845	H.F.W.		
Antrim	1920						
Traverse Lime	2323			2455	Salt water.		
				2460	Show gas.		
Dundee	3112	S.L.M.	3225	3233	Water - 1700 ft.		
Total Depth		3233					

Remarks **2342' CTM equals 2332' S.L.M.; 3110' CTM equals 3090' SLM.**

Signed **D. C. Shackelford**