



Western Michigan University
ScholarWorks at WMU

Legacy Scout Tickets from Pure Oil Company

8-20-2021

**MGRRE_PureOilScoutTickets_STATE OF
MICHIGAN_1_21051093740000**

MGRRE

Western Michigan University

Follow this and additional works at: <https://scholarworks.wmich.edu/pure>



Part of the Geology Commons

WMU ScholarWorks Citation

MGRRE, "MGRRE_PureOilScoutTickets_STATE OF MICHIGAN_1_21051093740000" (2021). *Legacy Scout Tickets from Pure Oil Company*. 2361.

<https://scholarworks.wmich.edu/pure/2361>

This Document is brought to you for free and open access via ScholarWorks at WMU. It has been accepted for inclusion in Legacy Scout Tickets from Pure Oil Company by an authorized administrator of ScholarWorks at WMU. See the National Digital Catalogue - Science Base Catalogue for more collections submitted by MGRRE.



MGRRE_PureOilScoutTickets_STATE OF MICHIGAN_1_21051093740000

API 21051093740000

Permit Number 9374

Lease Name STATE OF MICHIGAN

Well Number 1

County Gladwin

Township 20N

Range 2W

Section 18

2021 DEQ or Pure co_name MAJOR ERVIN

Pure Number 699

Latitude 44.12899

Longitude -84.60587

699

Form 243 5M 10-10-41 P50 Poco

COMPLETION REC'D

THE PURE OIL COMPANY

Serial No. 699

Date January 7, 1942

LOCATION REPORT

A.F.E. No.

Division Mich. Producing

District

Lease

State

Acres

Lease No.

Elevation

Well No. 1

Quadrangle C W 1/2 SW NW Sec. 18

Twp. 20 N

Rge. 2 W

XBXK Dist. Sherman

Survey County Gladwin

State Michigan

Operator Ervin Major

Map Sherman Township, Gladwin County

330	330	Feet North of South Line of Lease	East	West	"	"	"
660	660	"	South	North	"	"	"
		"	West	East	"	"	"
660	660	Feet North of South Line of Section	East	West	"	"	"
330	330	"	South	North	"	"	"
		"	West	East	"	"	"

Per 1-7-42

LEGEND

- Location
- ☀ Gas Well
- Oil Well
- ☉ or ○ Dry Hole
- or ● Dry Showing Oil
- ☉ Dry Showing Gas
- ⊗ Abandoned Location
- ☉ or ☉ Abandoned Gas Well
- or ● Abandoned Oil Well

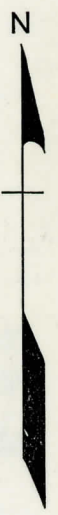
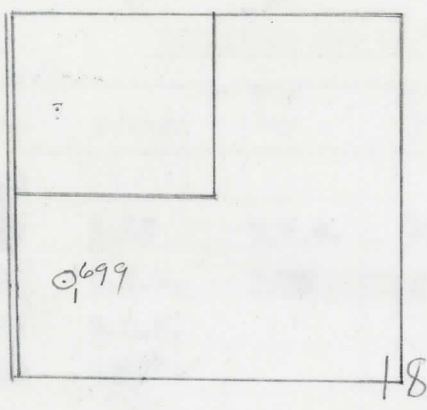

Scale _____

Remarks: _____

Submitted by W _____ Civil Engineer

Approved by _____ Division Manager

Approved by _____ Vice-President - General Manager

Date **March 18, 1942** No. **699**
 State **Mich.** County **Gladwin** Twp. **Sherman** Sec. **18** Twp. **20 N** Rge. **2 W**
 Well No. **1** (Serial No.) **699** Farm **State of Michigan** Acres _____
 Operator **Ervin Major** Information secured **from** **Scouting Department**
 Date well started **1-2-42** Date well completed **3-17-42** Elevation **1076.0**

PRODUCTION RECORD

1st 24 hours natural **Dry Hole**
 2nd 24 hours natural _____
 Date of shot _____ No. of quarts _____ From _____ to _____ From _____ to _____
 Date of acid _____ No. of gallons _____
 1st 24 hours after acid shot _____
 2nd 24 hours after acid shot _____

FORMATION AND CASING RECORD

Formation	Top	Bottom	Top Pay	Bottom Pay	Remarks	Casing	
						Size	Set at
Brown Dolomite	1298					10"	555
Stray	1438	1465	G.T.M.	1455	Salt water.	8-1/4"	1034
Marshall	1524	G.T.M.	1538	G.T.M.	Hole full water.	6-5/8"	1745
Red Rock	1622	S.L.M.					
Antrim	2700	3249					
Traverse Lime	3270						
Dundee	4009	S.L.M.	4187		Water - 3000 ft. in 20 minutes.		
Total Depth		4187					

Remarks **Hole full water from 861' to 876'.**
1647' CTM equals 1640' SOM; 1656' SLM equals 1657' CTM; 1664' CTM equals 1656' SLM; 4051' CTM equals 4051' SLM.

Signed **D. C. Shackelford**