



Western Michigan University
ScholarWorks at WMU

Legacy Scout Tickets from Pure Oil Company

8-20-2021

**MGRRE_PureOilScoutTickets_GRAHAM, FRED
J._1_21057024110000**

MGRRE
Western Michigan University

Follow this and additional works at: <https://scholarworks.wmich.edu/pure>



Part of the Geology Commons

WMU ScholarWorks Citation

MGRRE, "MGRRE_PureOilScoutTickets_GRAHAM, FRED J._1_21057024110000" (2021). *Legacy Scout Tickets from Pure Oil Company*. 2462.
<https://scholarworks.wmich.edu/pure/2462>

This Document is brought to you for free and open access via ScholarWorks at WMU. It has been accepted for inclusion in Legacy Scout Tickets from Pure Oil Company by an authorized administrator of ScholarWorks at WMU. See the National Digital Catalogue - Science Base Catalogue for more collections submitted by MGRRE.



MGRRE_PureOilScoutTickets_GRAHAM, FRED J._1_21057024110000

API 21057024110000

Permit Number 2411

Lease Name GRAHAM, FRED J.

Well Number 1

County Gratiot

Township 11N

Range 4W

Section 31

2021 DEQ or Pure co_name MAMMOTH PRODUCING AND REFINING CORP

Pure Number 59

Latitude 43.29279

Longitude -84.83887

DATE April 18, 1935

LOCATION REPORT

No. 59

STATE Michigan COUNTY Gratiot DIST. Sumner TWP. Sumner SEC. 31 TOWN 11N RANGE 4W

WELL No. 11 (SERIAL No. 59) FARM Fred J. Graham ACRES

NAME OF STREAM OR WATERS QUADRANGLE SW-SE-SW, SW-SE-SW

OPERATOR Mammoth Petroleum Corporation Map Sumner Township, Gratiot County
Mammoth Pet. Co. Sumner - Gratiot

Feet from North Line of Farm

" " East " " "

200 200 " " South " " "

200 200 " " West " " "

Feet from North Line of Section

" " East " " "

200 200 " " South " " "

1784 1784 " " West " " "

LEGEND

- LOCATION
- ⊕ RIG
- ⊕ DRILLING
- ☀ GAS WELL
- OIL WELL
- ⊕ SMALL OIL WELL
- ⊖ DRY HOLE
- ⊖ DRY SHOWING OIL
- ⊖ DRY SHOWING GAS
- ⊖ ABANDONED LOCATION
- ⊖ ABANDONED GAS WELL
- ⊖ ABANDONED OIL WELL

NOTE: Below make tracing from map, (when no map is obtainable make sketch) showing farm, center of section, this location with measurements and also wells, dry holes, or other locations in the vicinity of this location.

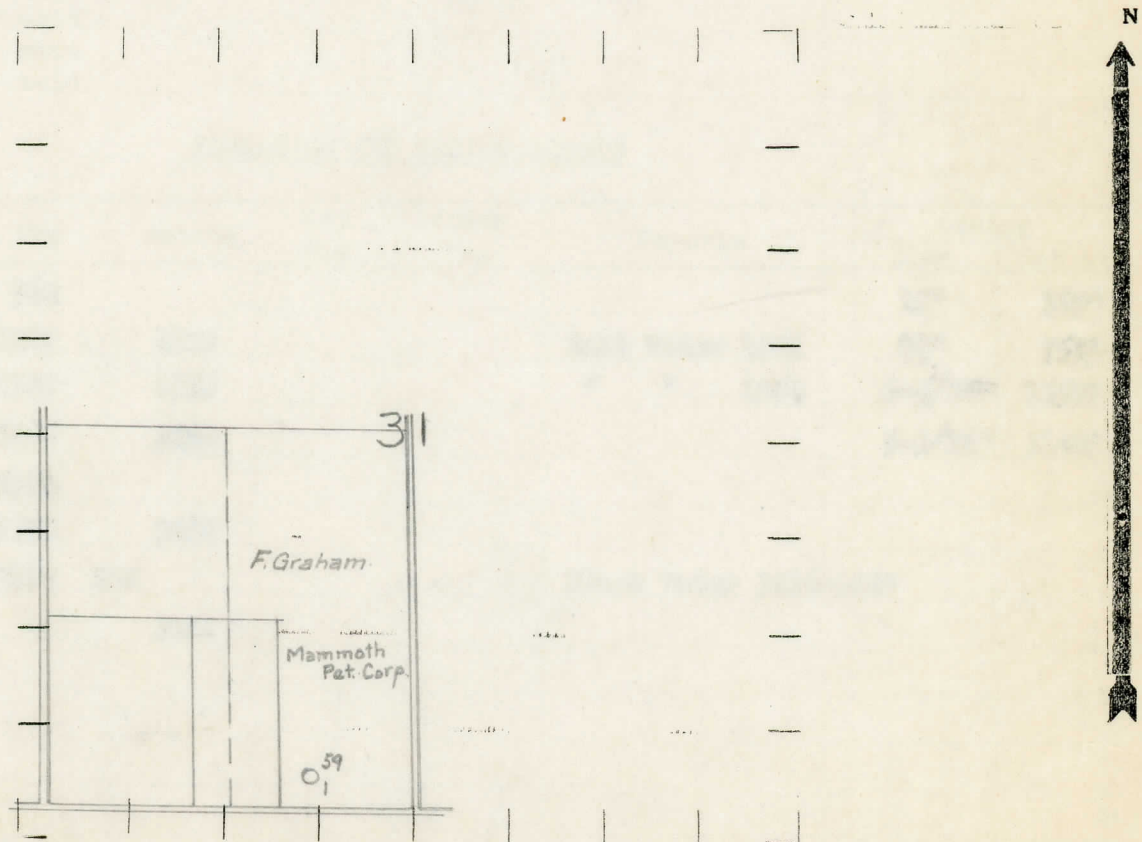

REMARKS:

SIGNED

R. L. [Signature]
Superintendent or Foreman.

COMPLETION RECORD OF WELLS DRILLED BY OTHER OPERATORS

Michigan Producing Division

Date 6/27/35 No. 59
 State Michigan County Gratiot Dist. _____
 (Serial No.) Twp. Summer Sec. 31 Twp. 11-N Rge. 4-W
 Well No. 1 (County No.) 59 Farm Fred J. Graham Acres _____
 Operator Mammoth Petroleum Co. Information secured ~~from~~ by Scouting Dept.
 Date well started 4/25/35 Date well completed 6/1/35 Elevation 776.9

PRODUCTION RECORD

1st 24 hours natural Dry Hole
 2nd 24 hours natural _____
 Date of shot _____ No. of quarts _____ From _____ to _____ From _____ to _____
 Date of acid _____ No. of gallons _____
 1st 24 hours after acid shot _____
 2nd 24 hours after acid shot _____

FORMATION AND CASING RECORD

Formation	Top	Bottom	Top Pay	Bottom Pay	Remarks	Casing	
						Size	Set at
Stray	962					10"	389'
Marshall	1003	1129			Salt Water 1005	8 1/2"	751'
Red Rock	1129	1235			" " 1050	6-5/8"	1250'
Berea	2265	2280				5-3/16"	3140'
Antrim	2280						
Traverse	2730	3080					
Dundee	3192	SLM			Black Water 3216-3220		
Total Depth		3222					

Remarks Gas 962-969, gauged 375,000 cu.ft.
Show oil and water 2830. Show oil 2920 ?

Signed B. H. Bell