



Western Michigan University
ScholarWorks at WMU

Legacy Scout Tickets from Pure Oil Company

8-20-2021

MGRRE_PureOilScoutTickets_Whitman, John A., Jr._1_na

MGRRE

Western Michigan University

Follow this and additional works at: <https://scholarworks.wmich.edu/pure>



Part of the Geology Commons

WMU ScholarWorks Citation

MGRRE, "MGRRE_PureOilScoutTickets_Whitman, John A., Jr._1_na" (2021). *Legacy Scout Tickets from Pure Oil Company*. 2468.

<https://scholarworks.wmich.edu/pure/2468>

This Document is brought to you for free and open access via ScholarWorks at WMU. It has been accepted for inclusion in Legacy Scout Tickets from Pure Oil Company by an authorized administrator of ScholarWorks at WMU. See the National Digital Catalogue - Science Base Catalogue for more collections submitted by MGRRE.



MGRRE_PureOilScoutTickets_Whitman, John A., Jr._1_na

API na

Permit Number na

Lease Name Whitman, John A., Jr.

Well Number 1

County Gratiot

Township 10N

Range 4W

Section 9

2021 DEQ or Pure co_name Gallagher

Pure Number 65

Latitude 43.2707029

Longitude -84.7872401

COMPLETION RECORD OF OIL WELLS BY OTHER OPERATORS

The Pure Oil Company

THE PURE OIL COMPANY

DATE 4-26-35

LOCATION REPORT

No. 65

STATE Michigan COUNTY Gratiot

DIST. New Haven TWP. New Haven SEC. 9

TOWN 10-N RANGE 4-W

WELL No. 1 (SERIAL No. 65) FARM

PREC. John A. Whitman, Jr. John A. Whitman, Jr.

ACRES

NAME OF STREAM OR WATERS

QUADRANGLE SW-NW-SE SW-NW-SW

OPERATOR C. R. Gallagher

Map New Haven Twp., Gratiot Co. New Haven - Gratiot

Feet from North Line of Farm

330 330 " " East " " "

330 330 " " South " " "

330 330 " " West " " "

990 990 Feet from North Line of Section

" " East " " "

" " South " " "

330 330 " " West " " "

LEGEND

- LOCATION
- ⊕ RIG
- ⊕ DRILLING
- ☀ GAS WELL
- OIL WELL
- ⊕ SMALL OIL WELL
- ⊕ DRY HOLE
- ⊕ DRY SHOWING OIL
- ⊕ DRY SHOWING GAS
- ⊕ ABANDONED LOCATION
- ☀ ABANDONED GAS WELL
- ⊕ ABANDONED OIL WELL

NOTE: Below make tracing from map, (when no map is obtainable make sketch) showing farm, center of section, this location with measurements and also wells, dry holes, or other locations in the vicinity of this location.

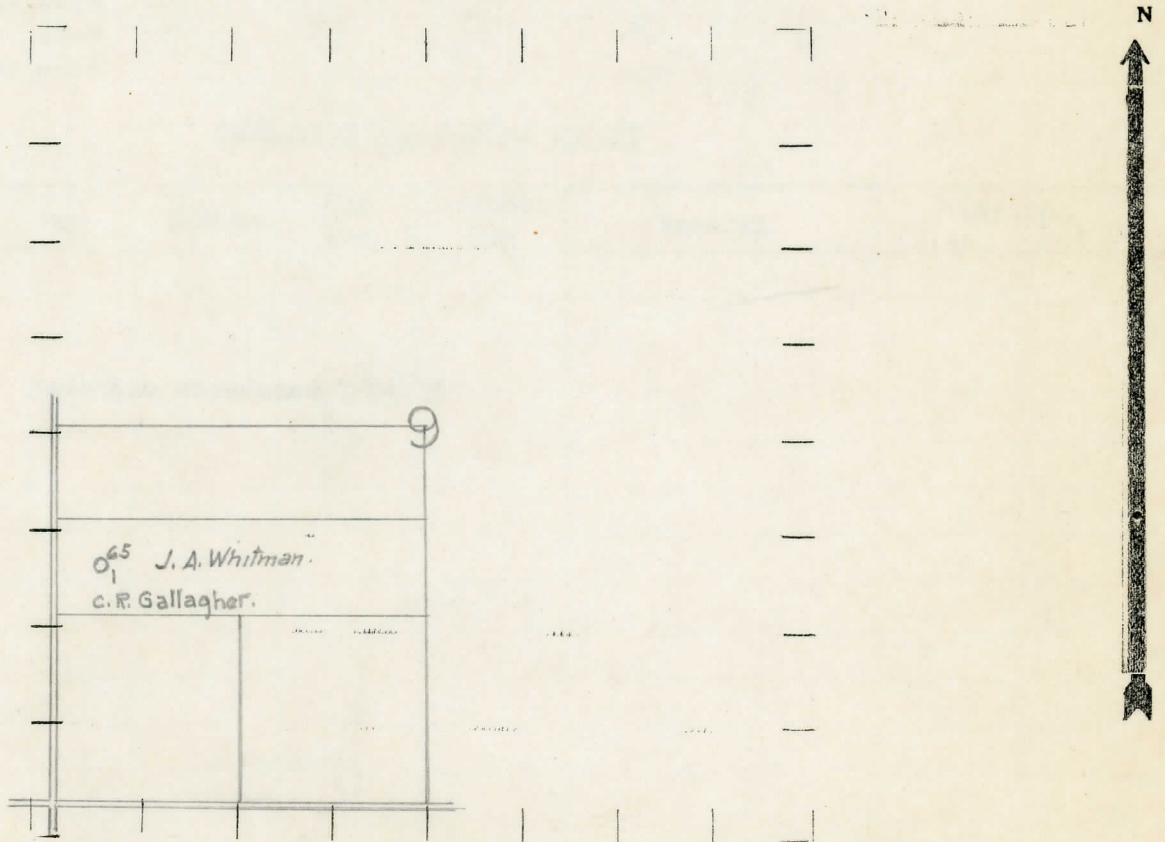

REMARKS:

SIGNED

R. d. Young

Superintendent or Foreman.

