



Western Michigan University
ScholarWorks at WMU

Legacy Scout Tickets from Pure Oil Company

8-20-2021

**MGRRE_PureOilScoutTickets_SMITH, JOHN
B._1_21057029060000**

MGRRE
Western Michigan University

Follow this and additional works at: <https://scholarworks.wmich.edu/pure>



Part of the Geology Commons

WMU ScholarWorks Citation

MGRRE, "MGRRE_PureOilScoutTickets_SMITH, JOHN B._1_21057029060000" (2021). *Legacy Scout Tickets from Pure Oil Company*. 2491.
<https://scholarworks.wmich.edu/pure/2491>

This Document is brought to you for free and open access via ScholarWorks at WMU. It has been accepted for inclusion in Legacy Scout Tickets from Pure Oil Company by an authorized administrator of ScholarWorks at WMU. See the National Digital Catalogue - Science Base Catalogue for more collections submitted by MGRRE.



MGRRE_PureOilScoutTickets_SMITH, JOHN B._1_21057029060000

API 21057029060000

Permit Number 2906

Lease Name SMITH, JOHN B.

Well Number 1

County Gratiot

Township 9N

Range 2W

Section 28

2021 DEQ or Pure co_name WILLIAMS HARLEY

Pure Number 88

Latitude 43.14046

Longitude -84.54959

THE PURE OIL COMPANY

DATE November 21, 1935

LOCATION REPORT

No. 88

STATE Mich.

COUNTY

Gratiot

DIST. Washington

28

9-N

2-W

TWP.

SEC. 28

TOWN 9-N

RANGE 2-W

WELL No. 1 (SERIAL No. 88) FARM

PREC. John B. Smith

ACRES

NAME OF STREAM OR WATERS

QUADRANGLE

SE-SW-NE

OPERATOR Harley Williams, Trustee

Map

Washington Twp - Gratiot County

Harley Williams, Trustee

Washington Twp - Gratiot Co.

Feet from North Line of Farm

1650 " " East " " "

3330 " " South " " "

" " West " " "

Feet from North Line of Section

" " East " " "

3330 " " South " 1/4 "

99990 " " West " 1/4 "

LEGEND

○ LOCATION

⊙ RIG

⊕ DRILLING

☀ GAS WELL

● OIL WELL

⦿ SMALL OIL WELL

⊖ DRY HOLE

⦿ DRY SHOWING OIL

⊖ DRY SHOWING GAS

⊖ ABANDONED LOCATION

☀ ABANDONED GAS WELL

⦿ ABANDONED OIL WELL

NOTE: Below make tracing from map, (when no map is obtainable make sketch) showing farm, center of section, this location with measurements and also wells, dry holes, or other locations in the vicinity of this location.

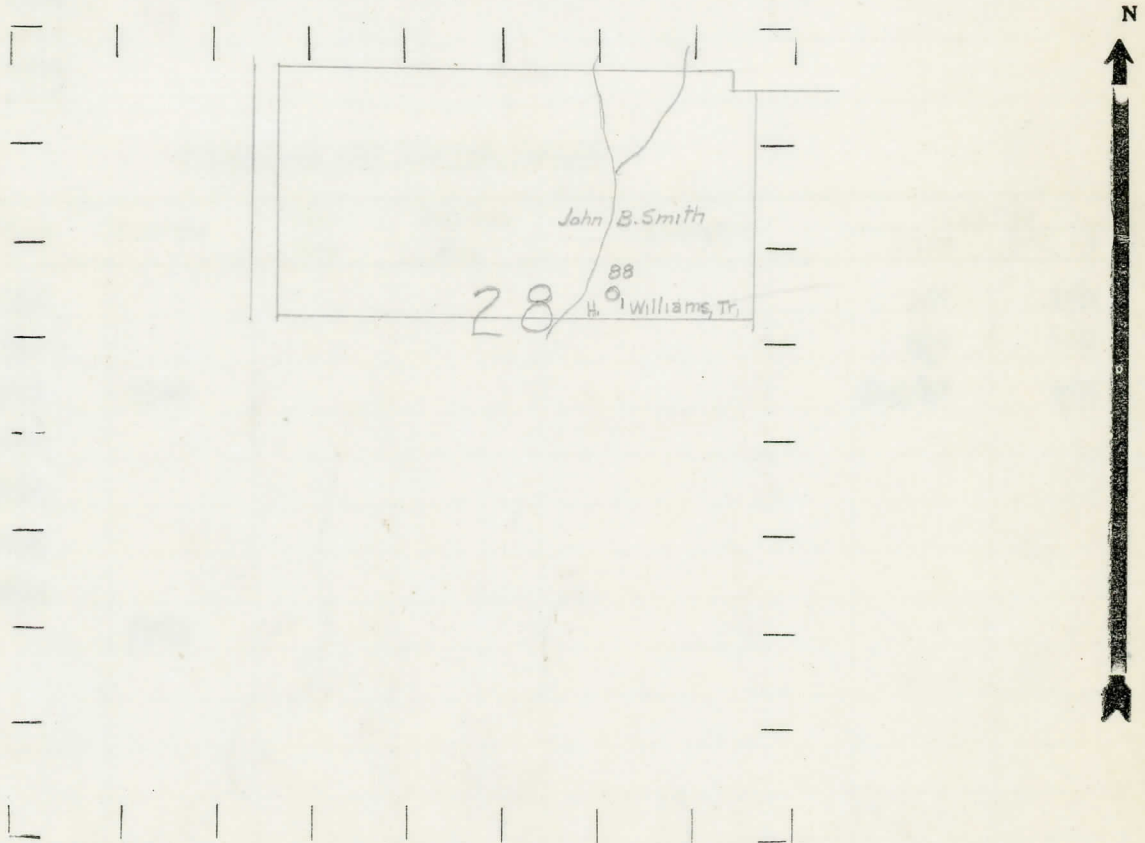

REMARKS:

SIGNED

R. D. Yeager

Superintendent or Foreman.

COMPLETION RECORD OF WELLS DRILLED BY OTHER OPERATORS

Michigan Producing Division

Date: July 16, 1936 No. 88
 State Michigan County Gratiot Dist. _____
 (Serial No.) Twp. Washington Sec. 28 Twp. 9 N Rge. 2 W
 Well No. 1 (County No.) 88 Farm John E. Smith Acres _____
 Operator Harley Williams Information secured from Scouting Department by _____
 Date well started 1-24-36 Date well completed 7-11-36 Elevation 652.3

PRODUCTION RECORD

1st 24 hours natural Dry Hole
 2nd 24 hours natural _____
 Date of shot _____ No. of quarts _____ From _____ to _____ From _____ to _____
 Date of acid _____ No. of gallons _____
 1st 24 hours after acid shot _____
 2nd 24 hours after acid shot _____

FORMATION AND CASING RECORD

Formation	Top	Bottom	Top Pay	Bottom Pay	Remarks	Casing	
						Size	Set At
Marshall	730					10"	150
Red Rock	850					8 1/4"	640
Sunbury	1970	2040				6-5/8"	955
Berea	2040						
Antrim	2120						
Traverse	2435						
Dundee	2901						
Total Depth		2922					

Remarks Salt water 2911-2915 - 3 bailers per hour - hole full salt water 2922.

Signed

J.A. Bell