



Western Michigan University
ScholarWorks at WMU

Legacy Scout Tickets from Pure Oil Company

8-20-2021

MGRRE_PureOilScoutTickets_SHAVER, B._3-B_21057032840000

MGRRE

Western Michigan University

Follow this and additional works at: <https://scholarworks.wmich.edu/pure>



Part of the Geology Commons

WMU ScholarWorks Citation

MGRRE, "MGRRE_PureOilScoutTickets_SHAVER, B._3-B_21057032840000" (2021). *Legacy Scout Tickets from Pure Oil Company*. 2502.

<https://scholarworks.wmich.edu/pure/2502>

This Document is brought to you for free and open access via ScholarWorks at WMU. It has been accepted for inclusion in Legacy Scout Tickets from Pure Oil Company by an authorized administrator of ScholarWorks at WMU. See the National Digital Catalogue - Science Base Catalogue for more collections submitted by MGRRE.



MGRRE_PureOilScoutTickets_SHAVER, B._3-B_21057032840000

API 21057032840000

Permit Number 3284

Lease Name SHAVER, B.

Well Number 3-B

County Gratiot

Township 10N

Range 4W

Section 4

2021 DEQ or Pure co_name NEW HAVEN ENERGY LLC

Pure Number 99

Latitude 43.2796342

Longitude -84.7797758

DATE May 21, 1936

LOCATION REPORT

No. 99 *

STATE Michigan COUNTY Gratiot

DIST. New Haven TWP. New Haven

SEC. 94

TOWN 10 N

RANGE 9 W

WELL No. 3 (SERIAL No. 99) FARM

PREC. Benj. Shaver "B"

ACRES

NAME OF STREAM OR WATERS

QUADRANGLE

C-SE-SE
C SE SE

OPERATOR Crystal Oil & Gas Company, Inc.

Map New Haven Township, Gratiot County

Crystal Oil & Gas Co., Inc.

New Haven - Gratiot

Feet from North Line of Farm

" " East " " "

" " South " " "

" " West " " "

Feet from North Line of Section

660 660 " " East " " "

660 660 " " South " " "

" " West " " "

LEGEND

○ LOCATION

⊕ RIG

⊕ DRILLING

☀ GAS WELL

● OIL WELL

● SMALL OIL WELL

⊖ DRY HOLE

● DRY SHOWING OIL

☀ DRY SHOWING GAS

⊖ ABANDONED LOCATION

☀ ABANDONED GAS WELL

● ABANDONED OIL WELL

NOTE: Below make tracing from map, (when no map is obtainable make sketch) showing farm, center of section, this location with measurements and also wells, dry holes, or other locations in the vicinity of this location.

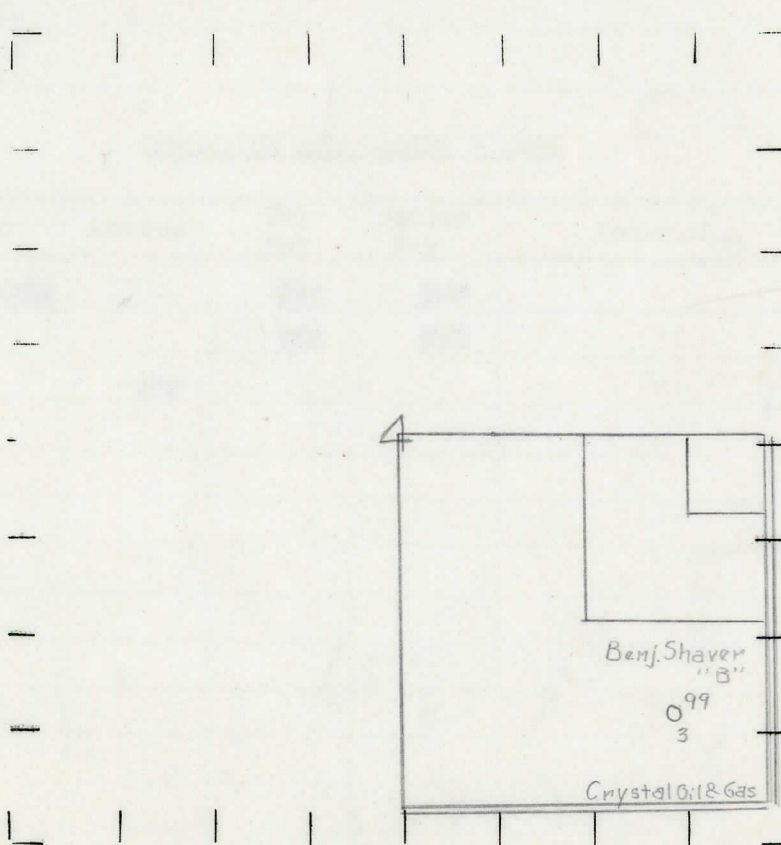

REMARKS:

SIGNED

R. L. Yeager

Superintendent or Foreman.

