



Western Michigan University
ScholarWorks at WMU

Legacy Scout Tickets from Pure Oil Company

8-20-2021

MGRRE_PureOilScoutTickets_WOOD-NICKERT-SHERBURNE-DUFFIELD-LEASE_1_21057059110000

MGRRE

Western Michigan University

Follow this and additional works at: <https://scholarworks.wmich.edu/pure>



Part of the Geology Commons

WMU ScholarWorks Citation

MGRRE, "MGRRE_PureOilScoutTickets_WOOD-NICKERT-SHERBURNE-DUFFIELD-LEASE_1_21057059110000" (2021). *Legacy Scout Tickets from Pure Oil Company*. 2577. <https://scholarworks.wmich.edu/pure/2577>

This Document is brought to you for free and open access via ScholarWorks at WMU. It has been accepted for inclusion in Legacy Scout Tickets from Pure Oil Company by an authorized administrator of ScholarWorks at WMU. See the National Digital Catalogue - Science Base Catalogue for more collections submitted by MGRRE.



MGRRE_PureOilScoutTickets_WOOD-NICKERT-SHERBURNE-DUFFIELD-LEASE_1_21057059110000

API 21057059110000

Permit Number 5911

Lease Name WOOD-NICKERT-SHERBURNE-DUFFIELD-LEASE

Well Number 1

County Gratiot

Township 11N

Range 4W

Section 33

2021 DEQ or Pure co_name BURCH R M TRUSTEE

Pure Number 176

Latitude 43.29951

Longitude -84.79103

THE PURE OIL COMPANY

DATE March 9, 1939

COMPLETION RECORD OF WELLS DRILLED BY OTHER OPERATORS

LOCATION REPORT

No. 176

STATE Michigan COUNTY Gratiot DIST. Sumner TWP. Sumner SEC. 33 TOWN 11 N RANGE 4 W

WELL No. 1 (SERIAL No. 176) FARM Wood-Nickert, et al ACRES

NAME OF STREAM OR WATERS QUADRANGLE CE 2 2

OPERATOR R. M. Burch, Trustee Map Sumner Township, Gratiot County

R. M. Burch, Tr.

Feet from North Line of Farm

" " East " " "

" " South " " "

" " West " " "

Feet from North Line of Section

1320 1320 " " East " " "

2640 2640 " " South " " "

" " West " " "

192 sp 3-4-39

LEGEND

- LOCATION
- ⊕ RIG
- ⊕ DRILLING
- ☀ GAS WELL
- OIL WELL
- ⊕ SMALL OIL WELL
- ⊖ DRY HOLE
- ⊕ DRY SHOWING OIL
- ☀ DRY SHOWING GAS
- ⊖ ABANDONED LOCATION
- ☀ ABANDONED GAS WELL
- ⊖ ABANDONED OIL WELL

NOTE: Below make tracing from map, (when no map is obtainable make sketch) showing farm, center of section, this location with measurements and also wells, dry holes, or other locations in the vicinity of this location.

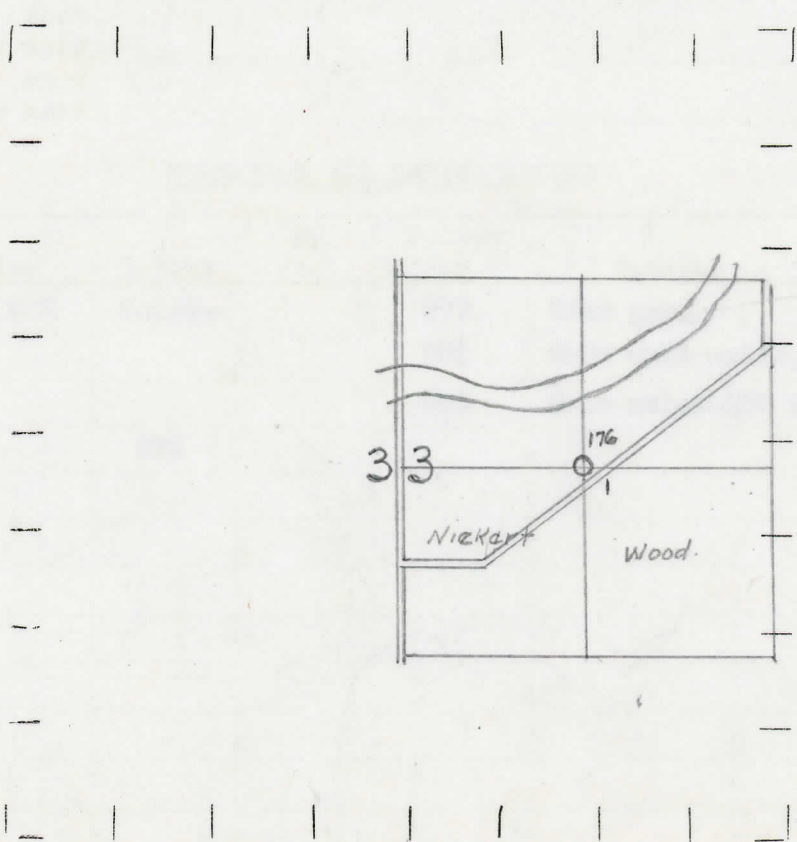

REMARKS:

SIGNED

Superintendent or Foreman.

