



Western Michigan University
ScholarWorks at WMU

Legacy Scout Tickets from Pure Oil Company

8-20-2021

MGRRE_PureOilScoutTickets_GEE_1_21057065400000

MGRRE

Western Michigan University

Follow this and additional works at: <https://scholarworks.wmich.edu/pure>



Part of the Geology Commons

WMU ScholarWorks Citation

MGRRE, "MGRRE_PureOilScoutTickets_GEE_1_21057065400000" (2021). *Legacy Scout Tickets from Pure Oil Company*. 2580.

<https://scholarworks.wmich.edu/pure/2580>

This Document is brought to you for free and open access via ScholarWorks at WMU. It has been accepted for inclusion in Legacy Scout Tickets from Pure Oil Company by an authorized administrator of ScholarWorks at WMU. See the National Digital Catalogue - Science Base Catalogue for more collections submitted by MGRRE.



MGRRE_PureOilScoutTickets_GEE_1_21057065400000

API 21057065400000

Permit Number 6540

Lease Name GEE

Well Number 1

County Gratiot

Township 10N

Range 4W

Section 5

2021 DEQ or Pure co_name D T E GAS COMPANY

Pure Number 179

Latitude 43.29134

Longitude -84.80312

THE PURE OIL COMPANY
COMPLETION RECORD OF THIS WELL BY OTHER OPERATORS

DATE August 3, 1939

LOCATION REPORT

No. 179

STATE Michigan COUNTY Gratiot DIST. New Haven TWP. New Haven SEC. 5 TOWN 10 N RANGE 4 W

WELL No. 1 (SERIAL No. 179) FARM ACRES

NAME OF STREAM OR WATERS QUADRANGLE NE NW NE

OPERATOR Lang & Lewis Map New Haven Township, Gratiot County

330 330 Feet from North Line of Farm

330 330 " " East " " "

" " South " " "

" " West " " "

330 330 Feet from North Line of Section

" " East " " "

" " South " " "

990 990 " " West " 3/4 "

New Haven Township, Gratiot County

New Haven - Gratiot

3 - m

LEGEND

- LOCATION
- ⊕ RIG
- ⊕ DRILLING
- ☀ GAS WELL
- OIL WELL
- ⊕ SMALL OIL WELL
- ⊕ DRY HOLE
- ⊕ DRY SHOWING OIL
- ⊕ DRY SHOWING GAS
- ⊕ ABANDONED LOCATION
- ☀ ABANDONED GAS WELL
- ⊕ ABANDONED OIL WELL

NOTE: Below make tracing from map, (when no map is obtainable make sketch) showing farm, center of section, this location with measurements and also wells, dry holes, or other locations in the vicinity of this location.

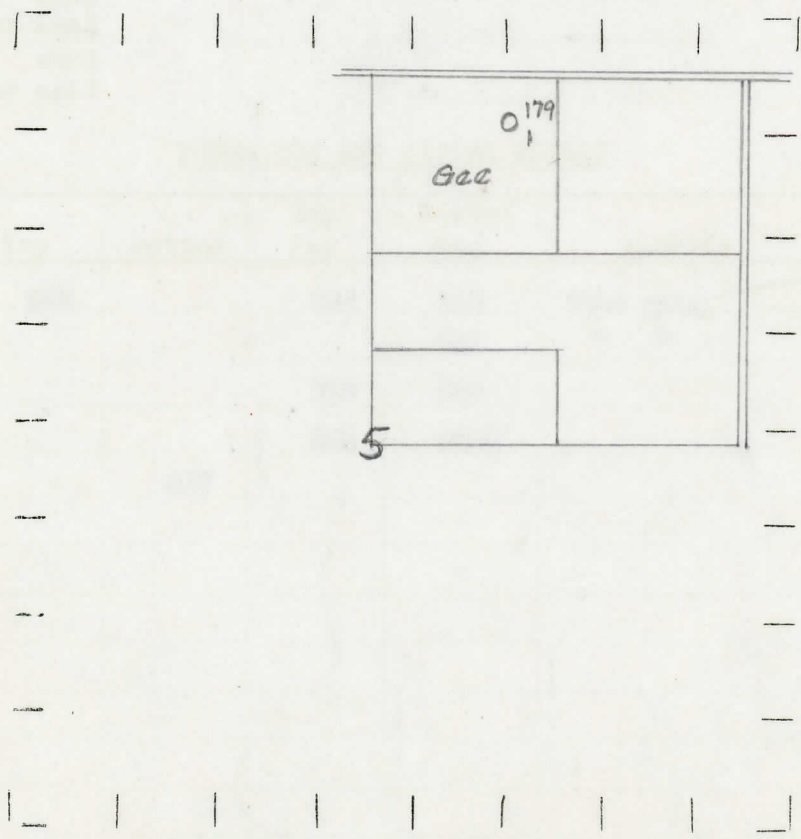

REMARKS:

SIGNED

Superintendent or Foreman.

Michigan Producing Division

Date August 31, 1939 No. 179
 State Mich. County Gratiot Dist. New Haven Twp. 10 N Rge. 4 W
 Well No. 1 (County No.) 179 Farm Gee Acres _____
 Operator Lang and Lewis Information secured from Scouting Department
 Date well started 8-5-39 Dated well completed 8-24-39 Elevation 766.6

PRODUCTION RECORD

1st 24 hours natural 1,550,000 cubic feet
 2nd 24 hours natural _____
 Date of shot _____ No. of quarts _____ From _____ to _____ From _____ to _____
 Date of acid _____ No. of gallons _____
 shot _____
 1st 24 hours after acid _____
 shot _____
 2nd 24 hours after acid _____

FORMATION AND CASING RECORD

Formation	Top	Bottom	Top Pay	Bottom Pay	Remarks	Casing	
						Size	Set at
Stray	942		942	943	Show gas.	6-5/8"	381
				967	" "	6-5/8"	570
				975	982		5-3/16"
			984	986 1/2			
Total Depth		987					

Remarks Hole full water at 570'.

Signed D. C. Shackelford