



Western Michigan University  
ScholarWorks at WMU

---

Legacy Scout Tickets from Pure Oil Company

---

8-20-2021

**MGRRE\_PureOilScoutTickets\_Bartley, Wm. E.\_1\_na**

MGRRE

*Western Michigan University*

Follow this and additional works at: <https://scholarworks.wmich.edu/pure>



Part of the Geology Commons

---

#### **WMU ScholarWorks Citation**

MGRRE, "MGRRE\_PureOilScoutTickets\_Bartley, Wm. E.\_1\_na" (2021). *Legacy Scout Tickets from Pure Oil Company*. 2605.

<https://scholarworks.wmich.edu/pure/2605>

This Document is brought to you for free and open access via ScholarWorks at WMU. It has been accepted for inclusion in Legacy Scout Tickets from Pure Oil Company by an authorized administrator of ScholarWorks at WMU. See the National Digital Catalogue - Science Base Catalogue for more collections submitted by MGRRE.



---

MGRRE\_PureOilScoutTickets\_Bartley, Wm. E.\_1\_na

API na

Permit Number na

Lease Name Bartley, Wm. E.

Well Number 1

County Gratiot

Township 12N

Range 3W

Section 30

2021 DEQ or Pure co\_name Rex Oil & Gas co

Pure Number 210

Latitude 43.4009614

Longitude -84.7166204

Date September 9, 1942 LOCATION REPORT A.F.E. No. \_\_\_\_\_

Division Michigan Producing District \_\_\_\_\_ Lease William E. Bartley

Acres \_\_\_\_\_ Lease No. \_\_\_\_\_ Elevation \_\_\_\_\_ Well No. 1 (Serial No. 2100)

Quadrangle C NE SE Sec. 30 Twp. 12 N Rge. 3 W Twp. Pine River

Survey \_\_\_\_\_ County Gratiot State Michigan

Operator Rex Oil & Gas Company Map Pine River Township, Gratiot County

660	660	Feet from North Line of Lease	"	"	East	"	"	"
660	660	"	"	South	"	"	"	"
660	660	"	"	West	"	"	"	"
660	660	Feet from North Line of Section	"	"	East	"	"	"
660	660	"	"	South	"	"	"	"
		"	"	West	"	"	"	"

*300*

LEGEND

- ☀ Gas Well
- Oil Well
- ☀ Gas - Distillate Well
- ⊘ or ⊙ Dry Hole
- Dry Showing Oil
- Location
- ☉ Dry Showing Gas
- ⊘ Abandoned Location
- ☀ or ☀ Abandoned Gas Well
- or ● Abandoned Oil Well
- ⊘ or ⊙ Input Well

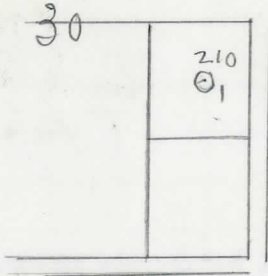

Remarks: \_\_\_\_\_ Scale \_\_\_\_\_

Submitted by h Civil Engineer Approved by \_\_\_\_\_ Division Manager

Approved by \_\_\_\_\_ Vice-President - General Manager

THE OIL COMPANY

COMPLETION RECORD OF WELLS DRILLED BY OTHER OPERATORS

Michigan Producing Division

Date November 26, 1942 No. 210

State Michigan County Gratiot Dist. Pine River Twp. Pine River Sec. 30 Twp. 12 N Rge. 3 W

Well No. 1 (Serial No.) (County No.) 210 Farm Wm. E. Bartley Acres

Operator Rex Oil and Gas Company Information secured from By Scouting Department

Date well started Not started. Date well completed Not completed. Elevation

PRODUCTION RECORD

1st 24 hours natural Location abandoned.

2nd 24 hours natural

Date of shot No. of quarts From to From to

Date of acid No. of gallons

1st 24 hours after acid shot

2nd 24 hours after acid shot

FORMATION AND CASING RECORD

Table with 7 columns: Formation, Top, Bottom, Top Pay, Bottom Pay, Remarks, Casing (Size, Set at). Contains text 'Location abandoned 11-23-42.' in the Remarks column.

Remarks

Signed D. C. Shackelford