



Legacy Scout Tickets from Pure Oil Company

---

8-20-2021

## MGRRE\_PureOilScoutTickets\_CHURCH AND RING\_1\_21057106160000

MGRRE

*Western Michigan University*

Follow this and additional works at: <https://scholarworks.wmich.edu/pure>



Part of the Geology Commons

---

### WMU ScholarWorks Citation

MGRRE, "MGRRE\_PureOilScoutTickets\_CHURCH AND RING\_1\_21057106160000" (2021). *Legacy Scout Tickets from Pure Oil Company*. 2618.

<https://scholarworks.wmich.edu/pure/2618>

This Document is brought to you for free and open access via ScholarWorks at WMU. It has been accepted for inclusion in Legacy Scout Tickets from Pure Oil Company by an authorized administrator of ScholarWorks at WMU. See the National Digital Catalogue - Science Base Catalogue for more collections submitted by MGRRE.



---

**MGRRE\_PureOilScoutTickets\_CHURCH AND RING\_1\_21057106160000**

API 21057106160000

Permit Number 10616

Lease Name CHURCH AND RING

Well Number 1

County Gratiot

Township 12N

Range 3W

Section 9

2021 DEQ or Pure co\_name TEATER C W

Pure Number 224

Latitude 43.44692

Longitude -84.67312

THE PURE OIL COMPANY

LOCATION REPORT

Date February 2, 1944 A.F.E. No. \_\_\_\_\_  
 Division Mich. Producing District \_\_\_\_\_ Lease Church & Ring  
 Acres \_\_\_\_\_ Lease No. \_\_\_\_\_ Elevation \_\_\_\_\_ Well No. 1 (Serial No. 224)  
 Quadrangle NE-SW-NE Sec. 9 Twp. 12 N Rge. 3 W ~~Dist.~~ Pine River  
 Survey \_\_\_\_\_ County Gratiot State Michigan  
 Operator Charles W. Teater Map Pine River Twp. - Gratiot Co

1650 1650 Feet from North Line of Lease  
 " " East " " "  
 " " South " " "  
 " " West " " "  
 Feet from North Line of Section  
 " " East " " "  
990 990 " " South " 1/4  
990 990 " " West " " "

LEGEND

- Location
- ☀ Gas Well
- Oil Well
- ☀ Gas - Distillate Well
- ⊘ or ○ Dry Hole
- Dry Showing Oil
- ☀ Dry Showing Gas
- ⊘ Abandoned Location
- ☀ or ☀ Abandoned Gas Well
- or ● Abandoned Oil Well
- ⊘ or ⊘ Input Well

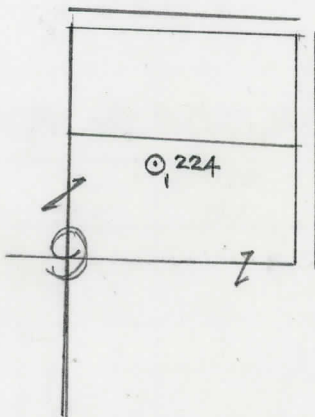

Scale \_\_\_\_\_

Remarks: \_\_\_\_\_  
 \_\_\_\_\_  
 \_\_\_\_\_

Submitted by RN Civil Engineer Approved by \_\_\_\_\_ Division Manager  
 Approved by \_\_\_\_\_ Vice-President - General Manager

Division Mt. Production District Church & Ring Lease Church & Ring  
 Date September 5, 1944 LOCATION REPORT V.E.E. No. \_\_\_\_\_

COMPLETION RECORD OF WELLS DRILLED BY OTHER OPERATORS

Michigan Producing Division

Date March 15, 1944 No. 224  
 State Mich. County Gratiot District Pine River Twp. 12 N Rge. 3 W  
 (Serial No.)  
 Well No. 1 (County No.) 224 Farm Church & Ring Acres \_\_\_\_\_  
 Operator C. W. Teater By Scouting Department  
 Information secured from Scouting Department  
 Date well started 2-17-44 Date well completed 3-1-44 Elevation 766.5

PRODUCTION BOARD

1st 24 hours natural Dry Hole  
 2nd 24 hours natural \_\_\_\_\_  
 Date of shot \_\_\_\_\_ No. of quarts \_\_\_\_\_ From \_\_\_\_\_ to \_\_\_\_\_ From \_\_\_\_\_ to \_\_\_\_\_  
 Date of acid \_\_\_\_\_ No. of gallons \_\_\_\_\_  
 1st 24 hours after acid shot \_\_\_\_\_  
 2nd 24 hours after acid shot \_\_\_\_\_

FORMATION AND CASING RECORD

Formation	Top	Bottom	Top Pay	Bottom Pay	Remarks	Casing	
						Size	Set at
Brown Dolomite	1062	SLM.				10"	436
Mich. Stray	1155				400 ft. salt water at 1155.	8-1/4"	912
Total Depth		1232					

Remarks 1099' CTM equals 1099' SLM.

Signed D. C. Shackelford