



Western Michigan University
ScholarWorks at WMU

Legacy Scout Tickets from Pure Oil Company

8-20-2021

**MGRRE_PureOilScoutTickets_ELBA GAS
UNIT_3_21057122060000**

MGRRE
Western Michigan University

Follow this and additional works at: <https://scholarworks.wmich.edu/pure>



Part of the Geology Commons

WMU ScholarWorks Citation

MGRRE, "MGRRE_PureOilScoutTickets_ELBA GAS UNIT_3_21057122060000" (2021). *Legacy Scout Tickets from Pure Oil Company*. 2653.
<https://scholarworks.wmich.edu/pure/2653>

This Document is brought to you for free and open access via ScholarWorks at WMU. It has been accepted for inclusion in Legacy Scout Tickets from Pure Oil Company by an authorized administrator of ScholarWorks at WMU. See the National Digital Catalogue - Science Base Catalogue for more collections submitted by MGRRE.



MGRRE_PureOilScoutTickets_ELBA GAS UNIT_3_21057122060000

API 21057122060000

Permit Number 12206

Lease Name ELBA GAS UNIT

Well Number 3

County Gratiot

Township 9N

Range 1W

Section 15

2021 DEQ or Pure co_name WILLIAMS ARTHUR E

Pure Number 259

Latitude 43.17228

Longitude -84.41298

THE PURE OIL COMPANY

LOCATION REPORT

Date April 10, 1946 A.F.E. No. _____

Division Mich. Producing District _____ Lease Elba Gas Unit

Acres _____ Lease No. _____ Elevation _____ Well No. 3 (Serial No. 259)

Quadrangle C NE Sec. 15 Twp. 9 N Rge. 1 W Twp. Elba

Survey _____ County Gratiot State Michigan

Operator Arthur E. Williams Map Elba Township, Gratiot County

<u>1320</u>	<u>1320</u>	Feet from North Line of Lease
<u>1320</u>	<u>1320</u>	" " East " " "
		" " South " " "
		" " West " " "
<u>1320</u>	<u>1320</u>	Feet from North Line of Section
<u>1320</u>	<u>1320</u>	" " East " " "
		" " South " " "
		" " West " " "

- LEGEND**
- Location
 - ☀ Gas Well
 - Oil Well
 - ☀ Gas - Distillate Well
 - or ○ Dry Hole
 - Dry Showing Oil
 - ☀ Dry Showing Gas
 - ⊗ Abandoned Location
 - ☀ or ☀ Abandoned Gas Well
 - or ● Abandoned Oil Well
 - or ○ Input Well

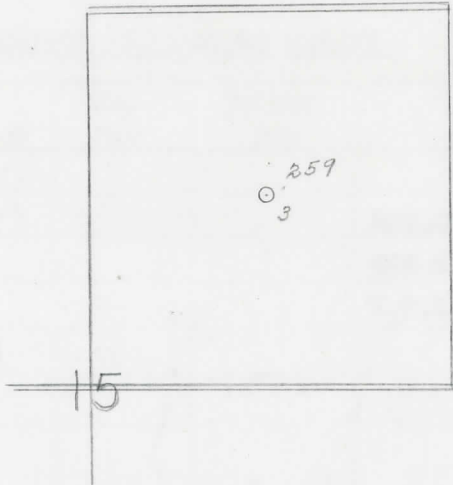

Remarks: _____

Scale _____

Submitted by CB
Civil Engineer

Approved by _____
Division Manager

Approved by _____
Vice-President - General Manager

COMPLETION RECORD OF WELLS DRILLED BY OTHER OPERATORS

Michigan Producing Division

Date May 8, 1946 No. 259
 State Mich. Co. Gratiot ~~Riskx~~ Twp. Elba Sec. 15 Twp. 9 N Rge. 1 W
 Well No. 3 Serial No. 259 Farm Elba Gas Unit Acres _____
 Operator Arthur E. Williams
 Date started 4-16-46 Date completed 4-30-46 Elevation 660.3

PRODUCTION RECORD

1st 24 hours natural _____
 Date of shot _____ No. of quarts _____ From _____ To _____ From _____ To _____
 Date of acid _____ No. of gallons _____ shot _____
 1st 24 hours after acid _____
 Completed as: Oil Well _____ Gas Well _____ Dry Hole X

FORMATION AND CASING RECORD

Formation	Top	Bottom	Top Pay	Bottom Pay	Remarks	Casing	
						Size	Set at
Brown Dolomite	635	(+25)				5-3/16"	658
Mich. Stray	677	(+17)			200,000 Cu. Ft. of gas at 690. (-30)		
					H.F.S.W. 693-695. (-33)		
Total Depth		695	(-35)				

Remarks _____

Signed D. C. Shackelford