



Western Michigan University
ScholarWorks at WMU

Legacy Scout Tickets from Pure Oil Company

8-20-2021

**MGRRE_PureOilScoutTickets_ELBA GAS
UNIT_6_21057122740000**

MGRRE
Western Michigan University

Follow this and additional works at: <https://scholarworks.wmich.edu/pure>



Part of the Geology Commons

WMU ScholarWorks Citation

MGRRE, "MGRRE_PureOilScoutTickets_ELBA GAS UNIT_6_21057122740000" (2021). *Legacy Scout Tickets from Pure Oil Company*. 2659.
<https://scholarworks.wmich.edu/pure/2659>

This Document is brought to you for free and open access via ScholarWorks at WMU. It has been accepted for inclusion in Legacy Scout Tickets from Pure Oil Company by an authorized administrator of ScholarWorks at WMU. See the National Digital Catalogue - Science Base Catalogue for more collections submitted by MGRRE.



MGRRE_PureOilScoutTickets_ELBA GAS UNIT_6_21057122740000

API 21057122740000

Permit Number 12274

Lease Name ELBA GAS UNIT

Well Number 6

County Gratiot

Township 9N

Range 1W

Section 11

2021 DEQ or Pure co_name MATLOCK RAY W AND WILLIAMS ARTHUR E

Pure Number 265

Latitude 43.1796

Longitude -84.40311

THE PURE OIL COMPANY LOCATION REPORT

Date May 1, 1946 A.F.E. No. Elba Gas Unit
 Division Mich. Producing District _____ Lease Elba Gas Unit
 Acres _____ Lease No. _____ Elevation _____ Well No. 6 (Serial No. 265)
 Quadrangle C SW Sec. 11 Twp. 9 N Rge. 1 W ~~Elba~~ Elba
 Survey _____ County Gratiot State Michigan
 Operator Ray W. Matlock & Arthur E. Williams Map Elba Township, Gratiot County

_____	_____	Feet from North Line of Lease
_____	_____	" " East " " "
<u>1320</u>	<u>1320</u>	" " South " " "
<u>1320</u>	<u>1320</u>	" " West " " "
_____	_____	Feet from North Line of Section
<u>1320</u>	<u>1320</u>	" " East " " "
_____	_____	" " South " " "
_____	_____	" " West " " "

LEGEND

- Location
- ☀ Gas Well
- Oil Well
- ☀ Gas - Distillate Well
- or ○ Dry Hole
- Dry Showing Oil
- ☀ Dry Showing Gas
- ⊗ Abandoned Location
- ☀ or ☀ Abandoned Gas Well
- or ● Abandoned Oil Well
- or ○ Input Well

6 m.

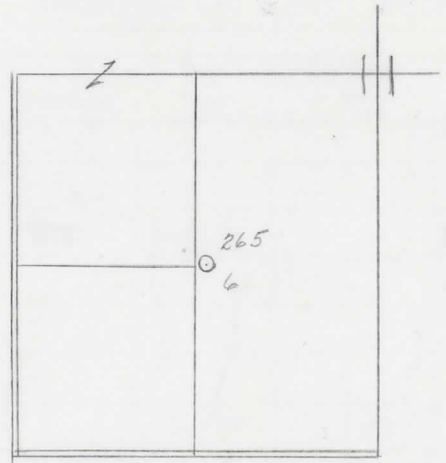

Remarks: _____ Scale _____

Submitted by CB Civil Engineer Approved by _____ Division Manager
 Approved by _____ Vice-President - General Manager

