



Western Michigan University
ScholarWorks at WMU

Legacy Scout Tickets from Pure Oil Company

8-20-2021

MGRRE_PureOilScoutTickets_PROBST, J A_1_21057124990000

MGRRE

Western Michigan University

Follow this and additional works at: <https://scholarworks.wmich.edu/pure>



Part of the Geology Commons

WMU ScholarWorks Citation

MGRRE, "MGRRE_PureOilScoutTickets_PROBST, J A_1_21057124990000" (2021). *Legacy Scout Tickets from Pure Oil Company*. 2666.

<https://scholarworks.wmich.edu/pure/2666>

This Document is brought to you for free and open access via ScholarWorks at WMU. It has been accepted for inclusion in Legacy Scout Tickets from Pure Oil Company by an authorized administrator of ScholarWorks at WMU. See the National Digital Catalogue - Science Base Catalogue for more collections submitted by MGRRE.



MGRRE_PureOilScoutTickets_PROBST, J A_1_21057124990000

API 21057124990000

Permit Number 12499

Lease Name PROBST, J A

Well Number 1

County Gratiot

Township 10N

Range 3W

Section 34

2021 DEQ or Pure co_name SOHIO PETROLEUM CO

Pure Number 272

Latitude 43.21467

Longitude -84.65412

October 23, 1946

THE PURE OIL COMPANY

Date October 23, 1946

LOCATION REPORT

A.F.E. No. _____

Division Mich. Producing District _____ Lease J. A. Probst

Acres _____ Lease No. _____ Elevation _____ Well No. 1 (Serial No. 272)

Quadrangle NW-SE-NW Sec. 34 Twp. 10N Rge. 3W Blk. Dist. Newark Newark

Survey _____ County Gratiot State Michigan

Operator Sohio Petroleum Co. Map Newark Township, Gratiot County

330 330 Feet from North Line of Lease
990 990 " " East " " "
330 330 " " South " " "

" " West " " "
Feet from North Line of Section
990 990 " " East " " "
990 990 " " South " " "
" " West " " "

LEGEND

- Location
- ☀ Gas Well
- Oil Well
- ☀ Gas - Distillate Well
- or ○ Dry Hole
- Dry Showing Oil
- ☀ Dry Showing Gas
- ⊖ Abandoned Location
- ☀ or ☀ Abandoned Gas Well
- or ● Abandoned Oil Well
- or ○ Input Well

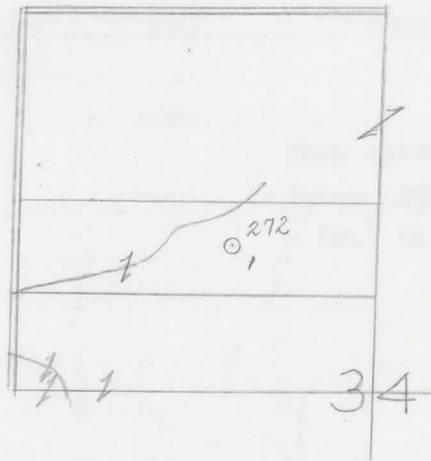

Scale _____

Remarks: _____

Submitted by CB _____
Civil Engineer

Approved by _____
Division Manager

Approved by _____
Vice-President - General Manager

COMPLETION RECORD OF WELLS DRILLED BY OTHER OPERATORS

Michigan Producing DIVISION

Date December 11, 1946 No. 272
 State Mich. Co. Gratiot Twp. Newark Sec. 34 Twp. 10 N Rge. 3 W
 Well No. 1 Serial No. 272 Farm J. A. Probst Acres _____
 Operator Sohio Petroleum Company
 Date started 11-21-46 Date completed 12-7-46 Elevation 765.4

PRODUCTION RECORD

1st 24 hours natural _____
 Date of shot _____ No. of quarts _____ From _____ To _____ From _____ To _____
 Date of acid _____ No. of gallons _____ shot _____
 1st 24 hours after acid _____
 Completed as: Oil Well _____ Gas Well _____ Dry Hole X

FORMATION AND CASING RECORD

Formation	Top	Bottom	Top Pay	Bottom Pay	Remarks	Casing	
						Size	Set at
Brown Dolomite	873	887	(-108)			10"	350
Mich. Stray	887	(-122)				8-1/4"	750
Marshall	966	(-201)			Show water 969. (204) Water (250 ft. in 1 hr.) at 975.	6-5/8"	962
Total Depth		975	(-210)		(-210)		

Remarks 744' CTM equals 743' SLM; 882' CTM equals 880' SLM.

Signed Harry J. Gaspeny